

I LOCATION OF WATER WELL: County: Pawnee	Fraction ¼ NW ¼ SE ¼ NE ¼	Section Number 32	Township Number T 21 S	Range Number 16 <input type="checkbox"/> E <input checked="" type="checkbox"/> W
--	------------------------------	----------------------	---------------------------	---

Street/Rural Address of Well Location: if unknown, distance & direction from nearest town or intersection: If at owner's address, check here
1006 Broadway, Larned KS

Global Positioning Systems (GPS) information:
 Latitude: NA (in decimal degrees)
 Longitude: NA (in decimal degrees)
 Elevation: NA
 Horizontal Datum WGS84, NAD83, NAD27
 Collection Method:
 GPS unit (Make/model: _____)
 Digital Map/Photo, Topographic Map, Land Survey
 Est. Accuracy: <3 m, 3-5 m, 5-15 m, >15 m

2 WATER WELL OWNER:
 RR#, St. Address, Box #: Mike Hickel Route 1
 City, State ZIP Code: Larned, KS 67550

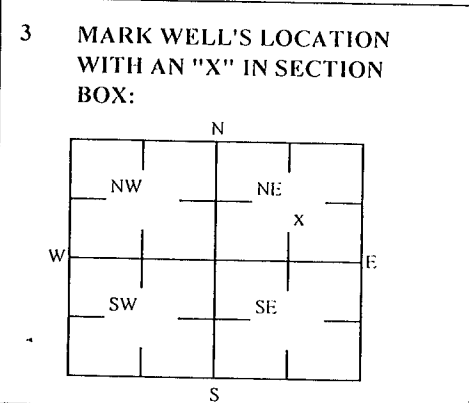

4 DEPTH OF WELL 29.6 ft.
 WELL'S STATIC WATER LEVEL NA ft
 WELL WAS USED AS:
 Domestic Public Water Supply Dewatering
 Irrigation Oil Field Water Supply Monitoring
 Feedlot Domestic (Lawn & Garden) Injection Well
 Industrial Air Conditioning Other _____
 Was a chemical/bacteriological sample submitted to Department? Yes No

5 TYPE OF BLANK CASING USED:
 Steel RMP (SR) Wrought Fiberglass Other (Specific below)
 PVC ABS Asbestos-Cement Concrete Tile
 Blank casing diameter 2 in. Was casing pulled? Yes No If yes, how much 3'
 Casing high above or below land surface NA in.

6 GROUT PLUG MATERIAL: Neat cement Cement grout Bentonite Other Concrete: 0-0.5'; Soil: 0.5-3'
 Grout Plug Intervals: From 3 ft to 29.6 ft, From _____ ft to _____ ft, From _____ ft to _____ ft.
 What is the nearest source of possible contamination:
 Septic tank Sepage pit Fuel storage Other (specify below)
 Sewer lines Pit privy Fertilizer storage
 Watertight sewer lines Sewage lagoon Insecticide storage
 Lateral lines Feed yard Abandoned water well
 Cess pool Livestock pens Oil well/Gas well
 Direction from well? _____
 How many feet? _____

FROM	TO	PLUGGING MATERIALS	FROM	TO	PLUGGING MATERIALS
0	0.5	Concrete			
0.5	3	Soil			
3	29.6	Bentonite			
KDHE ID: Reynolds Short Stop; U1-073-00772					

7 CONTRACTOR'S OR LANDOWNER'S CERTIFICATION: This water well was plugged under my jurisdiction and was completed on (mo/day/year) 5/27/2020 and this record is true to the best of my knowledge and belief. Kansas Water Contractor's License No. 757. This Water Well Record was completed on (mo/day/year) 6/4/2020 under the business name of Larsen & Associates, Inc. By (signature) _____

Send one white copy to Kansas Department of Health & Environment, Geology Section, 1000 SW Jackson Street, Ste. 420, Topeka, KS, 66612-1367. Send one copy to WATER WELL OWNER and retain one for your records
 Visit us at <http://www.kdheks.gov/waterwell/index.html> Telephone 785-296-5524.

NOTE: Figures exhibited within this report are only to be used within the context of this report. Placement of property lines, wells, structures, and roads is based on the available information from county appraiser maps, surveys, site visits, and/or previous vendor reports and should be considered approximate.

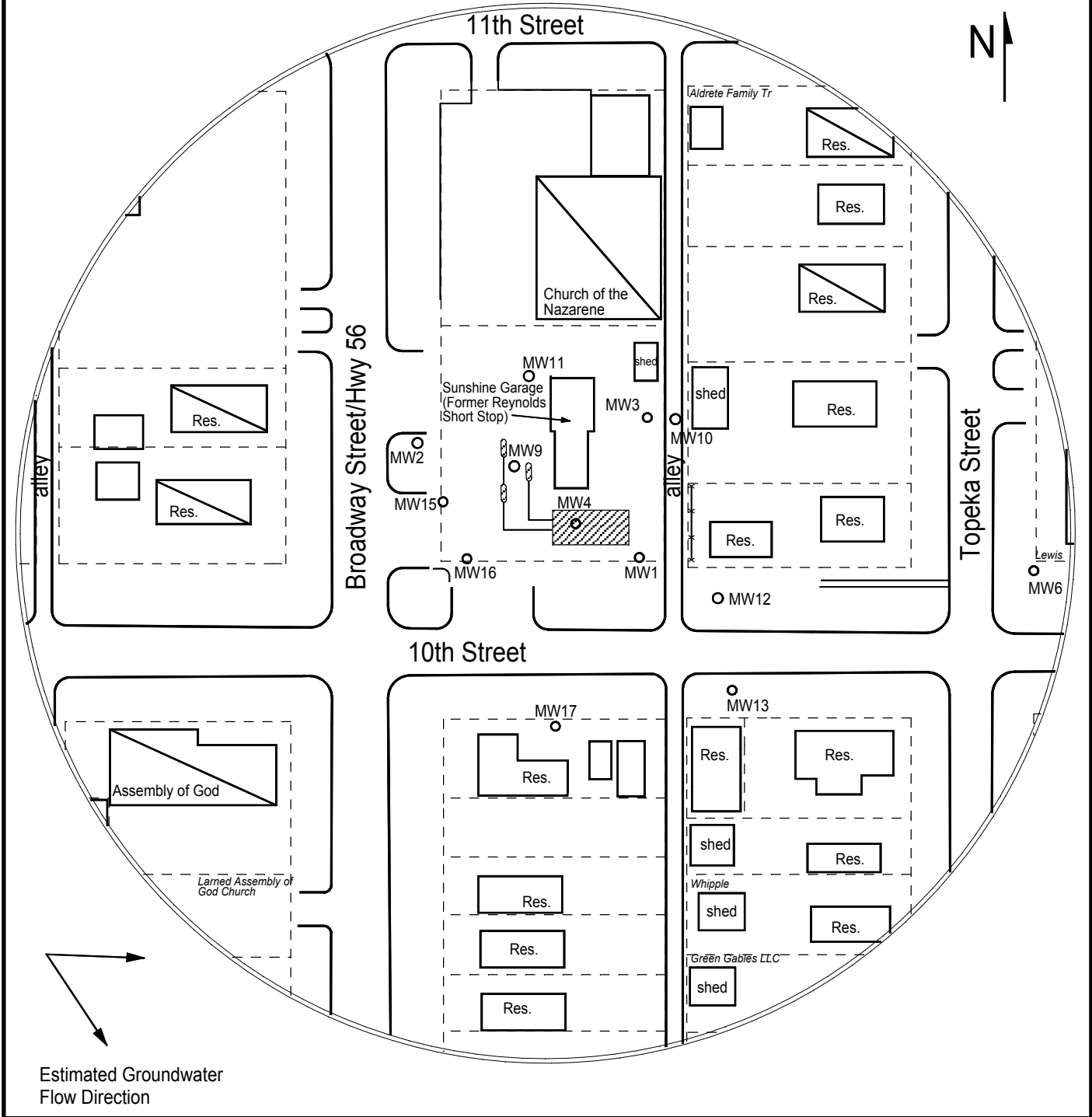

FIGURE 2.1 - 350 FT RADIUS AREA BASE MAP



PROJECT:
 Reynolds Short Stop
 1006 Broadway
 Larned, KS
 KDHE ID: U1-073-00772
 Date: 12/18/19



LEGEND:

- Approximate Location of Former UST Basin, Product Lines & Pump Islands
- Building with Basement
- Approximate Location of Property Line
- Existing Monitoring Well (Installed 12/17/19)
- Suggested Monitoring Well (Drilled 12/18/19)
- Electric Meter
- Gas Lines (1.5 - 3 ft bgs)
- Overhead Lines (25'-40' high)
- Sewer Lines (2 - 6 ft bgs)
- Water Lines (1.5 - 3 ft bgs)

NOTE: SB7 & SB8 were drilled to collect hydrologic samples.
 NOTE: Utility depths, heights and locations are approximate.

1311 E 25th St. Suite B 785-841-8707 office
 Lawrence, KS 66046 785-865-4282 fax