

NOTE: Figures exhibited within this report are only to be used within the context of this report. Placement of property lines, wells, structures, and roads is based on the available information from county appraiser maps, surveys, site visits, and/or previous vendor reports and should be considered approximate.

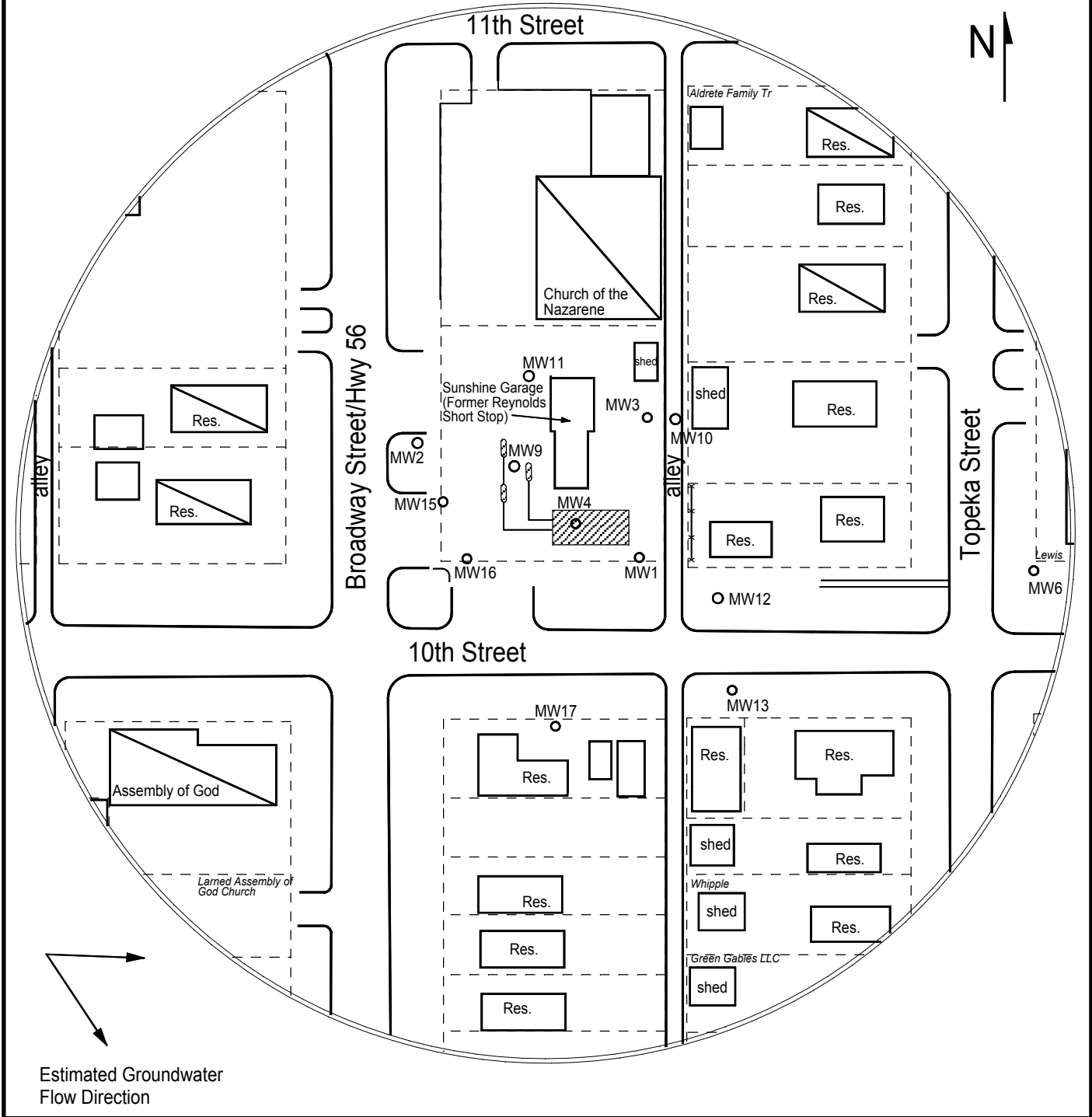

FIGURE 2.1 - 350 FT RADIUS AREA BASE MAP



PROJECT:
 Reynolds Short Stop
 1006 Broadway
 Larned, KS
 KDHE ID: U1-073-00772
 Date: 12/18/19

1311 E 25th St. Suite B 785-841-8707 office
 Lawrence, KS 66046 785-865-4282 fax



LEGEND:

- Approximate Location of Former UST Basin, Product Lines & Pump Islands
- Building with Basement
- Approximate Location of Property Line
- Existing Monitoring Well (Installed 12/17/19)
- Suggested Monitoring Well (Drilled 12/18/19)
- Electric Meter
- Gas Lines (1.5 - 3 ft bgs)
- Overhead Lines (25'-40' high)
- Sewer Lines (2 - 6 ft bgs)
- Water Lines (1.5 - 3 ft bgs)

NOTE: SB7 & SB8 were drilled to collect hydrologic samples.
 NOTE: Utility depths, heights and locations are approximate.