

WATER WELL RECORD

Form WWC-5

Division of Water Resources App. No.

Well ID

MW17

Original Record Correction Change in Well Ust

1 LOCATION OF WATER WELL: County Pawnee Fraction SW 1/4 NE 1/4 SE 1/4 NE 1/4 Section Number 32 Township Number T 21 S Range Number R 16 E W

2 WELL OWNER: Last Name: Van Vleet First: Dean Street or Rural Address where well is located (if unknown, distance and direction from nearest town or intersection): ~100' S of 1006 Broadway, Larned, KS

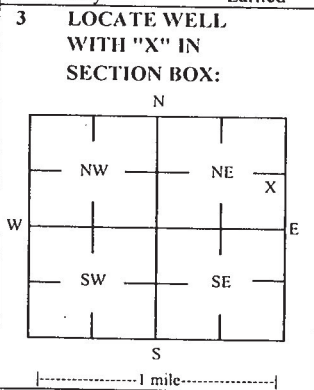

4 DEPTH OF COMPLETED WELL: 30 ft Depth(s) Groundwater Encountered: 1) 1 ft 2) ft 3) ft, or 4) Dry Well WELL'S STATIC WATER LEVEL: 18.70 ft

5 Latitude: 38.18366 (decimal degrees) Longitude: 99.09795 (decimal degrees) Horizontal Datum: WGS 84 NAD 83 NAD 27 Source for Latitude/Longitude: GPS (unit make/model) Land Survey Topographic Map Online Mapper

6 Elevation 2001.24 ft Ground Level TOC Source Land Survey GPS Topographic Map Other

7 WELL WATER TO BE USED AS: 1 Domestic: Household Lawn & Garden Livestock Irrigation Feedlot Industrial 2 Public Water Supply: well ID 3 Dewatering: how many wells? 4 Aquifer Recharge: well ID 5 Monitoring: well ID MW17 6 Environmental Remediation: well ID 7 Air Sparge Soil Vapor Extractor Recovery Injection 8 Oil Field Water Supply: lease 9 Test Hole: well ID Cased Uncased Geotechnical 10 Geothermal: How many bores? a) Closed Loop Horizontal Vertical b) Open Loop Surface Discharge Inj. of Water Other (specify):

Was a chemical/bacteriological sample submitted to KDHE? Yes No If yes, date sample was submitted: Water well disinfected? Yes No

8 TYPE OF CASING USED: Steel PVC Other CASING JOINTS: Glued Clamped Welded Threaded Casing diameter 2 in. to 15 ft, Diameter in. to ft, Diameter in. to ft, Casing height above land surface -0.32 in. Weight lbs./ft. Well thickness or gauge No TYPE OF SCREEN OR PERFORATION MATERIAL: Steel Stainless Steel Fiberglass PVC Brass Galvanized Steel Concrete tile None used (open hole) SCREEN OR PERFORATION OPENINGS ARE: Continuous Slot Mill Slot Gauze Wrapped Torch Cut Drilled Holes Other (Specify) Louvered Shutter Key Punched Wire Wrapped Saw Cut None (Open Hole) SCREEN-PERFORATED INTERVALS: From 15 ft. to 30 ft., From ft. to ft., From ft. to ft., From ft. to ft. GRAVEL PACK INTERVALS: From 13 ft. to 30 ft., From ft. to ft., From ft. to ft., From ft. to ft.

9 GROUT MATERIAL: Neat cement Cement grout Bentonite Other Concrete: 0-0.7' Grout intervals: From 0.7 ft. to 13 ft., From ft. to ft., From ft. to ft., From ft. to ft.

Nearest source of possible contamination: Septic Tank Lateral Lines Pit Privy Livestock Pens Insecticide Storage Sewer Lines Cess Pool Sewage Lagoon Fuel Storage Abandoned Water Well Watertight Sewer Lines Seepage Pit Feedyard Fertilizer Storage Oil Well / Gas Well Other (Specify) Direction from well? North Distance from well? ~125 ft

Table with columns: FROM, TO, LITHOLOGIC LOG, FROM, TO, LITHO. LOG (cont.) or PLUGGING INTERVALS. Rows: 0-0.7 Topsoil; mostly clay, 0.7-7 Silty clay, 7-17.5 Sandy clay, 17.5-28 Sand, alternating bands of very coarse grained sand/gravel, 28-30 Clayey silt

Notes: KDHE ID: Reynolds Short Stop; U1-073-00772

11 CONTRACTOR'S OR LANDOWNER'S CERTIFICATION: This water well was constructed, reconstructed, or plugged under my jurisdiction and was completed on (mo-day-year) 12/17/19 and this record is true to the best of my knowledge and belief. Kansas Water Well Contractor's License No 757 This Water Well Record was completed on (mo-day-year) 1/13/20 under the business name of Larsen & Associates, Inc. Signature

Mail 1 white copy along with a fee of \$5.00 for each constructed well to: Kansas Department of Health and Environment, Bureau of Water, GWIS Section, 1000 SW Jackson St., Suite 420, Topeka, Kansas 66612-1367. Mail one to Water Well Owner and retain one for your records. Telephone 785-296-5524.

# DENNIS L HANDKE

1820 NW 59th Terrace  
TOPEKA, KANSAS 66618  
785-286-4047 Home  
785-286-1990 Fax

Jessica Chapman  
Larsen & Associates  
1311 E. 25<sup>th</sup> Street, Suite B  
Lawrence, Kansas, 66046

December 31, 2019

RE: Monitor Well Elevation Survey  
1006 Broadway, Larned, Kansas

Proj. 19-00SS  
Reynolds Short Stop  
U1-073-00772

Bench Mark: Chisled Square on SW corner of concrete sign base at the SW corner of property.  
Elev: 2003.00      North 3465.69      West 723.61      (from SE Cor. Sec. 32-21-16W)

MW-17	rim	2001.56	North	3373.01	SW1/4,NE1/4,SE1/4,NE1/4
	top pipe	2001.24	West	647.30	Lat= 38.18366 Long = 99.09795

Lat & Long derived Larned 7.5' quad map. NAVD 27

Elevation established from existing project.

If you have any questions, please feel free to call me. Thank you for the opportunity to be of service to you.



RECEIVED

JAN 21 2020

BUREAU OF WATER

NOTE: Figures exhibited within this report are only to be used within the context of this report. Placement of property lines, wells, structures, and roads is based on the available information from county appraiser maps, surveys, site visits, and/or previous vendor reports and should be considered approximate.

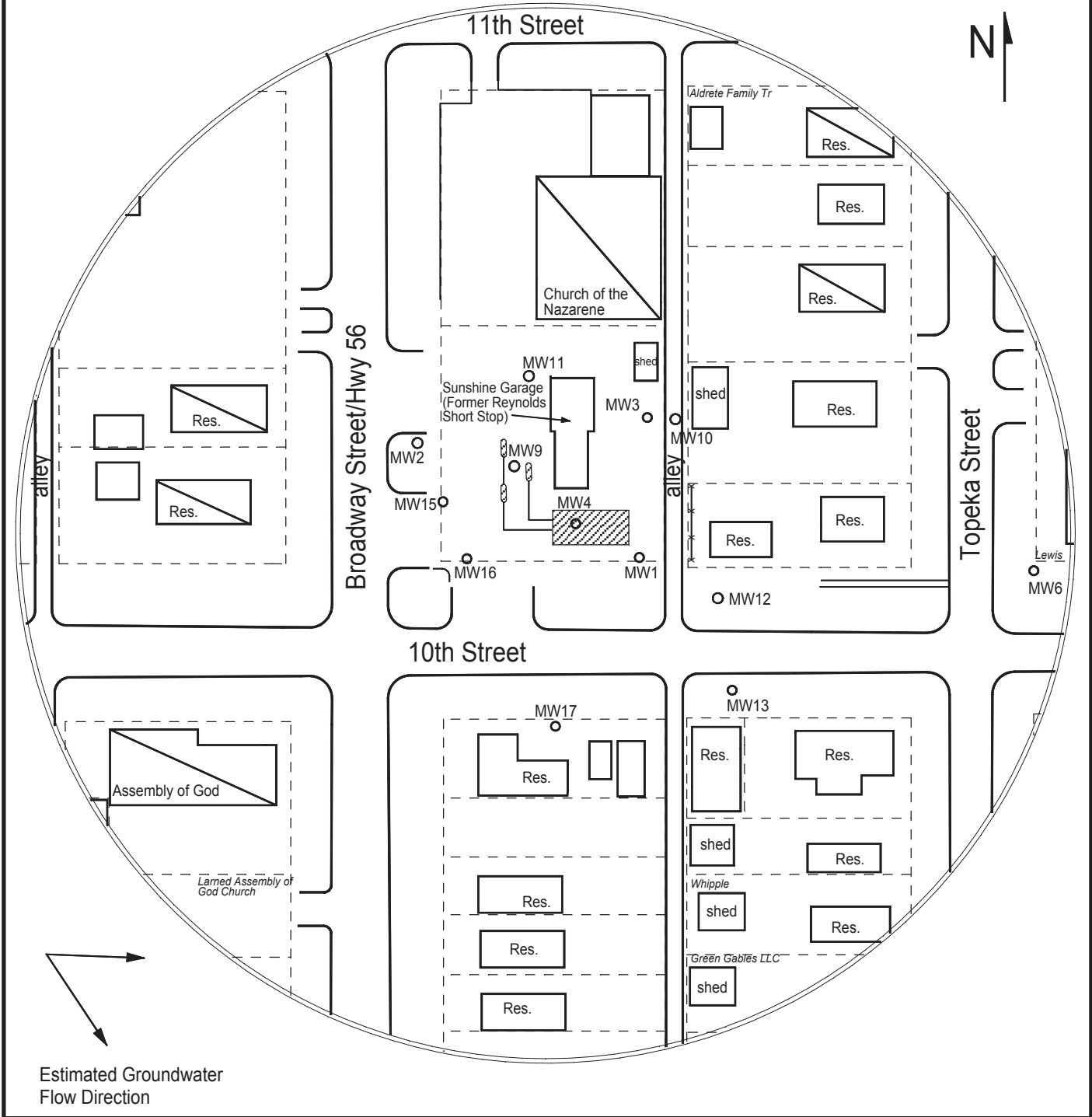

FIGURE 2.1 - 350 FT RADIUS AREA BASE MAP

**larsen**  
& ASSOCIATES, INC.

**PROJECT:**  
 Reynolds Short Stop  
 1006 Broadway  
 Larned, KS  
 KDHE ID: U1-073-00772  
 Date: 12/18/19



1311 E 25th St. Suite B  
 Lawrence, KS 66046  
 785-841-8707 office  
 785-865-4282 fax

**LEGEND:**

- Approximate Location of Former UST Basin, Product Lines & Pump Islands
- Building with Basement
- Approximate Location of Property Line
- Existing Monitoring Well (Installed 12/17/19)
- Suggested Well (Drilled 12/18/19)
- Electric Meter
- Gas Lines (1.5 - 3 ft bgs)
- Overhead Lines (25'-40' high)
- Sewer Lines (2 - 6 ft bgs)
- Water Lines (1.5 - 3 ft bgs)

NOTE: SB7 & SB8 were drilled to collect hydrologic samples.  
 NOTE: Utility depths, heights and locations are approximate.