

WATER WELL RECORD

Form WWC-5

Division of Water Resources App. No.

20284

Well ID

MW6

Original Record Correction Change in Well Use

1 LOCATION OF WATER WELL: County McPherson Fraction NW 1/4 NW 1/4 NW 1/4 NW 1/4 Section Number 26 Township Number T 21 S Range Number R 2 E W

2 WELL OWNER: Last Name: Business: KDHE (Convenience Mart) Address: 1000 SW Jackson Blvd City Topeka State: KS ZIP: 66612 Street or Rural Address where well is located (if unknown, distance and direction from nearest town or intersection): 100 S Christian Ave., Moundridge KS

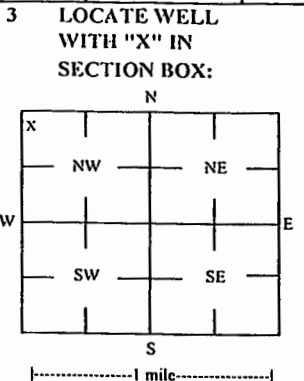

4 DEPTH OF COMPLETED WELL: 39 ft Depth(s) Groundwater Encountered: 1) 26.62 ft 2) 3) 4) Dry Well WELL'S STATIC WATER LEVEL: 26.62 ft below land surface, measured on (mo-day-yr) 12/18/20

5 Latitude: 38.20284 (decimal degrees) Longitude: 97.51891 (decimal degrees) Horizontal Datum: X WGS 84 NAD 83 NAD 27 Source for Latitude/Longitude: GPS (unit make/model) Land Survey Topographic Map Online Mapper

6 Elevation: 1495.58 ft Ground Level: X TOC Source: X Land Survey GPS Topographic Map Other

7 WELL WATER TO BE USED AS: 1 Domestic: Household Lawn & Garden Livestock Irrigation Feedlot Industrial 2 Public Water Supply: well ID 3 Dewatering: how many wells? 4 Aquifer Recharge: well ID 5 Monitoring: well ID MW6 6 Environmental Remediation: well ID Air Sparge Soil Vapor Extractor Recovery Injection 7 Oil Field Water Supply: lease 8 Test Hole: well ID Cased Uncased Geotechnical 9 Geothermal: How many bores? a) Closed Loop Horizontal Vertical b) Open Loop Surface Discharge Inj. of Water Other (specify):

Was a chemical/bacteriological sample submitted to KDHE? Yes No Water well disinfected? Yes No If yes, date sample was submitted:

8 TYPE OF CASING USED: Steel PVC Other CASING JOINTS: Glued Clamped Welded Threaded Casing diameter 2 in. to 24 ft, Diameter in. to ft, Diameter in. to ft, Casing height above land surface -0.30 in. Weight lbs./ft. Well thickness or gauge No TYPE OF SCREEN OR PERFORATION MATERIAL: Steel Stainless Steel Fiberglass PVC Brass Galvanized Steel Concrete tile None used (open hole) SCREEN OR PERFORATION OPENINGS ARE: Continuous Slot Mill Slot Gauze Wrapped Torch Cut Drilled Holes Other (Specify) Louvered Shutter Key Punched Wire Wrapped Saw Cut None (Open Hole) SCREEN-PERFORATED INTERVALS: From 24 ft. to 39 ft. GRAVEL PACK INTERVALS: From 22 ft. to 39 ft.

9 GROUT MATERIAL: Neat cement Cement grout Bentonite Other Concrete: 0-1' Grout intervals: From 1 ft. to 22 ft. From ft. to ft. From ft. to ft.

Nearest source of possible contamination: Septic Tank Lateral Lines Pit Privy Livestock Pens Insecticide Storage Sewer Lines Cess Pool Sewage Lagoon Fuel Storage Abandoned Water Well Watertight Sewer Lines Sepage Pit Feedyard Fertilizer Storage Oil Well / Gas Well Other (Specify) Direction from well? NE Distance from well? ~10 ft

Table with columns: FROM, TO, LITHOLOGIC LOG, FROM, TO, LITHO. LOG (cont.) or PLUGGING INTERVALS. Rows show depth intervals and lithology: 0-0.3 Concrete, 0.3-1 Gravel fill, 1-14.5 Clay, 14.5-22 Clay with coarse sand, 22-30 Clay with trace sand, 30-34 Clay, 34-40 Coarse sand.

11 CONTRACTOR'S OR LANDOWNER'S CERTIFICATION: This water well was constructed, reconstructed, or plugged under my jurisdiction and was completed on (mo-day-yr) 12/17/20 and this record is true to the best of my knowledge and belief. Kansas Water Well Contractor's License No 757 This Water Well Record was completed on (mo-day-yr) 1/6/21 under the business name of Larsen & Associates, Inc. Signature

NOTE: Figures exhibited within this report are only to be used within the context of this report. Placement of property lines, wells, structures, and roads is based on the available information from county appraiser maps, surveys, site visits, and/or previous vendor reports and should be considered approximate.

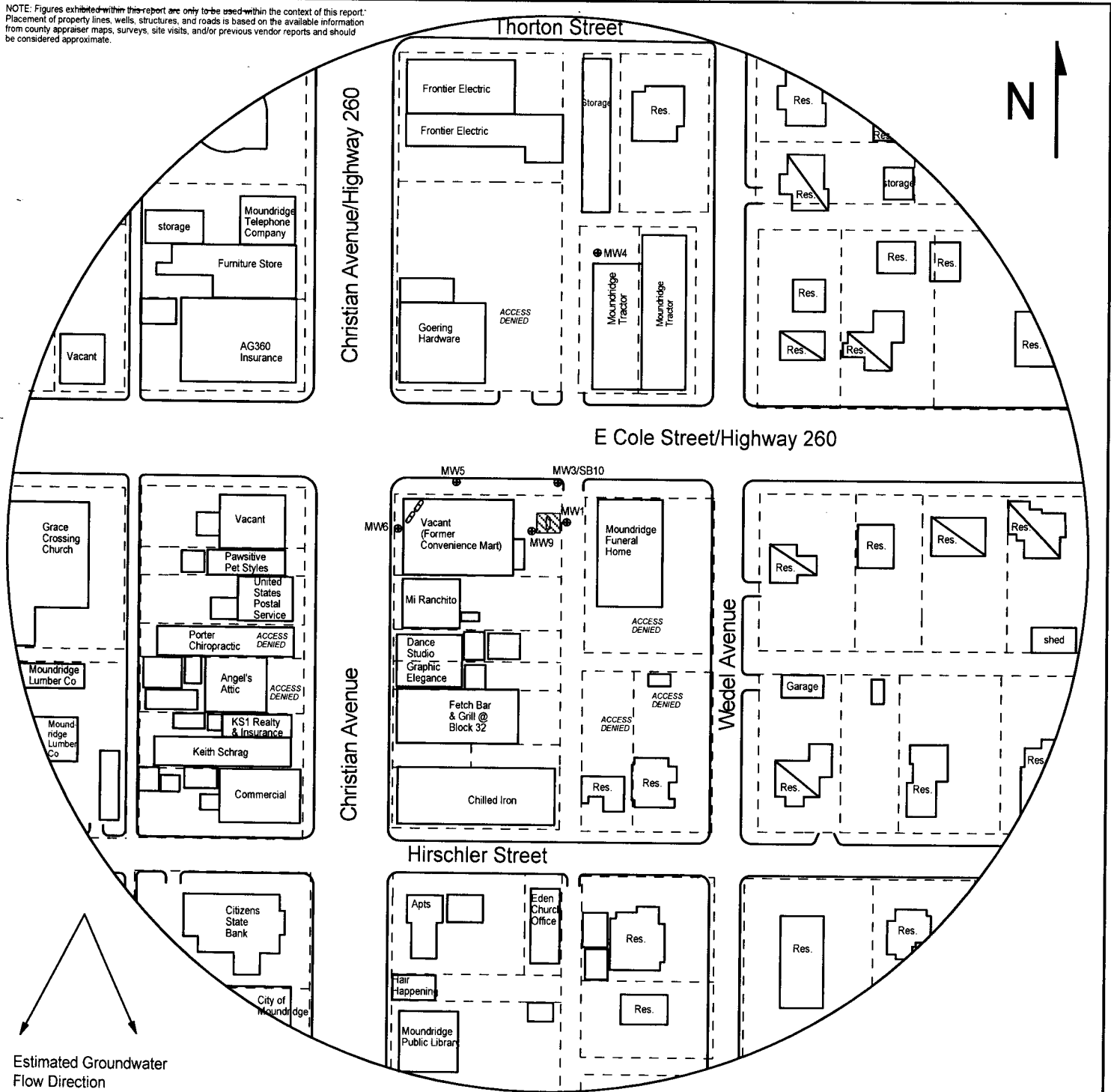

FIGURE 2.2 - 500 FT RADIUS AREA BASE MAP

LEGEND

- Approximate Location of Former UST Basin & Pump Islands
- Building with Basement
- Approximate Location of Property Line
- Monitoring Well (Installed 12/10/20, 12/14-17/20)
- Soil Boring (Drilled 12/9-11/20, 12/15-17/20)
- Fire Hydrant
- Electric Lines (1.5 - 3 ft bgs)
- Gas Lines (1.5 - 3 ft bgs)
- Overhead Lines (25'-40' high)
- Sewer Lines (2 - 6 ft bgs)
- Telephone Lines (2 - 6 ft bgs)
- Water Lines (2 - 6 ft bgs)

NOTE: SB1 and SB10 were drilled to collect hydrologic samples.
NOTE: Utility depths, heights and locations are approximate.



PROJECT:

Convenience Mart
100 S. Christian Ave.
Moundridge, KS
KDHE ID: U5-059-15162
Date: 12/18/20



1311 E 25th St., Suite B 785-841-8707 office
Lawrence, KS 66046 785-865-4282 fax

DENNIS L HANDKE

1820 NW 59th Terrace
TOPEKA, KANSAS 66618
785-286-4047 Home
785-286-1990 Fax

Jess Chapman
Larsen & Associates
1311 E. 25th Street, Suite B
Lawrence, Kansas 66046

December 22, 2020

RE: Monitor Well Elevation Survey
100 S. Christian Ave., Moundridge, Kansas

Proj. 20-00GGG
Convienience Mart
KDHE ID U5-059-15162

Bench Mark: Chisled Sq. on North center of concrete pump island.

Elev: 1497.24 North 5301.44 West 5100.59 (from SE Cor. Sec. 26-21-2W)

MW-1	rim	1496.65	North	5285.32	NW1/4,NW1/4,NW1/4,NW1/4
	top pipe	1496.39	West	5077.91	Lat = 38.20286 Long = 97.51839
MW-3	rim	1496.41	North	5322.87	NW1/4,NW1/4,NW1/4,NW1/4
	top pipe	1496.11	West	5084.23	Lat = 38.20297 Long = 97.51841
MW-4	rim	1496.59	North	5531.62	SW1/4,SW1/4,SW1/4,SW1/4 (Sec. 23-21-2W)
	top pipe	1496.14	West	5052.05	Lat = 38.20354 Long = 97.51830
MW-5	rim	1496.25	North	5322.87	NW1/4,NW1/4,NW1/4,NW1/4
	top pipe	1495.96	West	5184.99	Lat = 38.20296 Long = 97.51876
MW-6	rim	1495.88	North	5275.77	NW1/4,NW1/4,NW1/4,NW1/4
	top pipe	1495.58	West	5227.95	Lat = 38.20284 Long = 97.51891
MW-9	rim	1496.79	North	5271.37	NW1/4,NW1/4,NW1/4,NW1/4
	top pipe	1496.50	West	5099.73	Lat = 38.20282 Long = 97.51846

Elevation derived from NGS BM J 347 1972. NAVD 88.

Lat & Long derived from Moundridge 7.5 Quad Map WGS84.

If you have any questions, please feel free to call me. Thank you for the opportunity to be of service to you.

