

WATER WELL RECORD

Form WWC-5

Division of Water Resources App. No.

Well ID

MW9

Original Record Correction Change in Well Ust

1 LOCATION OF WATER WELL: County McPherson Fraction NW 1/4 NW 1/4 NW 1/4 NW 1/4 Section Number 26 Township Number T 21 S Range Number R 2 E W

2 WELL OWNER: Last Name: First: Street or Rural Address where well is located (if unknown, distance and direction from nearest town or intersection): If at owner's address, check here: Business: KDHE (Convenience Mart) Address: 1000 SW Jackson Blvd Address: 100 S Christian Ave., Moundridge KS City Topeka State: KS ZIP: 66612

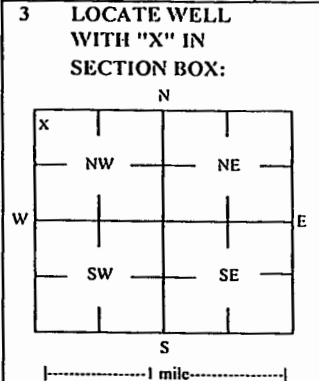

3 LOCATE WELL WITH "X" IN SECTION BOX: N W E S
4 DEPTH OF COMPLETED WELL: 38.5 ft Depth(s) Groundwater Encountered: 1) _____ ft 2) _____ ft 3) _____ ft, or 4) Dry Well WELL'S STATIC WATER LEVEL: below land surface, measured on (mo-day-yr) 12/18/20 above land surface, measured on (mo-day-yr) _____ Pump test data: Well water was _____ ft after _____ hours pumping _____ gpm Water well was _____ ft after _____ hours pumping _____ gpm Estimated Yield: _____ gpm Bore Hole Diameter: 7.25 in to _____ ft, and _____ in to _____ ft

5 Latitude: 38.20282 (decimal degrees) Longitude: 97.51846 (decimal degrees) Horizontal Datum WGS 84 NAD 83 NAD 27 Source for Latitude/Longitude: GPS (unit make/model: _____) (WAAS enabled? Yes No) Land Survey Topographic Map Online Mapper
6 Elevation 1496.50 ft Ground Level TOC Source Land Survey GPS Topographic Map Other _____

7 WELL WATER TO BE USED AS:
1 Domestic: Household Lawn & Garden Livestock Irrigation Feedlot Industrial
2 Public Water Supply: well ID _____
3 Dewatering: how many wells? _____
4 Aquifer Recharge: well ID _____
5 Monitoring: well ID MW9
6 Environmental Remediation: well ID _____
7 Air Sparge Soil Vapor Extractor Recovery Injection
8 Oil Field Water Supply: lease _____
9 Test Hole: well ID _____
10 Cased Uncased Geotechnical
11 Geothermal: How many bores?
a) Closed Loop Horizontal Vertical
b) Open Loop Surface Discharge Inj. of Water
 Other (specify): _____

Was a chemical/bacteriological sample submitted to KDHE? Yes No If yes, date sample was submitted: _____
Water well disinfected? Yes No

8 TYPE OF CASING USED: Steel PVC Other _____ CASING JOINTS: Glued Clamped Welded Threaded
Casing diameter 2 in. to 23.5 ft, Diameter _____ in. to _____ ft, Diameter _____ in. to _____ ft,
Casing height above land surface -0.29 in. Weight _____ lbs./ft. Well thickness or gauge No _____
TYPE OF SCREEN OR PERFORATION MATERIAL:
 Steel Stainless Steel Fiberglass PVC Other (Specify) _____
 Brass Galvanized Steel Concrete tile None used (open hole)
SCREEN OR PERFORATION OPENINGS ARE:
 Continuous Slot Mill Slot Gauze Wrapped Torch Cut Drilled Holes Other (Specify) _____
 Louvered Shutter Key Punched Wire Wrapped Saw Cut None (Open Hole)
SCREEN-PERFORATED INTERVALS: From 23.5 ft. to 38.5 ft, From _____ ft. to _____ ft, From _____ ft. to _____ ft,
GRAVEL PACK INTERVALS: From 21 ft. to 38.5 ft, From _____ ft. to _____ ft, From _____ ft. to _____ ft,

9 GROUT MATERIAL: Neat cement Cement grout Bentonite Other Concrete: 0-1'
Grout intervals: From 1 ft. to 21 ft, From _____ ft. to _____ ft, From _____ ft. to _____ ft,

Nearest source of possible contamination:
 Septic Tank Lateral Lines Pit Privy Livestock Pens Insecticide Storage
 Sewer Lines Cess Pool Sewage Lagoon Fuel Storage Abandoned Water Well
 Watertight Sewer Lines Seepage Pit Feedyard Fertilizer Storage Oil Well / Gas Well
 Other (Specify) _____
Direction from well? W Distance from well? ~5 ft

10 FROM	TO	LITHOLOGIC LOG	FROM	TO	LITHO. LOG (cont.) or PLUGGING INTERVALS
0	0.3	Concrete			
0.3	1	Gravel fill			
1	8	Clay with coarse sand			
8	22.5	Clay			
22.5	30	Coarse sandy clay			
30	38.5	Coarse sand			

Notes: KDHE ID: Convenience Mart; U5-059-15162
Target of monitoring well is shallow groundwater, <20' of grout was installed at the direction of KDHE.

11 CONTRACTOR'S OR LANDOWNER'S CERTIFICATION: This water well was constructed, reconstructed, or plugged under my jurisdiction and was completed on (mo-day-year) 12/16/20 and this record is true to the best of my knowledge and belief. Kansas Water Well Contractor's License No 757 This Water Well Record was completed on (mo-day-year) 1/6/21 under the business name of Larsen & Associates, Inc. Signature _____

NOTE: Figures exhibited within this report are only to be used within the context of this report. Placement of property lines, wells, structures, and roads is based on the available information from county appraiser maps, surveys, site visits, and/or previous vendor reports and should be considered approximate.

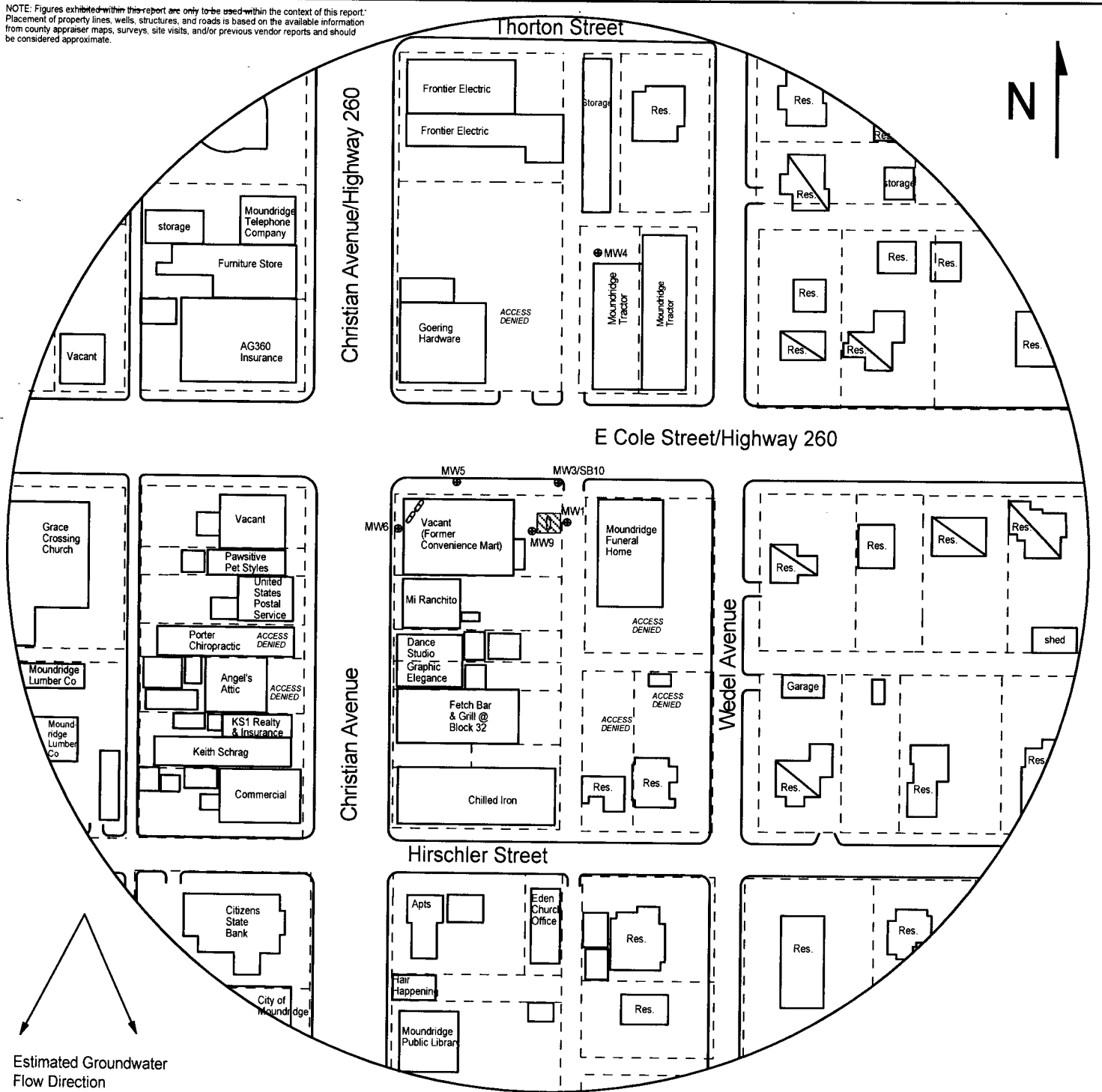

FIGURE 2.2 - 500 FT RADIUS AREA BASE MAP

LEGEND

- Approximate Location of Former UST Basin & Pump Islands
- Building with Basement
- Approximate Location of Property Line
- Monitoring Well (Installed 12/10/20, 12/14-17/20)
- Soil Boring (Drilled 12/9-11/20, 12/15-17/20)
- Fire Hydrant
- Electric Lines (1.5 - 3 ft bgs)
- Gas Lines (1.5 - 3 ft bgs)
- Overhead Lines (25'-40' high)
- Sewer Lines (2 - 6 ft bgs)
- Telephone Lines (2 - 6 ft bgs)
- Water Lines (2 - 6 ft bgs)

NOTE: SB1 and SB10 were drilled to collect hydrologic samples.
NOTE: Utility depths, heights and locations are approximate.



PROJECT:
Convenience Mart
100 S. Christian Ave.
Moundridge, KS
KDHE ID: U5-059-15162
Date: 12/18/20

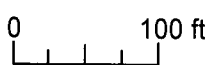

1311 E 25th St., Suite B
Lawrence, KS 66046
785-841-8707 office
785-865-4282 fax

DENNIS L HANDKE

1820 NW 59th Terrace
TOPEKA, KANSAS 66618
785-286-4047 Home
785-286-1990 Fax

Jess Chapman
Larsen & Associates
1311 E. 25th Street, Suite B
Lawrence, Kansas 66046

December 22, 2020

RE: Monitor Well Elevation Survey
100 S. Christian Ave., Moundridge, Kansas

Proj. 20-00GGG
Convienience Mart
KDHE ID U5-059-15162

Bench Mark: Chisled Sq. on North center of concrete pump island.

Elev: 1497.24 North 5301.44 West 5100.59 (from SE Cor. Sec. 26-21-2W)

MW-1	rim	1496.65	North	5285.32	NW1/4,NW1/4,NW1/4,NW1/4
	top pipe	1496.39	West	5077.91	Lat = 38.20286 Long = 97.51839
MW-3	rim	1496.41	North	5322.87	NW1/4,NW1/4,NW1/4,NW1/4
	top pipe	1496.11	West	5084.23	Lat = 38.20297 Long = 97.51841
MW-4	rim	1496.59	North	5531.62	SW1/4,SW1/4,SW1/4,SW1/4 (Sec. 23-21-2W)
	top pipe	1496.14	West	5052.05	Lat = 38.20354 Long = 97.51830
MW-5	rim	1496.25	North	5322.87	NW1/4,NW1/4,NW1/4,NW1/4
	top pipe	1495.96	West	5184.99	Lat = 38.20296 Long = 97.51876
MW-6	rim	1495.88	North	5275.77	NW1/4,NW1/4,NW1/4,NW1/4
	top pipe	1495.58	West	5227.95	Lat = 38.20284 Long = 97.51891
MW-9	rim	1496.79	North	5271.37	NW1/4,NW1/4,NW1/4,NW1/4
	top pipe	1496.50	West	5099.73	Lat = 38.20282 Long = 97.51846

Elevation derived from NGS BM J 347 1972. NAVD 88.

Lat & Long derived from Moundridge 7.5 Quad Map WGS84.

If you have any questions, please feel free to call me. Thank you for the opportunity to be of service to you.

