

WATER WELL RECORD

Form WWC-5

Division of Water Resources App. No.

Well ID

MW3

[X] Original Record [ ] Correction [ ] Change in Well Use

1 LOCATION OF WATER WELL: County McPherson Fraction NW 1/4 NW 1/4 NW 1/4 NW 1/4 Section Number 26 Township Number T 21 S Range Number R 2 [ ] E [X] W

2 WELL OWNER: Last Name: Business: KDHE (Convenience Mart) Address: 1000 SW Jackson Blvd City Topeka State: KS ZIP: 66612 Street or Rural Address where well is located (if unknown, distance and direction from nearest town or intersection): 100 S Christian Ave., Moundridge KS

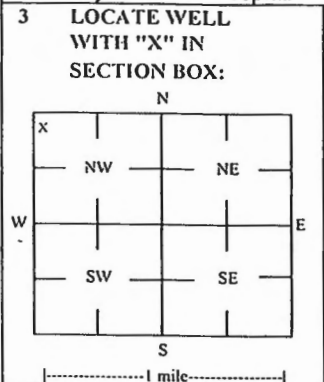

3 LOCATE WELL WITH 'X' IN SECTION BOX: 4 DEPTH OF COMPLETED WELL: 38 ft Depth(s) Groundwater Encountered: 1) \_\_\_\_\_ ft 2) \_\_\_\_\_ ft 3) \_\_\_\_\_ ft, or 4) [ ] Dry Well WELL'S STATIC WATER LEVEL: 26.64 ft. [X] below land surface, measured on (mo-day-yr) 12/18/20 [ ] above land surface, measured on (mo-day-yr) \_\_\_\_\_ Pump test data: Well water was \_\_\_\_\_ ft after \_\_\_\_\_ hours pumping \_\_\_\_\_ gpm Water well was \_\_\_\_\_ ft after \_\_\_\_\_ hours pumping \_\_\_\_\_ gpm Estimated Yield: \_\_\_\_\_ gpm Bore Hole Diameter: 7.25 in to \_\_\_\_\_ ft, and \_\_\_\_\_ in to \_\_\_\_\_ ft

5 Latitude: 38.220297 (decimal degrees) Longitude: 97.51841 (decimal degrees) Horizontal Datum: [X] WGS 84 [ ] NAD 83 [ ] NAD 27 Source for Latitude/Longitude: [ ] GPS (unit make/model: \_\_\_\_\_) (WAAS enabled? [ ] Yes [ ] No) [X] Land Survey [ ] Topographic Map [ ] Online Mapper 6 Elevation 1496.11 ft [ ] Ground Level [X] TOC Source: [X] Land Survey [ ] GPS [ ] Topographic Map [ ] Other \_\_\_\_\_

7 WELL WATER TO BE USED AS: 1 Domestic: [ ] Household [ ] Lawn & Garden [ ] Livestock [ ] Irrigation [ ] Feedlot [ ] Industrial 2 [ ] Public Water Supply: well ID \_\_\_\_\_ 3 [ ] Dewatering: how many wells? \_\_\_\_\_ 4 [ ] Aquifer Recharge: well ID \_\_\_\_\_ 5 [X] Monitoring: well ID MW3 6 [ ] Environmental Remediation: well ID \_\_\_\_\_ 7 [ ] Air Sparge [ ] Soil Vapor Extractor [ ] Recovery [ ] Injection 8 [ ] Oil Field Water Supply: lease \_\_\_\_\_ 9 [ ] Test Hole: well ID \_\_\_\_\_ [ ] Cased [ ] Uncased [ ] Geotechnical 10 [ ] Geothermal: How many bores? \_\_\_\_\_ a) Closed Loop [ ] Horizontal [ ] Vertical b) Open Loop [ ] Surface Discharge [ ] Inj. of Water [ ] Other (specify): \_\_\_\_\_

Was a chemical/bacteriological sample submitted to KDHE? [ ] Yes [X] No If yes, date sample was submitted: \_\_\_\_\_ Water well disinfected? [ ] Yes [X] No

8 TYPE OF CASING USED: [ ] Steel [X] PVC [ ] Other \_\_\_\_\_ CASING JOINTS: [ ] Glued [ ] Clamped [ ] Welded [X] Threaded Casing diameter 2 in. to 23 ft, Diameter \_\_\_\_\_ in. to \_\_\_\_\_ ft, Diameter \_\_\_\_\_ in. to \_\_\_\_\_ ft, Casing height above land surface -0.30 in. Weight \_\_\_\_\_ lbs./ft. Well thickness or gauge No \_\_\_\_\_ TYPE OF SCREEN OR PERFORATION MATERIAL: [ ] Steel [ ] Stainless Steel [ ] Fiberglass [X] PVC [ ] Other (Specify) \_\_\_\_\_ [ ] Brass [ ] Galvanized Steel [ ] Concrete tile [ ] None used (open hole) SCREEN OR PERFORATION OPENINGS ARE: [ ] Continuous Slot [X] Mill Slot [ ] Gauze Wrapped [ ] Torch Cut [ ] Drilled Holes [ ] Other (Specify) \_\_\_\_\_ [ ] Louvered Shutter [ ] Key Punched [ ] Wire Wrapped [ ] Saw Cut [ ] None (Open Hole) SCREEN-PERFORATED INTERVALS: From 23 ft. to 38 ft, From \_\_\_\_\_ ft. to \_\_\_\_\_ ft, From \_\_\_\_\_ ft. to \_\_\_\_\_ ft, GRAVEL PACK INTERVALS: From 21 ft. to 38 ft, From \_\_\_\_\_ ft. to \_\_\_\_\_ ft, From \_\_\_\_\_ ft. to \_\_\_\_\_ ft,

9 GROUT MATERIAL: [ ] Neat cement [ ] Cement grout [X] Bentonite [X] Other Concrete: 0-1' Grout intervals: From 1 ft. to 21 ft, From \_\_\_\_\_ ft. to \_\_\_\_\_ ft, From \_\_\_\_\_ ft. to \_\_\_\_\_ ft,

Nearest source of possible contamination: [ ] Septic Tank [ ] Lateral Lines [ ] Pit Privy [ ] Livestock Pens [ ] Insecticide Storage [ ] Sewer Lines [ ] Cess Pool [ ] Sewage Lagoon [X] Fuel Storage [ ] Abandoned Water Well [ ] Watertight Sewer Lines [ ] Sepage Pit [ ] Feedyard [ ] Fertilizer Storage [ ] Oil Well / Gas Well [ ] Other (Specify) \_\_\_\_\_

Direction from well? S Distance from well? -25 ft

Table with 6 columns: FROM, TO, LITHOLOGIC LOG, FROM, TO, LITHO. LOG (cont.) or PLUGGING INTERVALS. Rows show depth intervals and lithology: 0-0.3 Concrete, 0.3-1 Gravel fill, 1-16 Clay, 16-30 Clay with some coarse sand, 30-38 Coarse sand.

Notes: KDHE ID: Convenience Mart; U5-059-15162 Target of monitoring well is shallow groundwater, <20' of grout was installed at the direction of KDHE.

11 CONTRACTOR'S OR LANDOWNER'S CERTIFICATION: This water well was [X] constructed, [ ] reconstructed, or [ ] plugged under my jurisdiction and was completed on (mo-day-year) 12/16/20 and this record is true to the best of my knowledge and belief. Kansas Water Well Contractor's License No 757 This Water Well Record was completed on (mo-day-year) 1/6/21 under the business name of Larsen & Associates, Inc. Signature \_\_\_\_\_

Mail 1 white copy along with a fee of \$5.00 for each constructed well to: Kansas Department of Health and Environment, Bureau of Water, GWIS Section, 1000 SW Jackson St., Suite 420, Topeka, Kansas 66612-1367. Mail one to Water Well Owner and retain one for your records. Telephone 785-296-5524.

26-21-2  
S T R

NOTE: Figures exhibited within this report are only to be used within the context of this report. Placement of property lines, wells, structures, and roads is based on the available information from county appraiser maps, surveys, site visits, and/or previous vendor reports and should be considered approximate.

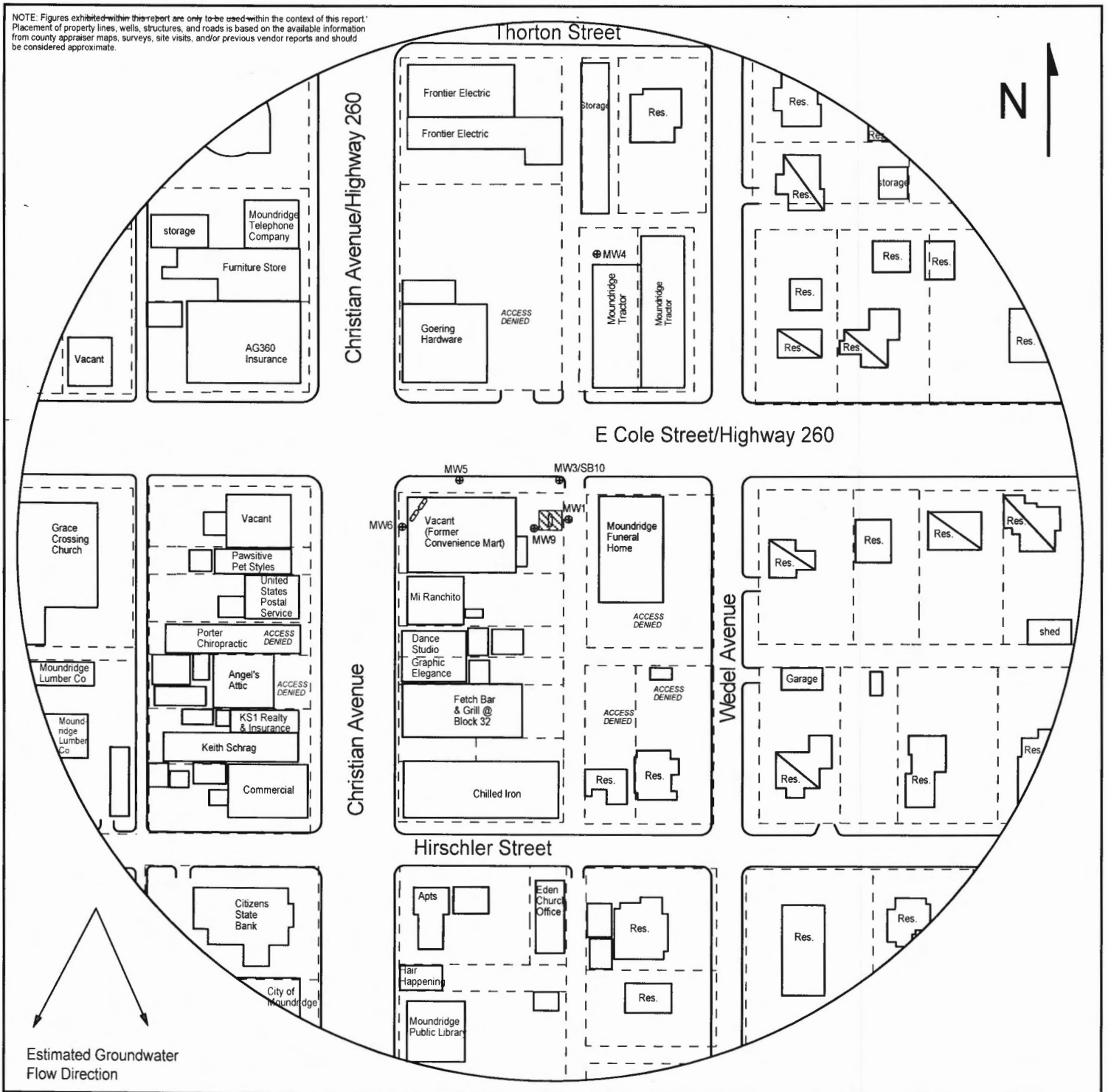

FIGURE 2.2 - 500 FT RADIUS AREA BASE MAP

**LEGEND**

- Approximate Location of Former UST Basin & Pump Islands
- Building with Basement
- Approximate Location of Property Line
- Monitoring Well (Installed 12/10/20, 12/14-17/20)
- Soil Boring (Drilled 12/9-11/20, 12/15-17/20)
- Fire Hydrant
- Electric Lines (1.5 - 3 ft bgs)
- Gas Lines (1.5 - 3 ft bgs)
- Overhead Lines (25'-40' high)
- Sewer Lines (2 - 6 ft bgs)
- Telephone Lines (2 - 6 ft bgs)
- Water Lines (2 - 6 ft bgs)

NOTE: SB1 and SB10 were drilled to collect hydrologic samples  
NOTE: Utility depths, heights and locations are approximate



**PROJECT:**

Convenience Mart  
100 S. Christian Ave.  
Moundridge, KS  
KDHE ID: U5-059-15162  
Date: 12/18/20



1311 E 25th St., Suite B    785-841-8707 office  
Lawrence, KS 66046        785-865-4282 fax

# DENNIS L HANDKE

1820 NW 59th Terrace  
TOPEKA, KANSAS 66618  
785-286-4047 Home  
785-286-1990 Fax

Jess Chapman  
Larsen & Associates  
1311 E. 25<sup>th</sup> Street, Suite B  
Lawrence, Kansas 66046

December 22, 2020

RE: Monitor Well Elevation Survey  
100 S. Christian Ave., Moundridge, Kansas

Proj. 20-00GGG  
Convienience Mart  
KDHE ID U5-059-15162

Bench Mark: Chisled Sq. on North center of concrete pump island.

Elev:		North	West	(from SE Cor. Sec. 26-21-2W)	
MW-1	rim	1496.65	North 5285.32	NW1/4,NW1/4,NW1/4,NW1/4	
	top pipe	1496.39	West 5077.91	Lat = 38.20286 Long = 97.51839	
MW-3	rim	1496.41	North 5322.87	NW1/4,NW1/4,NW1/4,NW1/4	
	top pipe	1496.11	West 5084.23	Lat = 38.20297 Long = 97.51841	
MW-4	rim	1496.59	North 5531.62	SW1/4,SW1/4,SW1/4,SW1/4 (Sec. 23-21-2W)	
	top pipe	1496.14	West 5052.05	Lat = 38.20354 Long = 97.51830	
MW-5	rim	1496.25	North 5322.87	NW1/4,NW1/4,NW1/4,NW1/4	
	top pipe	1495.96	West 5184.99	Lat = 38.20296 Long = 97.51876	
MW-6	rim	1495.88	North 5275.77	NW1/4,NW1/4,NW1/4,NW1/4	
	top pipe	1495.58	West 5227.95	Lat = 38.20284 Long = 97.51891	
MW-9	rim	1496.79	North 5271.37	NW1/4,NW1/4,NW1/4,NW1/4	
	top pipe	1496.50	West 5099.73	Lat = 38.20282 Long = 97.51846	

Elevation derived from NGS BM J 347 1972. NAVD 88.

Lat & Long derived from Moundridge 7.5 Quad Map WGS84.

If you have any questions, please feel free to call me. Thank you for the opportunity to be of service to you.

