

WATER WELL RECORD

Form WWC-5

Division of Water Resources App. No.

4618

1 LOCATION OF WATER WELL: County: Hodgeman Fraction 1/4 NC 1/4 W2 1/4 NW 1/4 Section Number 35 Township No. T 21 S Range Number R 21 [] E [x] W

Street/Rural Address of Well Location; if unknown, distance & direction from nearest town or intersection: If at owner's address, check here []. 4 West, 1/4 South of Burdett Global Positioning System (GPS) information: Latitude: Longitude: Elevation: Datum: [] WGS 84, [] NAD 83, [] NAD 27 Collection Method: [] GPS unit, [] Digital Map/Photo, [] Topographic Map, [] Land Survey Est. Accuracy: [] <3 m, [] 3-5 m, [] 5-15 m, [] >15 m

2 WATER WELL OWNER: Gary Pelton RR#, Street Address, Box #: 3592 R Road City, State, ZIP Code : Burdett, Ks. 67523

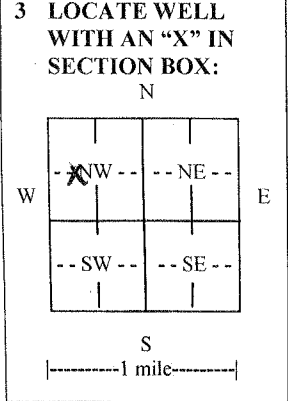

3 LOCATE WELL WITH AN 'X' IN SECTION BOX: 4 DEPTH OF COMPLETED WELL 110 ft. Depth(s) Groundwater Encountered (1)..... ft. (2)..... ft. (3)..... ft. WELL'S STATIC WATER LEVEL 55 ft. below land surface measured on mo/day/yr. 4-13-12 Pump test data: Well water was 76 ft. after 3 hours pumping 363 gpm EST. YIELD 413 gpm. Well water was 78 ft. after 3 1/2 hours pumping 413 gpm Bore Hole Diameter 40 in. to 110 ft., and in. to ft. WELL WATER TO BE USED AS: [] Public water supply [] Geothermal [] Injection well [] Domestic [] Feedlot [] Oil field water supply [] Dewatering [] Other (Specify below) [x] Irrigation [] Industrial [] Domestic-lawn & garden [] Monitoring well Was a chemical/bacteriological sample submitted to Department? [] Yes [x] No If yes, mo/day/yr sample was submitted Water well disinfected? [x] Yes [] No

5 TYPE OF CASING USED: [] Steel [x] PVC [] Other CASING JOINTS: [x] Glued [] Clamped [] Welded [] Threaded Casing diameter 16 in. to 110 ft., Diameter in. to ft., Diameter in. to ft. Casing height above land surface 18 in., Weight Sch 40 lbs./ft., Wall thickness or gauge No. TYPE OF SCREEN OR PERFORATION MATERIAL: [] Steel [] Stainless Steel [x] PVC [] Other (Specify) [] Brass [] Galvanized Steel [] None used (open hole) SCREEN OR PERFORATION OPENINGS ARE: [] Continuous slot [] Mill slot [] Gauze wrapped [] Torch cut [] Drilled holes [] None (open hole) [] Louvered shutter [] Key punched [] Wire wrapped [x] Saw cut [] Other (specify) SCREEN-PERFORATED INTERVALS: From 110 ft. to 70 ft., From ft. to ft. GRAVEL PACK INTERVALS: From 110 ft. to 20 ft., From ft. to ft.

6 GROUT MATERIAL: [] Neat cement [] Cement grout [x] Bentonite [] Other Grout Intervals: From ft. to ft., From 20 ft. to 0 ft., From ft. to ft. What is the nearest source of possible contamination: [] Septic tank [] Lateral lines [] Pit privy [] Livestock pens [] Insecticide storage [x] Other (specify below) [] Sewer lines [] Cesspool [] Sewage lagoon [] Fuel storage [] Abandoned water well [] Watertight sewer lines [] Seepage pit [] Feedyard [] Fertilizer storage [] Oil well/gas well None Direction from well Distance from well

Table with columns: FROM, TO, LITHOLOGIC LOG, FROM, TO, LITHO. LOG (cont.) or PLUGGING INTERVALS. Rows include soil types like Top soil, Brown & gray clay, Tough gray clay, Sand & gravel-fine to small, loose, sand & gravel- small with flat rock, Sand & gravel-small w/ broken, flat rock & clay bits, Gray clay, Sand & gravel-fine to small w/small flat rock.

7 CONTRACTOR'S OR LANDOWNER'S CERTIFICATION: This water well was [x] constructed, [] reconstructed, or [] plugged under my jurisdiction and was completed on (mo/day/year) 4-13-12 and this record is true to the best of my knowledge and belief. Kansas Water Well Contractor's License No. 134 This Water Well Record was completed on (mo/day/year) 5-17-12 under the business name of Rosencrantz-Bemis by (signature) Jona Aley

INSTRUCTIONS: Use typewriter or ball point pen. PLEASE PRESS FIRMLY and PRINT clearly. Please fill in blanks and check the correct answers. Send three copies (white, blue, pink) to Kansas Department of Health and Environment, Bureau of Water, Geology Section, 1000 SW Jackson St., Suite 420, Topeka, Kansas 66612-1367. Telephone 785-296-5524. Send one copy to WATER WELL OWNER and retain one for your records. I include fee of \$5.00 for each constructed well. Visit us at http://www.kdheks.gov/waterwell/index.html.