

WATER WELL PLUGGING RECORD Form WWC-5P

KSA 82a-1212 ID NO.

38770

1 LOCATION OF WATER WELL: County: Rice	Fraction ¼ ¼ NC ¼ NE ¼	Section Number 14	Township Number T 21 S	Range Number 7 <input type="checkbox"/> E <input checked="" type="checkbox"/> W
--	---------------------------	----------------------	---------------------------	--

Street/Rural Address of Well Location; if unknown, distance & direction from nearest town or intersection: If at owner's address, check here From Sterling 8E 3/4N WSR

Global Positioning Systems (GPS) information:
 Latitude: 38.22814 (in decimal degrees)
 Longitude: 098.05495 (in decimal degrees)
 Elevation: 1597
 Datum: WGS84, NAD83, NAD27
 Collection Method:
 GPS unit (Make/Model: Garmin 62S)
 Digital Map/Photo, Topographic Map, Land Survey
 Est. Accuracy: < 3 m, 3-5 m, 5-15 m, > 15 m

2 WATER WELL OWNER: Doug L. & Debbie Engelland
 RR#, St. Address, Box #: 2255 Avenue V
 City, State ZIP Code: Sterling, Kansas 67579

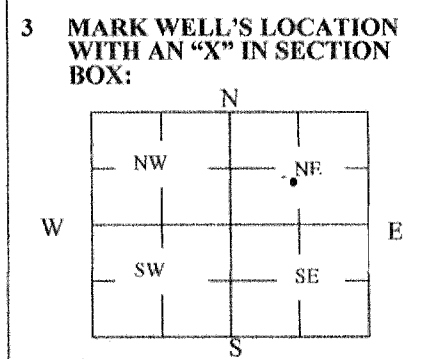

4 DEPTH OF WELL 40 ft.
WELL'S STATIC WATER LEVEL 6 ft
WELL WAS USED AS:
 Domestic Public Water Supply Dewatering
 Irrigation Oil Field Water Supply Monitoring
 Feedlot Domestic (Lawn & Garden) Injection Well
 Industrial Air Conditioning Other _____
 Was a chemical/bacteriological sample submitted to Department? Yes No

5 TYPE OF BLANK CASING USED:
 Steel RMP (SR) Wrought Fiberglass Other (Specify below)
 PVC ABS Asbestos-Cement Concrete Tile
 Blank casing diameter 16 in. Was casing pulled? Yes No If yes, how much _____
 Casing height above or below land surface 36 in.

6 GROUT PLUG MATERIAL: Neat cement Cement grout Bentonite Other Sand-top soil
 Grout Plug Intervals: From 40 ft. to 10 ft., From 10 ft. to 3 ft., From 3 to 0 ft.
 What is the nearest source of possible contamination:
 Septic tank Seepage pit Fuel Storage Other (specify below) New irrigation well
 Sewer lines Pit privy Fertilizer storage
 Watertight sewer lines Sewage lagoon Insecticide storage
 Lateral lines Feedyard Abandoned water well Direction from well? SW
 Cess pool Livestock pens Oil well/Gas well How many feet? 30'

FROM	TO	PLUGGING MATERIALS	FROM	TO	PLUGGING MATERIALS
0	3	Top soil			
3	10	Bentonite			
10	40	Sand			

7 CONTRACTOR'S OR LANDOWNER'S CERTIFICATION: This water well was plugged under my jurisdiction and was completed on (mo/day/year) 10/16/2013 and this record is true to the best of my knowledge and belief. Kansas Water Well Contractor's License No. 134. This Water Well Record was completed on (mo/day/year) 11/4/2013 under the business name of Rosencrantz-Bemis Ent. by (signature) *C. J. Smith*

INSTRUCTIONS: Use typewriter or ballpoint pen. Please press firmly and print clearly. Please fill in blanks, underline or circle the correct answers. Send top three copies to Kansas Department of Health and Environment, Bureau of Water, Geology Section, 1000 SW Jackson St., Ste. 420, Topeka, Kansas 66612-1367. Telephone: 785/296-5524. Send one to Water Well Owner and retain one for your records. Visit us at <http://www.kdheks.gov/waterwell/index.html>.

Check one: White Copy Blue Copy Pink Copy