

WATER WELL RECORD

Form WWC-5

Division of Water Resources App. No.

1 LOCATION OF WATER WELL: County: RICE	Fraction SW ¼ SW ¼ SW ¼ NE ¼	Section Number 21	Township No. T 21 S	Range Number R 8 <input type="checkbox"/> E <input checked="" type="checkbox"/> W
--	---------------------------------	----------------------	------------------------	--

Street/Rural Address of Well Location; if unknown, distance & direction from nearest town or intersection: If at owner's address, check here .
124 N. Broadway, Sterling, KS

Global Positioning System (GPS) information:
 Latitude: 38.21079 (in decimal degrees)
 Longitude: 98.20672 (in decimal degrees)
 Elevation:
 Datum: WGS 84, NAD 83, NAD 27
 Collection Method:
 GPS unit (Make/Model:)
 Digital Map/Photo, Topographic Map, Land Survey
 Est. Accuracy: <3 m, 3-5 m, 5-15 m, >15 m

2 WATER WELL OWNER: KDHE(Former Car Dealership)
 RR#, Street Address, Box #: 1000 SW JACKSON STREET
 City, State, ZIP Code : TOPEKA, KS 66612-1367

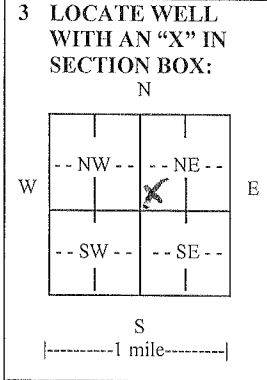

4 DEPTH OF COMPLETED WELL 17.0 ft.
 Depth(s) Groundwater Encountered (1) 7.6' ft. (2) ft. (3) ft.
 WELL'S STATIC WATER LEVEL ft. below land surface measured on mo/day/yr
 Pump test data: Well water was ft. after hours pumping gpm
 EST. YIELD gpm. Well water was ft. after hours pumping gpm
 Bore Hole Diameter in. to ft., and in. to ft.
 WELL WATER TO BE USED AS: Public water supply Geothermal Injection well
 Domestic Feedlot Oil field water supply Dewatering Other (Specify below)
 Irrigation Industrial Domestic-lawn & garden Monitoring well OxygenInjection06
 Was a chemical/bacteriological sample submitted to Department? Yes No
 If yes, mo/day/yr sample was submitted
 Water well disinfected? Yes No

5 TYPE OF CASING USED: Steel PVC Other
 CASING JOINTS: Glued Clamped Welded Threaded
 Casing diameter .1" in. to ft., Diameter in. to ft., Diameter in. to ft.
 Casing height above land surface 1.56 in., Weight lbs./ft., Wall thickness or gauge No. Sch. 40 PVC
 TYPE OF SCREEN OR PERFORATION MATERIAL:
 Steel Stainless Steel PVC Other (Specify)
 Brass Galvanized Steel None used (open hole)
 SCREEN OR PERFORATION OPENINGS ARE:
 Continuous slot Mill slot Gauze wrapped Torch cut Drilled holes None (open hole)
 Louvered shutter Key punched Wire wrapped Saw cut Other (specify)
 SCREEN-PERFORATED INTERVALS: From 15 ft. to 16 ft., From ft. to ft.
 From ft. to ft., From ft. to ft.
 GRAVEL PACK INTERVALS: From 13 ft. to 17 ft., From ft. to ft.
 From ft. to ft., From ft. to ft.

6 GROUT MATERIAL: Neat cement Cement grout Bentonite Other
 Grout Intervals: From 1 ft. to 13 ft., From ft. to ft., From ft. to ft.
 What is the nearest source of possible contamination:
 Septic tank Lateral lines Pit privy Livestock pens Insecticide storage Other (specify below)
 Sewer lines Cesspool Sewage lagoon Fuel storage Abandoned water well
 Watertight sewer lines Seepage pit Feedyard Fertilizer storage Oil well/gas well Lust Site
 Direction from well Distance from well

FROM	TO	LITHOLOGIC LOG	FROM	TO	LITHO. LOG (cont.) or PLUGGING INTERVALS
0	2	Concrete			
2	6	Clay, silty			
6	17	Sand, very fine to fine			
					OIP6

7 CONTRACTOR'S OR LANDOWNER'S CERTIFICATION: This water well was constructed, reconstructed, or plugged under my jurisdiction and was completed on (mo/day/year) 06/29/2011 and this record is true to the best of my knowledge and belief. Kansas Water Well Contractor's License No. 594 This Water Well Record was completed on (mo/day/year) 010/05/2011 under the business name of Coranco Great Plains, Inc. by (signature) [Signature]

INSTRUCTIONS: Use typewriter or ball point pen. PLEASE PRESS FIRMLY and PRINT clearly. Please fill in blanks and check the correct answers. Send three copies (white, blue, pink) to Kansas Department of Health and Environment, Bureau of Water, Geology Section, 1000 SW Jackson St., Suite 420, Topeka, Kansas 66612-1367. Telephone 785-296-5522. Send one copy to WATER WELL OWNER and retain one for your records. Include fee of \$5.00 for each constructed well. Visit us at <http://www.kdheks.gov/waterwell/index.html>.