

WATER WELL RECORD Form WWC-5

Original Record Correction Change in Well Use

Division of Water Resources App. No.

Well ID

Well ID

1 LOCATION OF WATER WELL: County: Fraction 1/4 1/4 1/4 1/4 Section Number Township Number T S Range Number R E W

2 WELL OWNER: Last Name: Business: Address: City: State: ZIP: Street or Rural Address where well is located

3 LOCATE WELL WITH 'X' IN SECTION BOX: N W E S 1 mile

4 DEPTH OF COMPLETED WELL: Depth(s) Groundwater Encountered: WELL'S STATIC WATER LEVEL: Pump test data: Estimated Yield: Bore Hole Diameter:

5 Latitude: Longitude: Datum: Source for Latitude/Longitude: GPS Land Survey Topographic Map Online Mapper

6 Elevation: Source: Land Survey GPS Topographic Map Other

7 WELL WATER TO BE USED AS: 1. Domestic: 2. Irrigation: 3. Feedlot: 4. Industrial: 5. Public Water Supply: 6. Dewatering: 7. Aquifer Recharge: 8. Monitoring: 9. Environmental Remediation: 10. Oil Field Water Supply: 11. Test Hole: 12. Geothermal: 13. Other

Was a chemical/bacteriological sample submitted to KDHE? Water well disinfected?

8 TYPE OF CASING USED: CASING JOINTS: TYPE OF SCREEN OR PERFORATION MATERIAL: SCREEN OR PERFORATION OPENINGS ARE: SCREEN-PERFORATED INTERVALS: GRAVEL PACK INTERVALS:

9 GROUT MATERIAL: Grout Intervals: Nearest source of possible contamination: Direction from well? Distance from well?

Table with 6 columns: FROM, TO, LITHOLOGIC LOG, FROM, TO, LITHO. LOG (cont.) or PLUGGING INTERVALS. Includes a Notes section.

11 CONTRACTOR'S OR LANDOWNER'S CERTIFICATION: This water well was constructed, reconstructed, or plugged under my jurisdiction and was completed on (mo-day-year) and this record is true to the best of my knowledge and belief.

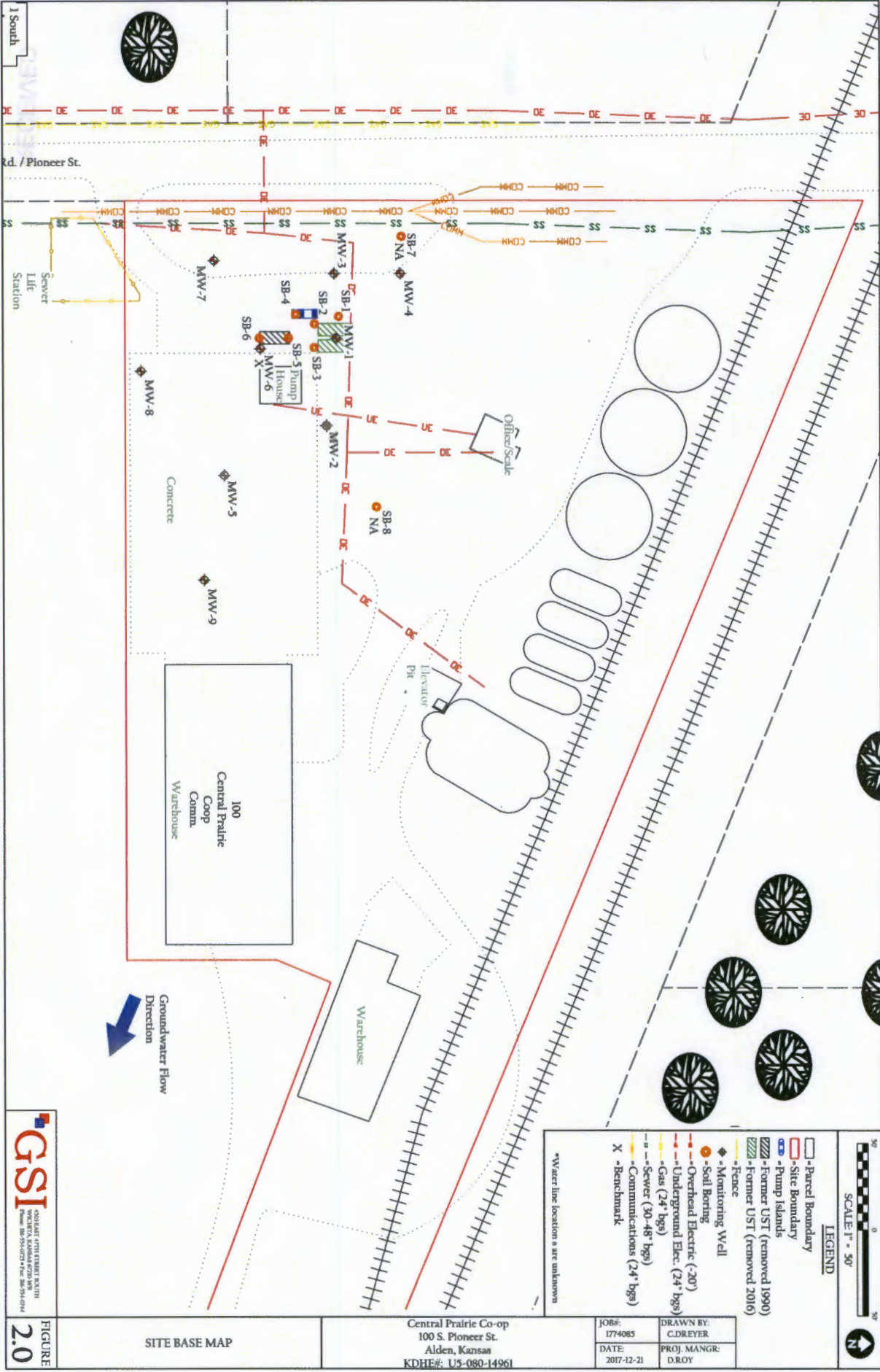

**GSI**  
 GEOTECHNICAL SERVICES, INC.  
 1000 S. W. 10th St., Suite 100  
 Ft. Lauderdale, FL 33311  
 Phone: 561-527-2727 • Fax: 561-527-6144

FIGURE  
**2.0**

SITE BASE MAP

Central Prairie Co-op  
 100 S. Pioneer St.  
 Alden, Kansas  
 KDHE#: U5-080-14961

JO#6: 1774065	DRAWN BY: C.DREYER
DATE: 2017-12-21	PROJ. MANGR: D.ROY

- SCALE 1" = 50'
- LEGEND**
- ▭ Parcel Boundary
  - ▭ Site Boundary
  - ▭ Pump Islands
  - ▭ Former UST (removed 1990)
  - ▭ Former UST (removed 2016)
  - ◆ Fence
  - ◆ Monitoring Well
  - ◆ Soil Boring
  - ◆ Overhead Electric (20')
  - ◆ Underground Elec. (24' bgs)
  - ◆ Gas (24' bgs)
  - ◆ Sewer (30-48" bgs)
  - ◆ Communications (24' bgs)
  - X Benchmark
- \*Well location s are unknown