

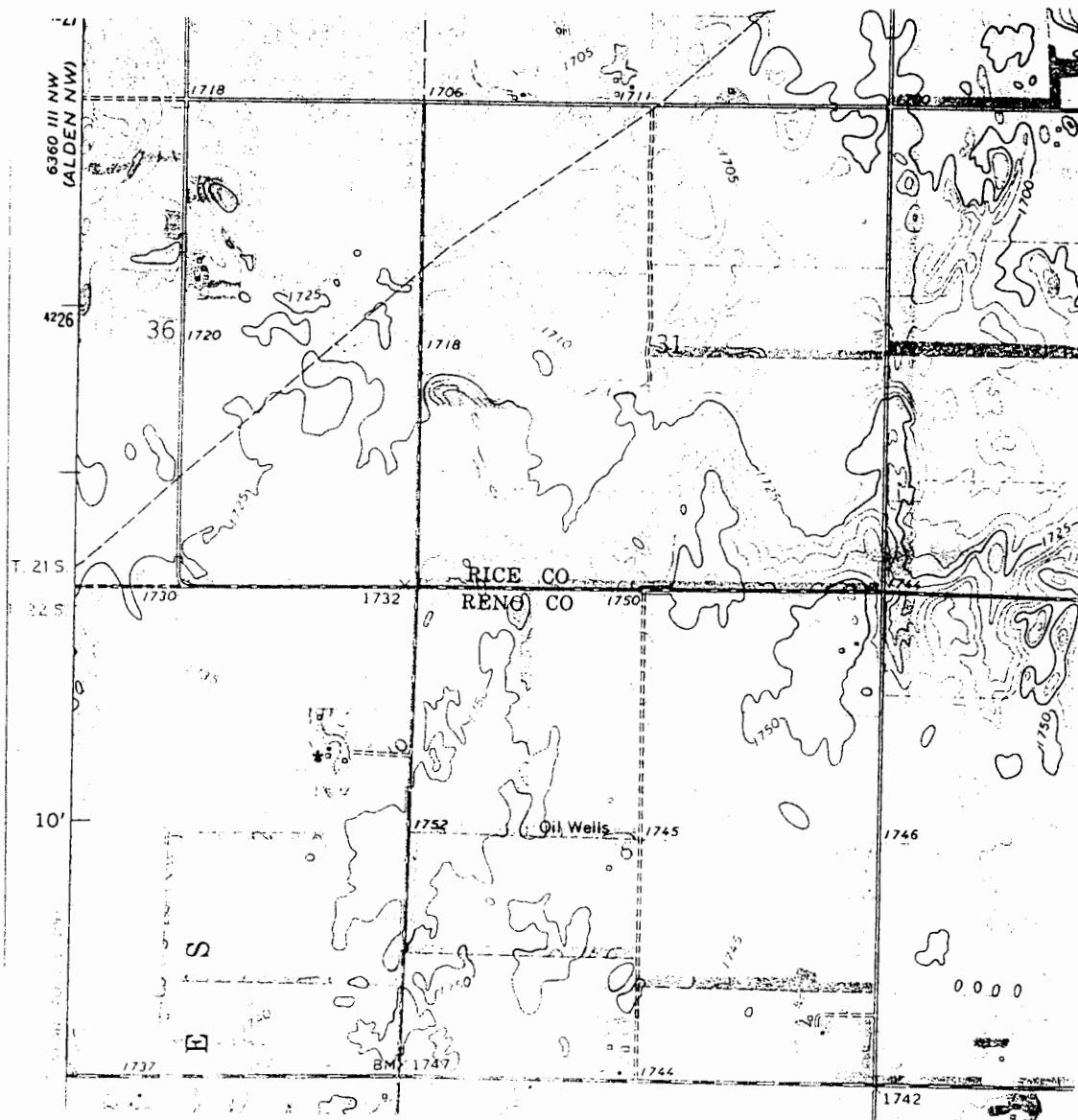

SITE NUMBER : 24  
SITE LOCATION : NW SE NE  
LEGAL LOCATION: SEC1 T22S R10W  
COUNTY : RENO

LANDOWNER: HUGH STOUT  
ADDRESS : ROUTE 1  
ALDEN, KANSAS 67512  
PHONE NO.: 316-278-2197



WELL LOCATION \*

BIG BEND GMD#5-KGS  
WATER QUALITY  
OBSERVATION WELL  
NETWORK

SITE NUMBER : 24  
SITE LOCATION: NW SE NE

LEGAL LOCATION: 1-22-10W  
COUNTY : RENO

## WELL LOG

FROM	TO	LITHOLOGIC LOG	OWNER: STOUT
1741	0	2	topsoil
1739	2	4	fine sand
1733	4	10	fine and medium sand, some silt
1719	10	24	coarse sand, trace silt
1709	24	34	sand and tan clay
1701	34	42	tan clay and fine sand
1685	42	58	fine to coarse sand; some tan clay(poss. from up-hole)
1679	58	64	same, also noticeable trace of silt
1649	64	94	mostly fine sand
1644	94	99	sand and some silt
1623	99	120	gravel
1620	120	125/123	gray clay, some gravel which is probably from up-hole
143	125	145	redbed shale PERMIAN