

Site #24(1)

## WATER WELL RECORD

Form WWC-5

KSA 82a-1212

LOCATION OF WATER WELL:	Fraction	Section Number	Township Number	Range Number
County: <b>Reno</b>	NW 1/4 SE 1/4 NE 1/4	1	T 22 S	R 10 E (W)

Distance and direction from nearest town or city street address of well if located within city?

8 1/2 mi W, 2 1/2 mi S of Sterling

WATER WELL OWNER: KGS/GWMD#5

RR#, St. Address, Box # :

Board of Agriculture, Division of Water Resources

City, State, ZIP Code :

Application Number:

LOCATE WELL'S LOCATION WITH AN "X" IN SECTION BOX:

4 DEPTH OF COMPLETED WELL: 145 ft. ELEVATION:

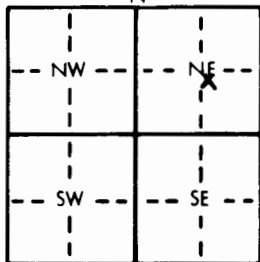

Depth(s) Groundwater Encountered 1. ft. 2. ft. 3. ft.

WELL'S STATIC WATER LEVEL 31.16 ft. below land surface measured on mo/day/yr 3/82

Pump test data: Well water was ft. after hours pumping gpm

Est. Yield gpm: Well water was ft. after hours pumping gpm

Bore Hole Diameter 9.7/8 in. to 140 ft. and 6 in. to 145 ft.

WELL WATER TO BE USED AS: 5 Public water supply 8 Air conditioning 11 Injection well

1 Domestic 3 Feedlot 6 Oil field water supply 9 Dewatering 12 Other (Specify below)

2 Irrigation 4 Industrial 7 Lawn and garden only 10 Observation well

Was a chemical/bacteriological sample submitted to Department? Yes No X If yes, mo/day/yr sample was submitted

Water Well Disinfected? Yes No

TYPE OF BLANK CASING USED:

- 1 Steel  
2 PVC  
3 RMP (SR)  
4 ABS

- 5 Wrought iron  
6 Asbestos-Cement  
7 Fiberglass  
8 Concrete tile  
9 Other (specify below)

CASING JOINTS: Glued Clamped  
Welded  
Threaded

Blank casing diameter 5.0 in. to 131 ft. Dia in. to ft. Dia in. to ft.

Casing height above land surface 1.90' in. weight lbs./ft. Wall thickness or gauge No. Schd #40

TYPE OF SCREEN OR PERFORATION MATERIAL:

- 1 Steel  
2 Brass  
3 Stainless steel  
4 Galvanized steel

- 5 Fiberglass  
6 Concrete tile  
7 PVC  
8 RMP (SR)  
9 ABS

- 10 Asbestos-cement  
11 Other (specify)  
12 None used (open hole)

SCREEN OR PERFORATION OPENINGS ARE:

- 1 Continuous slot  
2 Louvered shutter  
3 Mill slot  
4 Key punched

- 5 Gauzed wrapped  
6 Wire wrapped  
7 Torch cut

- 8 Saw cut  
9 Drilled holes  
10 Other (specify)  
11 None (open hole)

SCREEN-PERFORATED INTERVALS: From 131 ft. to 136 ft. From ft. to ft.

From ft. to ft. From ft. to ft.

GRAVEL PACK INTERVALS: From 129 ft. to 136 ft. From ft. to ft.

From ft. to ft. From ft. to ft.

GROUT MATERIAL:

1 Neat cement

2 Cement grout

3 Bentonite

4 Other

Grout Intervals: From 20 ft. to 129 ft. From 0 ft. to 10 ft. From ft. to ft.

What is the nearest source of possible contamination: Unknown

- 1 Septic tank  
2 Sewer lines  
3 Watertight sewer lines  
4 Lateral lines  
5 Cess pool  
6 Seepage pit  
7 Pit privy  
8 Sewage lagoon  
9 Feedyard

- 10 Livestock pens  
11 Fuel storage  
12 Fertilizer storage  
13 Insecticide storage  
14 Abandoned water well  
15 Oil well/Gas well  
16 Other (specify below)

Direction from well?

How many feet?

FROM	TO	LITHOLOGIC LOG	FROM	TO	LITHOLOGIC LOG
0	2	top soil			
2	10	sand & silt			
10	24	coarse sand			
24	42	tan sandy clay			
42	64	fn-crse sand - tan clay stringers			
64	99	fine sand			
99	120	gravel			
120	125	gray clay			
125	145	red siltstone			
		(140-145 cored)			

7 CONTRACTOR'S OR LANDOWNER'S CERTIFICATION: This water well was (1) constructed, (2) reconstructed, or (3) plugged under my jurisdiction and was completed on (mo/day/year) 8/12/81 and this record is true to the best of my knowledge and belief. Kansas

Water Well Contractor's License No. This Water Well Record was completed on (mo/day/yr) 9/27/83

under the business name of Kansas Geological Survey by (signature) Thomas M. Chis

INSTRUCTIONS: Use typewriter or ball point pen, PLEASE PRESS FIRMLY and PRINT clearly. Please fill in blanks, underline or circle the correct answers. Send top three copies to Kansas Department of Health and Environment, Division of Environment, Environmental Geology Section, Topeka, KS 66620. Send one to WATER WELL OWNER and retain one for your records.

BIG BEND GMD#5-KGS  
WATER QUALITY  
OBSERVATION WELL  
NETWORK

SITE NUMBER : 24  
SITE LOCATION: NW SE NE

LEGAL LOCATION: 1-22-10W  
COUNTY : RENO

## WELL LOG

[illegible]

SITE NUMBER : 24  
SITE LOCATION : NW SE NE  
LEGAL LOCATION: SEC1 T22S R10W  
COUNTY : RENO

LANDOWNER: HUGH STOUT  
ADDRESS : ROUTE 1  
ALDEN, KANSAS 67512  
PHONE NO.: 316-278-2197

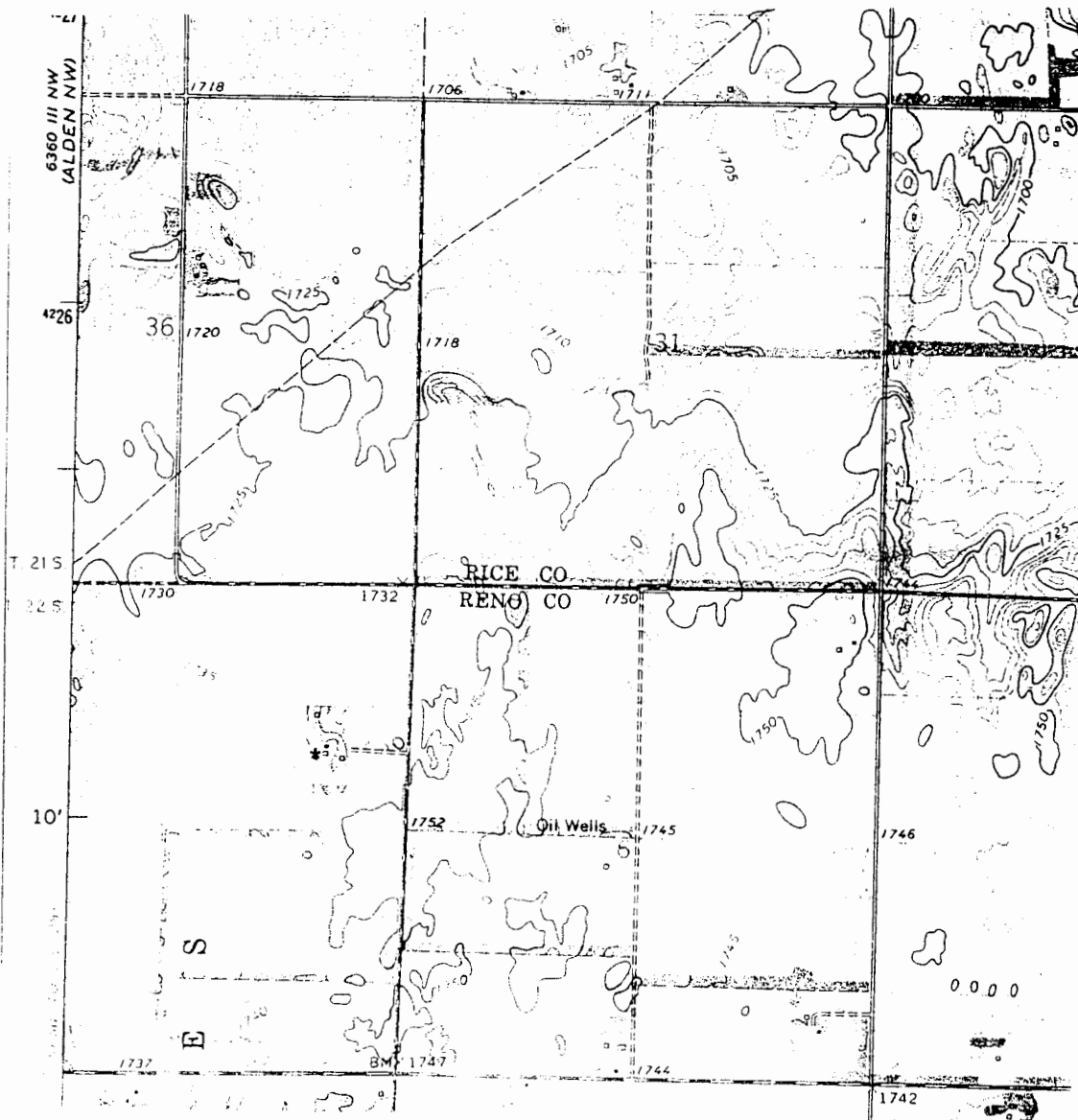

WELL LOCATION \*