

**WATER WELL RECORD**

**Form WWC-5**

Division of Water Resources; App. No.

SFW3720  
20080548

<b>1 LOCATION OF WATER WELL:</b> County: <u>Stafford</u>	Fraction <u>SW ¼ SE ¼ NW ¼</u>	Section Number <u>33</u>	Township Number <u>T 22 S</u>	Range Number <u>R 11 W</u>
---	-----------------------------------	-----------------------------	----------------------------------	-------------------------------

Distance and direction from nearest town or city street address of well if located within city?  
6 ½ East, ½ South of Hudson

**2 WATER WELL OWNER:** Cambria Corp.  
RR#, St. Address, Box # : P.O. Box 1065  
City, State, ZIP Code : Great Bend, Ks. 67530

**Global Positioning Systems** (decimal degrees, min. of 4 digits)  
Latitude: \_\_\_\_\_  
Longitude: \_\_\_\_\_  
Elevation: \_\_\_\_\_  
Datum: \_\_\_\_\_  
Data Collection Method: \_\_\_\_\_

**3 LOCATE WELL'S LOCATION WITH AN "X" IN SECTION BOX:**

N

	NW	NE	
W	X		E
	SW	SE	
	S		

**4 DEPTH OF COMPLETED WELL** ..... 70 ft.

Depth(s) Groundwater Encountered (1)..... ft. (2)..... ft. (3)..... ft.  
WELL'S STATIC WATER LEVEL.....1..... ft. below land surface measured on mo/day/yr. 12-24-08.  
Pump test data: Well water was.....ft. after..... hours pumping..... gpm  
Est. Yield...N/Agpm: Well water was.....ft. after..... hours pumping..... gpm  
WELL WATER TO BE USED AS: 5 Public water supply 8 Air conditioning 11 Injection well  
1 Domestic 3 Feedlot 6 Oil field water supply 9 Dewatering 12 Other (Specify below)  
2 Irrigation 4 Industrial 7 Domestic (lawn & garden) 10 Monitoring well .....

Was a chemical/bacteriological sample submitted to Department? Yes ..... No ...X....; If yes, mo/day/yr  
Sample was submitted..... Water well disinfected? Yes ...HH... No .....

**5 TYPE OF CASING USED:**

1 Steel	3 RMP (SR)	6 Asbestos-Cement	9 Other (specify below)	CASING JOINTS: Glued... <u>X</u> ... Clamped.....
2 <u>PVC</u>	4 ABS	7 Fiberglass		Welded.....
				Threaded.....

Blank casing diameter .....5..... in. to .....50..... ft., Diameter. .... in. to ..... ft., Diameter ..... in. to .....ft.  
Casing height above land surface.....24..... in., Weight .....SDR-26...lbs./ft. Wall thickness or guage No. ....

TYPE OF SCREEN OR PERFORATION MATERIAL:

1 Steel	3 Stainless Steel	5 Fiberglass	7 <u>PVC</u>	9 ABS	11 Other (Specify) .....
2 Brass	4 Galvanized Steel	6 Concrete tile	8 RM (SR)	10 Asbestos-Cement	12 None used (open hole)

SCREEN OR PERFORATION OPENINGS ARE:

1 Continuous slot	3 Mill slot	5 Gauzed wrapped	7 Torch cut	9 Drilled holes	11 None (open hole)
2 Louvered shutter	4 Key punched	6 Wire wrapped	8 <u>Saw cut</u>	10 Other (specify) .....	

SCREEN-PERFORATED INTERVALS: From...70..... ft. to .....50..... ft., From ..... ft. to ..... ft.  
From..... ft. to ..... ft., From ..... ft. to ..... ft.

GRAVEL PACK INTERVALS: From...70..... ft. to .....15..... ft., From ..... ft. to ..... ft.  
From..... ft. to ..... ft., From ..... ft. to ..... ft.

**6 GROUT MATERIAL:** 1 Neat cement 2 Cement grout 3 Bentonite 4 Other ...hole plug.....

Grout Intervals: From ..... ft. to ..... ft., From ..... ft. to ..... ft., From ..... 15..... ft. to ..... 0.....ft.

What is the nearest source of possible contamination:

1 Septic tank	4 Lateral lines	7 Pit privy	10 Livestock pens	13 Insecticide storage	16 Other (specify below)
2 Sewer lines	5 Cess pool	8 Sewage lagoon	11 Fuel storage	14 Abandoned water well	
3 Watertight sewer lines	6 Seepage pit	9 Feedyard	12 Fertilizer storage	15 <u>Oil well/gas well</u>	

Direction from well? ...~~Northeast~~... Northeast..... How many feet? ...500.....

FROM	TO	LITHOLOGIC LOG	FROM	TO	PLUGGING INTERVALS
0	6	Dark brown clay			
6	9 ½	Dark gray clay			
9 ½	47	Tan clay			
47	57	Sandy clay			
57	70	Sand & gravel			

**7 CONTRACTOR'S OR LANDOWNER'S CERTIFICATION:** This water well was (1) constructed, (2) reconstructed, or (3) plugged under my jurisdiction and was completed on (mo/day/year) ..12-24-08... and this record is true to the best of my knowledge and belief. Kansas Water Well Contractor's License No. 134..... This Water Well Record was completed on (mo/day/year) ..12-29-08..... under the business name of Rosencrantz- Bemis by (signature) Jora Alip

**INSTRUCTIONS:** Use typewriter or ball point pen. PLEASE PRESS FIRMLY and PRINT clearly. Please fill in blanks, underline or circle the correct answers. Send top three copies to Kansas Department of Health and Environment, Bureau of Water, Geology Section, 1000 SW Jackson St., Suite 420, Topeka, Kansas 66612-1367. Telephone 785-296-5522. Send one to WATER WELL OWNER and retain one for your records. Fee of \$5.00 for each constructed well. Visit us at <http://www.kdheks.gov/waterwell/index.html>.



K A N S A S

RODERICK L. BREMBY, SECRETARY

KATHLEEN SEBELIUS, GOVERNOR

DEPARTMENT OF HEALTH AND ENVIRONMENT

March 5, 2009

*May 27, 2009*

Cambria Corp. *P.O. Box 1065*  
P.O. Box ~~742~~  
Great Bend, KS 67530

*Assignment to Landowner*

*Enclosed*

*Robert J. Dougherty*

Re: Appropriation of Water, Application Number 20080548

Dear Sir/Madam:

The Division of Water Resources, Kansas Department of Agriculture (DWR) has notified the Kansas Department of Health and Environment (KDHE) the above described Temporary Permit has been issued to you. The Temporary Permit originally authorized the use of groundwater to be withdrawn by means of the water supply well located as described below:

1 well located in the SW 1/4 SE 1/4 NW 1/4 S33 T22S R11W Stafford County, Kansas

Temporary Permits are issued for a duration of 6 months by the DWR. After the Temporary Permit expires KDHE considers the water well abandoned and Kansas Administrative Regulation (K.A.R.) 28-30-7(a) requires abandoned water wells to be plugged or caused to be plugged by the landowner. Once a water well has been plugged, K.A.R. 28-30-4 requires a plugging report (Form WWC-5 or WWC-5 "P") to be completed and returned to KDHE.

Please answer the following question concerning the water well. Sign on the signature line and return this letter to: KDHE, Attn: Geology Section, Bureau of Water, 1000 SW Jackson St., Suite 420, Topeka, Kansas 66612-1367 within two weeks from the date of this letter. If this form is not returned within two weeks, this may result in a follow-up by KDHE to determine the status of the well. If you have questions or need assistance with the form please contact Richard Harper at (785) 296-3565 or by e-mail at [rharper@kdheks.gov](mailto:rharper@kdheks.gov).

Sincerely,

*Richard D Harper*

Richard Harper, LG  
Water Well Unit Chief  
Geology Section/Bureau of Water

RECEIVED

MAY 29 2009

cc: SWDO  
Stafford 4

BUREAU OF WATER

DIVISION OF ENVIRONMENT

Bureau of Water

CURTIS STATE OFFICE BUILDING, 1000 SW JACKSON ST., STE 420, TOPEKA, KS 66612-1367

Voice 785-296-5500

Fax 785-296-0086

<http://www.kdhe.state.ks.us>

Printed on Recycled Paper

ASSIGNMENT OF WATER WELL TO LANDOWNER

PERMIT NO.- 20080548

This agreement between Cambrin Corp. P.O. Box 1065 Great Bend  
(Operator name and address)

and Randy Fritzscheier 2802 S. Salt Marsh Rd. Stafford  
(Landowner name and address)

certifies that said Landowner hereby accepts the water well drilled as a temporary source of water for an oil well drilled for Operator located approximately SW/SE/NW in Section 33 Township 22 Range 11 of Stafford County, Kansas. Landowner hereby agrees that said water well will be for domestic use only and when no longer needed, agrees to plug the water well in accordance with the State Regulation KAR 28-30-7.

Signed this 20<sup>th</sup> day of May, 2009

OPERATOR:  
Cambrin Corporation  
By: Robert D. Langherty  
Agent

LANDOWNER:  
Randy Fritzscheier  
Randy Fritzscheier  
Signature

RECEIVED  
MAY 29 2009  
BUREAU OF WATER

**KANSAS**  
DEPARTMENT OF AGRICULTURE

Kathleen Sebelius, Governor  
Adrian J. Polansky, Secretary

www.ksda.gov/dwr

*Randy Fritzemeier*

*Water Well Chlorides = 800 PPM*

December 18, 2008

*Period of Use*

*12/24/2008*

*6/23/2009*

ROSENCRANTZ-BEMIS -  
PO BOX 713  
GREAT BEND KS 67530

RE: Temporary Permit  
File No. 20080548

Dear Sir or Madam:

Your application for temporary permit to appropriate water for beneficial use has been examined, approved, and is being returned herewith for your records.

The approval of your application constitutes a temporary permit to appropriate water for beneficial use, as set forth in the application. This permit does not give authority to any right-of-way, or authorize injury to, or trespass upon public or private property, does not constitute authority under K.S.A. 82a 301 through 305 to construct any dam or other obstruction; nor does it obviate the necessity of assent from Federal or Local Governmental authorities, when necessary. Records must be maintained from which the quantity of water actually diverted may be readily determined.

K.S.A. 82a-728 sets forth, in essence, that it is unlawful to divert or threaten to divert water for the type use you propose without first acquiring approval of the Chief Engineer of the Division of Water Resources. K.S.A. 82a-737 sets forth that violation of the Kansas Water Appropriation Act, any adopted rule or regulation, or any order of the Chief Engineer, may be subject to a civil penalty of up to \$1000, per violation. Each day that any such violation occurs can be considered a separate offense.

*Enclosed*

If you anticipate transferring the ownership of the well(s) authorized by this Temporary Permit to the landowner for other purposes after the expiration date of this Temporary Permit, the wells(s) must initially be properly constructed by the well driller to comply with Article 30 of the Rules and Regulations as adopted by the Kansas Department of Health and Environment. Also, if use and responsibility for maintenance of the well is transferred to the landowner, a copy of the legal transfer must be forwarded to the Kansas Department of Health and Environment, Geology Section, 1000 SW Jackson, Suite 420, Topeka, Kansas, 66612-1364, telephone (785) 296-5524. If this well will not be used after expiration of this Temporary Permit, you must make certain that the well(s) are plugged in accordance with the requirements of Article 30 of the Rules and Regulations as adopted by the Kansas Department of Health and Environment.

If you have any questions, please contact our office at (785) 296-3717. If you wish to discuss a specific file, please have the file number ready so that I may help you more efficiently.

Sincerely,

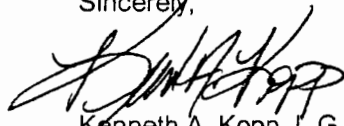

Kenneth A. Kopp, L.G.  
Environmental Scientist  
Water Appropriation Program

RECEIVED

MAY 29 2009

BUREAU OF WATER

Enclosures  
pc: Randy Fritzemeier  
GMD No. 5

Submit To:

CHIEF ENGINEER  
Division of Water Resources  
Kansas Department of Agriculture  
109 SW 9<sup>th</sup> Street, 2nd Floor  
Topeka, KS 66612-1283

**APPLICATION FOR  
TEMPORARY PERMIT**  
 GROUNDWATER  
 SURFACE WATER  
(check one)

WATER RESOURCE  
RECEIVED



DEC 17 2008

1:33 PM

KS DEPT OF AGRICULTURE

The State of Kansas -1

BY KAK  
DATE 12/17/2008

**A STATUTORY FILING FEE OF \$200.00 MUST ACCOMPANY THIS APPLICATION**  
(Make check payable to the Department of Agriculture)

20080548

1. Applicant (please print or type):  
Name Cambria Corp  
Street 76 Reservoir 2 - Bentis  
P.O. Box 713  
City and State Great Bend, Ks.  
Zip Code 67530 Telephone No. \_\_\_\_\_  
Social Security I.D. No. \_\_\_\_\_  
and/or Taxpayer I.D. No. \_\_\_\_\_

6. Location of place of use:  
\_\_\_\_\_  
SW/SE/NW  
33-22-11  
Stafford County

2. Location of Point of Diversion:  
Sec. 33, Twp. 22, Rng. 11, (W),  
Stafford County, Kansas.

7. Period of use (6 months maximum):  
Commencing date: Dec 24, 2008  
Ending date: June 23, 2009

Distance from Southeast Corner of Section:  
2970 feet North from Southeast Corner  
3630 feet West from Southeast Corner

8. Location of the proposed point of diversion shall be indicated on the diagram below. Use the center section.  
If surface water, indicate on the diagram the course of the stream, and its name.

Existing water right? Yes  No   
If yes, File No. \_\_\_\_\_

The scale of the diagram is 2 inches = 1 mile  
Each small square represents 10 acres

Pending application? Yes  No   
If yes, File No. \_\_\_\_\_

3. Water Use Data:  
Proposed Max. Pumping Rate (gpm) 50 GPM  
Amount Requested (gallons) 1/2 million  
(not to exceed one million gallons unless for dewatering)  
Depth of Well (feet) 90 ft OR  
Name of Stream \_\_\_\_\_

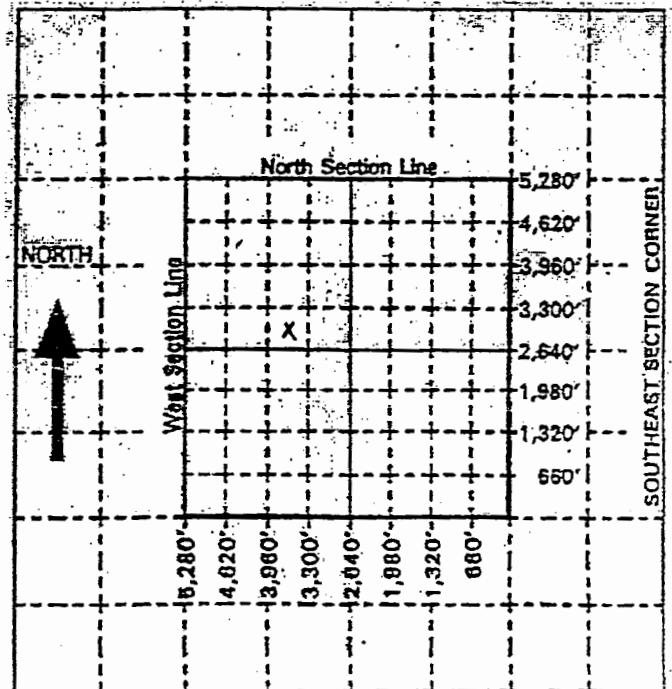

4. Name, address and phone number of the owner of land upon which point of diversion is located:  
Bandy Fritzsche - 2802  
S. Salt Marsh Rd. Stafford, Ks 67575  
If other than applicant, submit statement showing owner's permission to install diversion works has been obtained (attach if applicable).  
With oil lease

5. Water is to be used for (briefly describe proposed use):  
\_\_\_\_\_  
drilling oil well

For Office Use Only: Code TMP Fee \$ 200 TR # \_\_\_\_\_ Receipt Date 12-17-08 Check # 1148

RECEIVED

MAY 29 2009

BUREAU OF WATER