

WATER WELL RECORD

Form WWC-5

Division of Water Resources App. No.

1 LOCATION OF WATER WELL: County: Pawnee Fraction 1/4 1/4 NC 1/4 NE 1/4 Section Number 1 Township No. T 22 S Range Number R 15 [] E [X] W

Street/Rural Address of Well Location; if unknown, distance & direction from nearest town or intersection: If at owner's address, check here []. 1/4 South, 1 West of Radium Global Positioning System (GPS) information: Latitude: Longitude: Elevation: Datum: [] WGS 84, [] NAD 83, [] NAD 27 Collection Method: [] GPS unit (Make/Model:) [] Digital Map/Photo, [] Topographic Map, [] Land Survey Est. Accuracy: [] <3 m, [] 3-5 m, [] 5-15 m, [] >15 m

2 WATER WELL OWNER: Alan Crane RR#, Street Address, Box #: 1191 30th Avenue City, State, ZIP Code : Larned, KS 67550

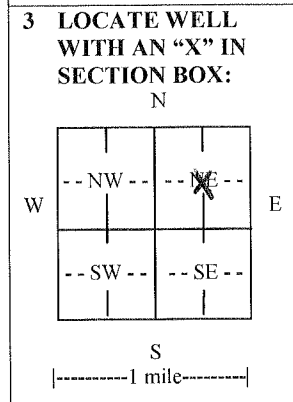

4 DEPTH OF COMPLETED WELL 205 ft. Depth(s) Groundwater Encountered (1) 42 ft. (2) 62 ft. (3) 906 ft. WELL'S STATIC WATER LEVEL 42 ft. below land surface measured on mo/day/yr. 4-26-14 Pump test data: Well water was 62 ft. after 3 hours pumping 906 gpm EST. YIELD 1149 gpm. Well water was 66 ft. after 3 1/2 hours pumping 1149 gpm Bore Hole Diameter 30 in. to 205 ft., and in. to ft. WELL WATER TO BE USED AS: [] Public water supply [] Geothermal [] Injection well [] Domestic [] Feedlot [] Oil field water supply [] Dewatering [] Other (Specify below) [X] Irrigation [] Industrial [] Domestic-lawn & garden [] Monitoring well Was a chemical/bacteriological sample submitted to Department? [] Yes [X] No If yes, mo/day/yr sample was submitted. Water well disinfected? [X] Yes [] No

5 TYPE OF CASING USED: [] Steel [X] PVC [] Other CASING JOINTS: [X] Glued [] Clamped [] Welded [] Threaded Casing diameter .16 in. to 205 ft., Diameter in. to ft., Diameter in. to ft. Casing height above land surface .18 in., Weight Sch. 40 lbs./ft., Wall thickness or gauge No. TYPE OF SCREEN OR PERFORATION MATERIAL: [] Steel [] Stainless Steel [X] PVC [] Other (Specify) [] Brass [] Galvanized Steel [] None used (open hole) SCREEN OR PERFORATION OPENINGS ARE: [] Continuous slot [] Mill slot [] Gauze wrapped [] Torch cut [] Drilled holes [] None (open hole) [] Louvered shutter [] Key punched [] Wire wrapped [X] Saw cut [] Other (specify) SCREEN-PERFORATED INTERVALS: From 205 ft. to 90 ft., From ft. to ft. GRAVEL PACK INTERVALS: From 205 ft. to 20 ft., From ft. to ft. From ft. to ft. From ft. to ft.

6 GROUT MATERIAL: [] Neat cement [] Cement grout [X] Bentonite [] Other Grout Intervals: From ft. to ft., From 20 ft. to 0 ft., From ft. to ft. What is the nearest source of possible contamination: [] Septic tank [] Lateral lines [] Pit privy [] Livestock pens [] Insecticide storage [X] Other (specify below) [] Sewer lines [] Cesspool [] Sewage lagoon [] Fuel storage [] Abandoned water well [] Watertight sewer lines [] Seepage pit [] Feedyard [] Fertilizer storage [] Oil well/gas well None Direction from well Distance from well

Table with 6 columns: FROM, TO, LITHOLOGIC LOG, FROM, TO, LITHO. LOG (cont.) or PLUGGING INTERVALS. Rows include: 0-9 Fine sand, 9-12 Sandy tan clay, 12-25 Fine sand & sandy clay, 25-81 Sand & gravel- clean, med, loose, 81-86 Tan & gray clay, 86-92 Sandy clay & sand, 92-105 Sand & gravel- clean, med, loose, 105-129 Soft tan clay, 129-135 Sand, 135-139 Tan clay.

7 CONTRACTOR'S OR LANDOWNER'S CERTIFICATION: This water well was [X] constructed, [] reconstructed, or [] plugged under my jurisdiction and was completed on (mo/day/year) 4-30-14 and this record is true to the best of my knowledge and belief. Kansas Water Well Contractor's License No. 134 This Water Well Record was completed on (mo/day/year) 5-15-14 under the business name of Rosencrantz- Bemis Ent Inc by (signature) Nora Alejo

INSTRUCTIONS: Use typewriter or ball point pen. PLEASE PRESS FIRMLY and PRINT clearly. Please fill in blanks and check the correct answers. Send three copies (white, blue, pink) to Kansas Department of Health and Environment, Bureau of Water, Geology Section, 1000 SW Jackson St., Suite 420, Topeka, Kansas 66612-1367. Telephone 785-296-5524. Send one copy to WATER WELL OWNER and retain one for your records. Include fee of \$5.00 for each constructed well. Visit us at http://www.kdheks.gov/waterwell/index.html.