

WATER WELL RECORD

Form WWC-5

Division of Water Resources App. No.

1 LOCATION OF WATER WELL: County: Hodgeman	Fraction 1/4 SE 1/4 NE 1/4 NE 1/4	Section Number 34	Township No. T 22 S	Range Number R 21 <input type="checkbox"/> E <input checked="" type="checkbox"/> W
---	---	-----------------------------	-------------------------------	--

Street/Rural Address of Well Location; if unknown, distance & direction from nearest town or intersection: If at owner's address, check here
From Burdett. West 5 miles on Hwy 156 to 234 Rd. South 4.4 miles to N. Rd. South another 1/2 mile. West side.

Global Positioning System (GPS) information:
 Latitude: **38.099572** (in decimal degrees)
 Longitude: **-99.60736** (in decimal degrees)
 Elevation: **unknown**
 Datum: WGS 84, NAD 83, NAD 27
 Collection Method:
 GPS unit (Make/Model: **WAAS**)
 Digital Map/Photo, Topographic Map, Land Survey
 Est. Accuracy: <3 m, 3-5 m, 5-15 m, >15 m

2 WATER WELL OWNER: **Carol Morey**
 RR#, Street Address, Box #: **5005 W Ave.**
 City, State, ZIP Code : **San Antonio, TX 67876**

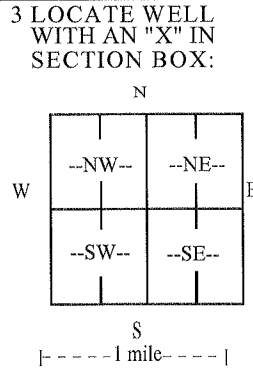

4 DEPTH OF COMPLETED WELL **108** ft.
 Depth(s) Groundwater Encountered (1) _____ ft. (2) _____ ft. (3) _____ ft.
 WELL'S STATIC WATER LEVEL **65.60** ft. below land surface measured on mo/day/yr **8/4/11**
 Pump test data: Well water was _____ ft. after _____ hours pumping _____ gpm
 EST. YIELD _____ gpm. Well water was _____ ft. after _____ hours pumping _____ gpm
 Bore Hole Diameter **8 3/4** in. to **108** ft., and _____ in. to _____ ft.
 WELL WATER TO BE USED AS: Public water supply Geothermal Injection well
 Domestic Feedlot Oil field water supply Dewatering Other (Specify below) **Stock Well**
 Irrigation Industrial Domestic-lawn & garden Monitoring well
 Was a chemical/bacteriological sample submitted to Department? Yes No
 If yes, mo/day/yr sample was submitted _____
 Water well disinfected? Yes No

5 TYPE OF CASING USED: Steel PVC Other _____
 CASING JOINTS: Glued Clamped Welded Threaded
 Casing diameter **5** in. to **76** ft., Diameter _____ in. to _____ ft., Diameter _____ in. to _____ ft.
 Casing height above land surface **24** in., Weight **2.36** lbs./ft., Wall thickness or gauge No. **.214**
 TYPE OF SCREEN OR PERFORATION MATERIAL:
 Steel Stainless Steel PVC Other (Specify) _____
 Brass Galvanized Steel None used (open hole)
 SCREEN OR PERFORATION OPENINGS ARE:
 Continuous slot Mill slot Gauze wrapped Torch cut Drilled holes None (open hole)
 Louvered shutter Key punched Wire wrapped Saw cut Other (specify) _____
 SCREEN-PERFORATED INTERVALS: From **76** ft. to **106** ft., From _____ ft. to _____ ft.
 From _____ ft. to _____ ft., From _____ ft. to _____ ft.
 GRAVEL PACK INTERVALS: From **22** ft. to **108** ft., From _____ ft. to _____ ft.
 From _____ ft. to _____ ft., From _____ ft. to _____ ft.

6 GROUT MATERIAL: Neat cement Cement grout Bentonite Other _____
 Grout Intervals: From _____ ft. to _____ ft., From **0** ft. to **22** ft., From _____ ft. to _____ ft.
 What is the nearest source of possible contamination:
 Septic tank Lateral lines Pit privy Livestock pens Insecticide storage Other (specify below) **Old Well**
 Sewer lines Cesspool Sewage lagoon Fuel storage Abandoned water well
 Watertight sewer lines Seepage pit Feedyard Fertilizer storage Oil well/gas well
 Direction from well _____ Distance from well _____

FROM	TO	LITHOLOGIC LOG	FROM	TO	LITHO. LOG (cont.) or PLUGGING INTERVALS
0	3	Topsoil	71	75	Clay, light gray
3	15	Clay, tan, caliche	75	77	Clay, gray, sandstone streaks
15	17	Clay, tan, broken limestone, caliche	77	85	Clay, gray, white, sandstone streaks
17	44	Clay, gray, black	85	86	Sandstone
44	54	Clay, light gray, some sandstone streaks	86	91	Clay, gray, sandstone streaks
54	57	Clay, dark gray	91	96	Sandstone
57	64	Clay, light gray	96	106	Sandstone, clay, gray
64	67	Clay, dark gray	106	108	Clay, gray
67	69	Clay, light gray			
69	71	Clay, red, gray, yellow			

7 CONTRACTOR'S OR LANDOWNER'S CERTIFICATION: This water well was constructed, reconstructed, or plugged under my jurisdiction and was completed on (mo/day/year) **8/4/11** and this record is true to the best of my knowledge and belief.
 Kansas Water Well Contractor's License No. **185** This Water Well Record was completed on (mo/day/year) **8/10/11**
 under the business name of **Clarke Well & Equipment, Inc.** by (signature) *[Signature]*

INSTRUCTIONS: Use typewriter or ball point pen. **PLEASE PRESS FIRMLY** and **PRINT** clearly. Please fill in blanks and check the correct answers. Send three copies (white, blue, pink) to Kansas Department of Health and Environment, Bureau of Water, Geology Section, 1000 SW Jackson St., Suite 420, Topeka, Kansas 66612-1367. Telephone 785-296-5522. Send one copy to WATER WELL OWNER and retain one for your records. Include fee of \$5.00 for each constructed well. Visit us at <http://www.kdheks.gov/waterwell/index.html>.