

1 LOCATION OF WATER WELL: Fraction SW 1/4 NE SW 1/4 Section Number 110 Township Number T 22 S Range Number 04 E W
 County: Reno

Street/Rural Address of Well Location; if unknown, distance & direction from nearest town or intersection: If at owner's address, check here Yes

Global Positioning Systems (GPS) information:
 Latitude: 38.134455 (in decimal degrees)
 Longitude: -97.770048 (in decimal degrees)
 Elevation: _____
 Datum: WGS84, NAD83, NAD27
 Collection Method: _____

2 WATER WELL OWNER: Ken Hamby
 RR#, St. Address, Box #: 9509 W. Willson Rd
 City, State ZIP Code: Buhler, KS 67522
 Est. Accuracy: < 3 m. 3-5 m. 5-15 m. > 15 m

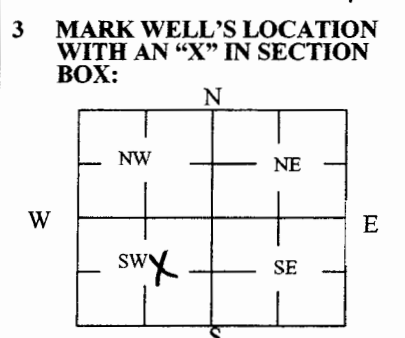

4 DEPTH OF WELL 250 ft.
 WELL'S STATIC WATER LEVEL N/A ft.
 WELL WAS USED AS:
 Domestic Public Water Supply Dewatering
 Irrigation Oil Field Water Supply Monitoring
 Feedlot Domestic (Lawn & Garden) Injection Well
 Industrial Air Conditioning Other Geothermal
 Was a chemical/bacteriological sample submitted to Department? Yes No

5 TYPE OF BLANK CASING USED:
 Steel RMP (SR) Wrought Fiberglass Other (Specify below) _____
 PVC ABS Asbestos-Cement Concrete Tile
 Blank casing diameter _____ in. Was casing pulled? Yes No If yes, how much _____
 Casing height above or below land surface _____ in.

6 GROUT PLUG MATERIAL: Neat cement Cement grout Bentonite Other _____
 Grout Plug Intervals: From 0 ft. to 250 ft., From _____ ft. to _____ ft., From _____ to _____ ft.
 What is the nearest source of possible contamination:
 Septic tank Seepage pit Fuel Storage Other (specify below) House
 Sewer lines Pit privy Fertilizer storage
 Watertight sewer lines Sewage lagoon Insecticide storage
 Lateral lines Feedyard Abandoned water well
 Cess pool Livestock pens Oil well/Gas well
 Direction from well? NE
 How many feet? 40

FROM	TO	PLUGGING MATERIALS	FROM	TO	PLUGGING MATERIALS
0	15	Red Clay			
15	35	Gray Sand			
35	120	yellow clay			
120	250	Red shale			

7 CONTRACTOR'S OR LANDOWNER'S CERTIFICATION: This water well was plugged under my jurisdiction and was completed on (mo/day/year) 4/16/10 and this record is true to the best of my knowledge and belief. Kansas Water Well Contractor's License No. 512. This Water Well Record was completed on (mo/day/year) 4/20/10 under the business name of Environmental Exp Service, Inc by (signature) Richard Moore

INSTRUCTIONS: Use typewriter or ballpoint pen. Please press firmly and print clearly. Please fill in blanks, underline or circle the correct answers. Send top three copies to Kansas Department of Health and Environment, Bureau of Water, Geology Section, 1000 SW Jackson St., Ste. 420, Topeka, Kansas 66612-1367. Telephone: 785/296-5524. Send one to Water Well Owner and retain one for your records. Visit us at <http://www.kdheks.gov/waterwell/index.html>.

Drilled 3 @ 250' Check one: White Copy Blue Copy Pink Copy