

WATER WELL RECORD

Form WWC-5

Division of Water Resources App. No.

48,198

1 LOCATION OF WATER WELL: County: Reno Fraction SE 1/4 NE 1/4 SW 1/4 NE 1/4 Section Number 19 Township No. T 22 S Range Number R 4 [] E [x] W

Street/Rural Address of Well Location; if unknown, distance & direction from nearest town or intersection: 1 mile South & 1 mile West of Buhler, Ks Global Positioning System (GPS) information: Latitude: 38.12584 Longitude: 97.79829 Elevation: 1466

2 WATER WELL OWNER: Brad Rayl RR#, Street Address, Box #: 6511 N. Willison Rd. City, State, ZIP Code : Buhler, Ks. 67522 Collection Method: [] GPS unit [] Digital Map/Photo [] Topographic Map [] Land Survey Est. Accuracy: [] <3 m [] 3-5 m [] 5-15 m [] >15 m

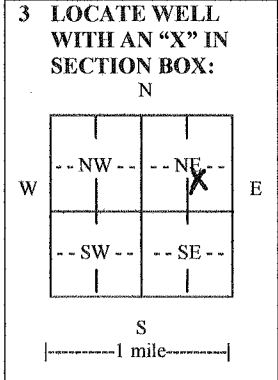

3 LOCATE WELL WITH AN "X" IN SECTION BOX: 4 DEPTH OF COMPLETED WELL 90 ft. MIDDLE WELL Depth(s) Groundwater Encountered (1) 11 ft. (2) 11 ft. (3) 11 ft. WELL'S STATIC WATER LEVEL 11 ft. below land surface measured on mo/day/yr. 7/21/2014 EST. YIELD 200 gpm. Pump test data: Well water was 20 ft. after 93 hours pumping 200 gpm. Bore Hole Diameter 20 in. to 93 ft., and 93 in. to 93 ft. WELL WATER TO BE USED AS: [x] Irrigation [] Industrial [] Domestic-lawn & garden [] Monitoring well

5 TYPE OF CASING USED: [x] Steel [x] PVC [] Other CASING JOINTS: [x] Glued [] Clamped [] Welded [] Threaded Casing diameter 8 in. to 50 ft., Diameter 50 in. to 50 ft., Diameter 50 in. to 50 ft. Casing height above land surface 12 in., Weight 5.72 lbs./ft., Wall thickness or gauge No. 0.332

TYPE OF SCREEN OR PERFORATION MATERIAL: [x] Steel [] Stainless Steel [x] PVC [] Other (Specify) [] Brass [] Galvanized Steel [] None used (open hole) SCREEN OR PERFORATION OPENINGS ARE: [x] Continuous slot [x] Mill slot [] Gauze wrapped [] Torch cut [] Drilled holes [] None (open hole) [] Louvered shutter [] Key punched [] Wire wrapped [] Saw cut [] Other (specify) SCREEN-PERFORATED INTERVALS: From 50 ft. to 90 ft., From 50 ft. to 90 ft., From 50 ft. to 90 ft. GRAVEL PACK INTERVALS: From 26 ft. to 90 ft., From 26 ft. to 90 ft., From 26 ft. to 90 ft.

6 GROUT MATERIAL: [] Neat cement [x] Cement grout [] Bentonite [] Other Grout Intervals: From 1 ft. to 26 ft., From 1 ft. to 26 ft., From 1 ft. to 26 ft. What is the nearest source of possible contamination: [] Septic tank [] Lateral lines [] Pit privy [] Livestock pens [] Insecticide storage [] Other (specify below) [] Sewer lines [] Cesspool [] Sewage lagoon [] Fuel storage [] Abandoned water well [] Watertight sewer lines [] Seepage pit [] Feedyard [] Fertilizer storage [] Oil well/gas well Direction from well None within 1/4 mile Distance from well

Table with 6 columns: FROM, TO, LITHOLOGIC LOG, FROM, TO, LITHO. LOG (cont.) or PLUGGING INTERVALS. Rows describe soil layers from 0 to 90 feet depth: Topsoil, Clay, brown/sandy, Sand, very fine, gray, Clay, tan, sandy, Clay, gray w/sand layers, Sand, very fine/gray, Sand, fine, gray, Sand, fine to coarse w/gravel & clay, Cemented sand and lime, Shale, gray.

7 CONTRACTOR'S OR LANDOWNER'S CERTIFICATION: This water well was [x] constructed, [] reconstructed, or [] plugged under my jurisdiction and was completed on (mo/day/year) 7/21/2014 and this record is true to the best of my knowledge and belief. Kansas Water Well Contractor's License No. 138 This Water Well Record was completed on (mo/day/year) 7/28/2014 under the business name of Peterson Irrigation, Inc. by (signature) Mike Peters

INSTRUCTIONS: Use typewriter or ball point pen. PLEASE PRESS FIRMLY and PRINT clearly. Please fill in blanks and check the correct answers. Send one copy to Kansas Department of Health and Environment, Bureau of Water, Geology Section, 1000 SW Jackson St., Suite 420, Topeka, Kansas 66612-1367. Telephone 785-296-5524. Send one copy to WATER WELL OWNER and retain one for your records. Include fee of \$5.00 for each constructed well. Visit us at