

#3 Westwell

WATER WELL RECORD

Form WWC-5

Division of Water Resources App. No.

1 LOCATION OF WATER WELL: County: Reno Fraction NW 1/4 SW 1/4 SE 1/4 SW 1/4 Section Number 8 Township No. T 22 S Range Number R 5 [ ] E [x] W

Street/Rural Address of Well Location; if unknown, distance & direction from nearest town or intersection: If at owner's address, check here [ ]. From 95th & Lorraine 1S 1/4E in field. ESR Global Positioning System (GPS) information: Latitude: .38.14637 Longitude: 097.89806 Elevation: 1567 Datum: [ ] WGS 84, [ ] NAD 83, [x] NAD 27 Collection Method: [x] GPS unit (Make/Model: Garmin 62S) [ ] Digital Map/Photo, [x] Topographic Map, [ ] Land Survey Est. Accuracy: [ ] <3 m, [x] 3-5 m, [ ] 5-15 m, [ ] >15 m

2 WATER WELL OWNER: Larry Froese RR#, Street Address, Box #: 1226 Cherokee Rd. City, State, ZIP Code : Inman, Kansas 67546

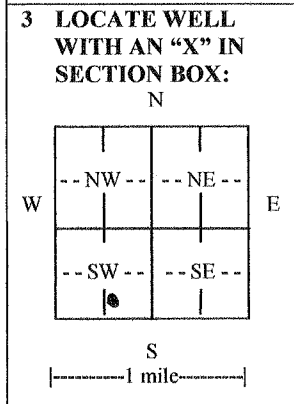

3 LOCATE WELL WITH AN "X" IN SECTION BOX: N W E S |-----1 mile-----| 4 DEPTH OF COMPLETED WELL .77 ft. Depth(s) Groundwater Encountered (1)..... ft. (2)..... ft. (3)..... ft. WELL'S STATIC WATER LEVEL .9 ft. below land surface measured on mo/day/yr. 2/20/2015 Pump test data: Well water was.....ft. after..... hours pumping..... gpm EST. YIELD.....gpm. Well water was.....ft. after..... hours pumping..... gpm Bore Hole Diameter 10.....in. to .77.....ft., and .....in. to .....ft. WELL WATER TO BE USED AS: [ ] Public water supply [ ] Geothermal [ ] Injection well [ ] Domestic [ ] Feedlot [ ] Oil field water supply [ ] Dewatering [x] Other (Specify below) [ ] Irrigation [ ] Industrial [ ] Domestic-lawn & garden [ ] Monitoring well Stock Was a chemical/bacteriological sample submitted to Department? [ ] Yes [x] No If yes, mo/day/yr sample was submitted..... Water well disinfected? [x] Yes [ ] No

5 TYPE OF CASING USED: [ ] Steel [x] PVC [ ] Other CASING JOINTS: [x] Glued [ ] Clamped [ ] Welded [ ] Threaded Casing diameter .5..... in. to .57..... ft., Diameter ..... in. to ..... ft., Diameter ..... in. to ..... ft. Casing height above land surface .16..... in., Weight .160.....lbs./ft., Wall thickness or gauge No. .214 TYPE OF SCREEN OR PERFORATION MATERIAL: [ ] Steel [ ] Stainless Steel [x] PVC [ ] Other (Specify) [ ] Brass [ ] Galvanized Steel [ ] None used (open hole) SCREEN OR PERFORATION OPENINGS ARE: [ ] Continuous slot [ ] Mill slot [ ] Gauze wrapped [ ] Torch cut [ ] Drilled holes [ ] None (open hole) [ ] Louvered shutter [ ] Key punched [ ] Wire wrapped [x] Saw cut [ ] Other (specify) SCREEN-PERFORATED INTERVALS: From .57..... ft. to .77..... ft., From ..... ft. to ..... ft. From ..... ft. to ..... ft. GRAVEL PACK INTERVALS: From .77..... ft. to .20..... ft., From ..... ft. to ..... ft. From ..... ft. to ..... ft.

6 GROUT MATERIAL: [ ] Neat cement [ ] Cement grout [x] Bentonite [ ] Other Grout Intervals: From .20..... ft. to .0..... ft., From ..... ft. to ..... ft., From ..... ft. to ..... ft. What is the nearest source of possible contamination: [ ] Septic tank [ ] Lateral lines [ ] Pit privy [ ] Livestock pens [ ] Insecticide storage [x] Other (specify below) [ ] Sewer lines [ ] Cesspool [ ] Sewage lagoon [ ] Fuel storage [ ] Abandoned water well [ ] Watertight sewer lines [ ] Seepage pit [ ] Feedyard [ ] Fertilizer storage [ ] Oil well/gas well N/A Direction from well ..... Distance from well .....

FROM	TO	LITHOLOGIC LOG	FROM	TO	LITHO. LOG (cont.) or PLUGGING INTERVAL
0	5	Sandy top soil			
5	70	Tan clay w/strks. of fine sand			
70	76	Tan clay & caliche			
76	77	Hard layer of caliche			

7 CONTRACTOR'S OR LANDOWNER'S CERTIFICATION: This water well was [x] constructed, [ ] reconstructed, or [ ] plugged under my jurisdiction and was completed on (mo/day/year) 2/20/2015 and this record is true to the best of my knowledge and belief. Kansas Water Well Contractor's License No. 134 This Water Well Record was completed on (mo/day/year) 2/23/2015 under the business name of Rozencrantz-Bemis Ent. by (signature) [Signature]

INSTRUCTIONS: Use typewriter or ball point pen. PLEASE PRESS FIRMLY and PRINT clearly. Please fill in blanks and check the correct answers. Send three copies (white, blue, pink) to Kansas Department of Health and Environment, Bureau of Water, Geology Section, 1000 SW Jackson St., Suite 420, Topeka, Kansas 66612-13 Telephone 785-296-5524. Send one copy to WATER WELL OWNER and retain one for your records. Include fee of \$5.00 for each constructed well. Visit us at http://www.kdheks.gov/waterwell/index.html.