

1 LOCATION OF WATER WELL:		Fraction	Section Number	Township Number	Range Number
County: Stafford		NE 1/4 NE 1/4 NW 1/4	12	T 23 S	R 12 E
Distance and direction from nearest town or city street address of well if located within city? 3 1/2 mi E., 2 mi S of Hudson					
2 WATER WELL OWNER: KGS/GWMD#5					
RR#, St. Address, Box # :			Board of Agriculture, Division of Water Resources		
City, State, ZIP Code :			Application Number:		
3 LOCATE WELL'S LOCATION WITH AN "X" IN SECTION BOX:		4 DEPTH OF COMPLETED WELL: 110 ft. ELEVATION: 1827			
<div style="text-align: center;"><p>1 Mile</p></div>		Depth(s) Groundwater Encountered 1. ft. 2. ft. 3. ft.			
		WELL'S STATIC WATER LEVEL 9.51 ft. below land surface measured on mo/day/yr 3/14/1979			
		Pump test data: Well water was ft. after hours pumping gpm			
		Est. Yield gpm: Well water was ft. after hours pumping gpm			
		Bore Hole Diameter 8 in. to 110 ft. and in. to ft.			
WELL WATER TO BE USED AS:		5 Public water supply 8 Air conditioning 11 Injection well			
1 Domestic 3 Feedlot 6 Oil field water supply 9 Dewatering 12 Other (Specify below)					
2 Irrigation 4 Industrial 7 Lawn and garden only 10 Observation well					
Was a chemical/bacteriological sample submitted to Department? Yes. No ; If yes, mo/day/yr sample was submitted					
Water Well Disinfected? Yes No					
5 TYPE OF BLANK CASING USED:					
1 Steel 3 RMP (SR)		5 Wrought iron 8 Concrete tile		CASING JOINTS: Slued Clamped	
2 PVC 4 ABS		6 Asbestos-Cement 9 Other (specify below)		Welded	
		7 Fiberglass		Threaded	
Blank casing diameter 5 in. to 106 ft., Dia in. to ft., Dia in. to ft.					
Casing height above land surface 30 in., weight lbs./ft. Wall thickness or gauge No. SCHD 40					
TYPE OF SCREEN OR PERFORATION MATERIAL:					
1 Steel 3 Stainless steel 5 Fiberglass		7 PVC 10 Asbestos-cement			
2 Brass 4 Galvanized steel 6 Concrete tile		8 RMP (SR) 11 Other (specify)			
		9 ABS 12 None used (open hole)			
SCREEN OR PERFORATION OPENINGS ARE:					
1 Continuous slot 3 Mill slot		5 Gauzed wrapped 8 Saw cut 11 None (open hole)			
2 Louvered shutter 4 Key punched		6 Wire wrapped 9 Drilled holes			
		7 Torch cut 10 Other (specify)			
SCREEN-PERFORATED INTERVALS: From 106 ft. to 110 ft., From ft. to ft.					
From ft. to ft., From ft. to ft.					
GRAVEL PACK INTERVALS: From ft. to ft., From ft. to ft.					
From ft. to ft., From ft. to ft.					
6 GROUT MATERIAL: 1 Neat cement 2 Cement grout 3 Bentonite 4 Other					
Grout Intervals: From 106 ft. to 20 ft., From 0 ft. to 10 ft., From ft. to ft.					
What is the nearest source of possible contamination:					
1 Septic tank 4 Lateral lines 7 Pit privy		10 Livestock pens 14 Abandoned water well			
2 Sewer lines 5 Cess pool 8 Sewage lagoon		11 Fuel storage 15 Oil well/Gas well			
3 Watertight sewer lines 6 Seepage pit 9 Feedyard		12 Fertilizer storage 16 Other (specify below)			
		13 Insecticide storage			
Direction from well? How many feet?					
FROM	TO	LITHOLOGIC LOG	FROM	TO	LITHOLOGIC LOG
		see log from Site #1(1)			
		02			
		02			
		02			
		17			
		08			
		11			
		35			
		35			
		35			
		35			
		35			
		19			
7 CONTRACTOR'S OR LANDOWNER'S CERTIFICATION: This water well was (1) constructed, (2) reconstructed, or (3) plugged under my jurisdiction and was completed on (mo/day/year) June 6, 1978 and this record is true to the best of my knowledge and belief. Kansas Water Well Contractor's License No. This Water Well Record was completed on (mo/day/yr) 3/30/83 under the business name of by (signature) Patricia M. Cobb					
INSTRUCTIONS: Use typewriter or ball point pen, <u>PLEASE PRESS FIRMLY</u> and <u>PRINT</u> clearly. Please fill in blanks, underline or circle the correct answers. Send top three copies to Kansas Department of Health and Environment, Division of Environment, Environmental Geology Section, Topeka, KS 66620. Send one to WATER WELL OWNER and retain one for your records.					

BIG BEND GMD#5-KGS
WATER QUALITY
OBSERVATION WELL
NETWORK

SITE NUMBER : 1	LEGAL LOCATION : 12-23-12W
SITE LOCATION: NE NE NW	COUNTY : STAFFORD
SAMPLING DATE: OCTOBER 1978	NUMBER OF WELLS: 3

WATER QUALITY ANALYSIS (mg./l)

	<u>WELL#1</u>	<u>WELL#2</u>	<u>WELL#3</u>	<u>WELL#4</u>
TEMPERATURE, C	<u>15.3</u>	<u>15.0</u>	<u>14.3</u>	<u> </u>
SPECIFIC CONDUCTANCE umho @ 25 deg C.	<u>33,600</u>	<u>6700</u>	<u>397</u>	<u> </u>
pH	<u>7.2</u>	<u>7.4</u>	<u>7.6</u>	<u> </u>
CALCIUM (Ca):	<u>390</u>	<u>103</u>	<u>59</u>	<u> </u>
MAGNESIUM (Mg):	<u>165</u>	<u>32</u>	<u>4.7</u>	<u> </u>
POTASSIUM (K):	<u>14</u>	<u>4.6</u>	<u>2.5</u>	<u> </u>
SILICA (SiO ₂):	<u>22</u>	<u>21</u>	<u>19</u>	<u> </u>
SODIUM (Na):	<u>8974</u>	<u>1387</u>	<u>18</u>	<u> </u>
SAR:	<u>96</u>	<u>31</u>	<u>0.61</u>	<u> </u>
BICARBONATE (HCO ₃):	<u>202</u>	<u>223</u>	<u>203</u>	<u> </u>
CHLORIDE (Cl):	<u>13,268</u>	<u>2060</u>	<u>12</u>	<u> </u>
FLUORIDE (F):	<u>0.6</u>	<u>0.4</u>	<u>0.5</u>	<u> </u>
NITRATE (NO ₃):	<u>15</u>	<u>19</u>	<u>18</u>	<u> </u>
ORTHO-PHOSPHATE (PO ₄):	<u>0.14</u>	<u>0.65</u>	<u>0.27</u>	<u> </u>
SULFATE (SO ₄):	<u>1693</u>	<u>234</u>	<u>9.7</u>	<u> </u>
SULFIDE (S):	<u> </u>	<u> </u>	<u> </u>	<u> </u>
STRONTIUM (Sr):	<u>7.1</u>	<u>1.3</u>	<u>0.2</u>	<u> </u>

LANDOWNER: ARTHUR BRINKMAN
ADDRESS : 401 SOUTH UNION
STAFFORD,KS. 67578
PHONE NO.: 316-234-5976

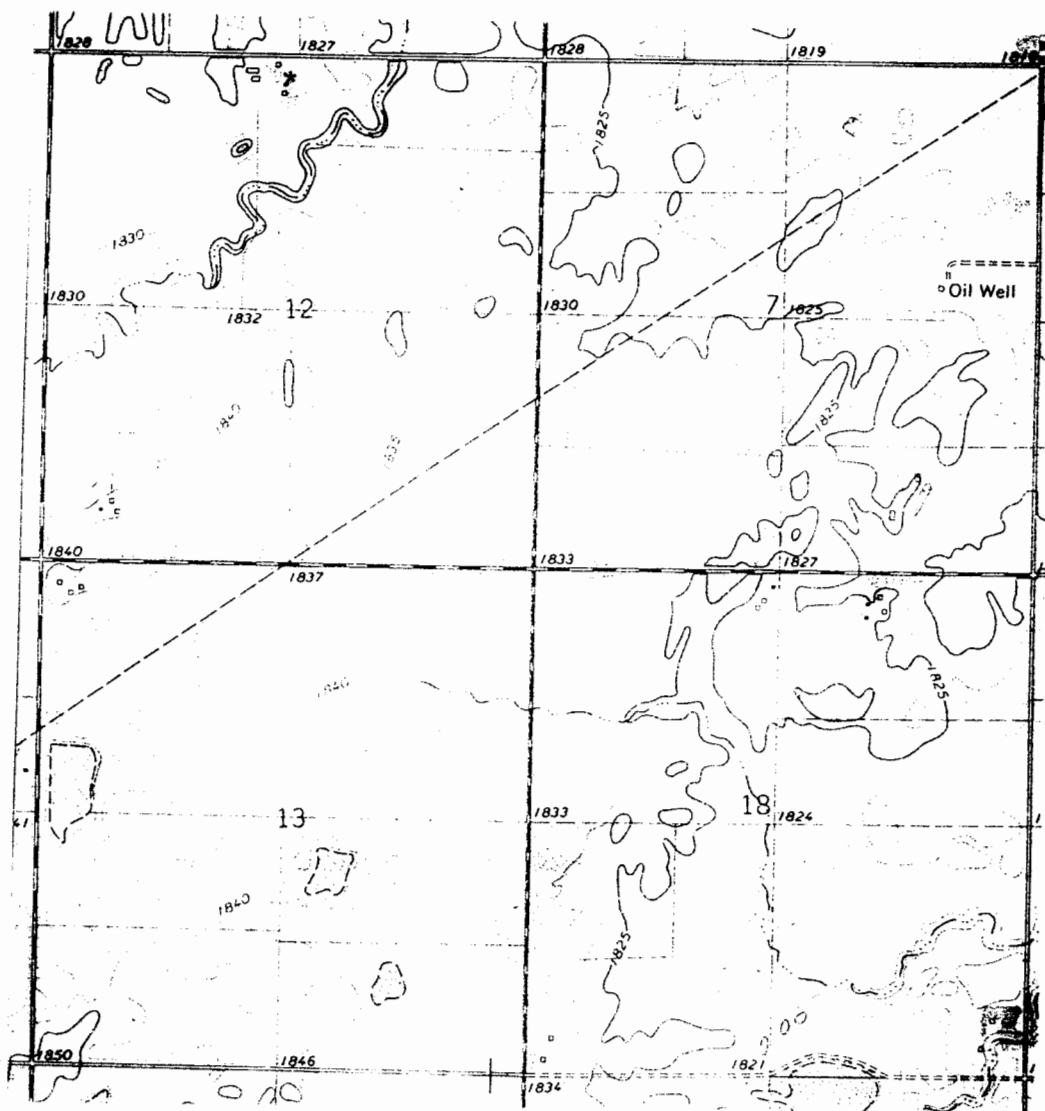

WELL LOCATION *