

1 LOCATION OF WATER WELL	Fraction	Section Number	Township Number	Range Number
County: Stafford	SW 1/4 SW 1/4 SE 1/4	36	T 23 S	R 13 E/W

Distance and direction from nearest town or city? **3 mi E of St. John**

Street address of well if located within city?

2 WATER WELL OWNER: **KGS/GWMD#5**

RR#, St. Address, Box # :
 City, State, ZIP Code : **St. John, Kansas 67576**

Board of Agriculture, Division of Water Resources
 Application Number:

3 DEPTH OF COMPLETED WELL: **75** ft. Bore Hole Diameter: **8** in. to **75** ft. and _____ in. to _____ ft.

Well Water to be used as:

1 Domestic	3 Feedlot	5 Public water supply	8 Air conditioning	11 Injection well
2 Irrigation	4 Industrial	6 Oil field water supply	9 Dewatering	12 Other (Specify below)
		7 Lawn and garden only	10 Observation well	Research

Well's static water level: **26.30** ft. below land surface measured on **October** month **15** day **1982** year

Pump Test Data: Well water was _____ ft. after _____ hours pumping. _____ gpm

Est. Yield: _____ gpm. Well water was _____ ft. after _____ hours pumping. _____ gpm

4 TYPE OF BLANK CASING USED:

1 Steel	3 RMP (SR)	5 Wrought iron	8 Concrete tile	Casing Joints: <input checked="" type="checkbox"/> Glued <input checked="" type="checkbox"/> Clamped
2 PVC	4 ABS	6 Asbestos-Cement	9 Other (specify below)	Welded _____
		7 Fiberglass		Threaded _____

Blank casing dia: **5** in. to **65** ft., Dia _____ in. to _____ ft., Dia _____ in. to _____ ft.

Casing height above land surface: **13 ft** weight _____ lbs./ft. Wall thickness or gauge No. **Schd 40**

TYPE OF SCREEN OR PERFORATION MATERIAL:

1 Steel	3 Stainless steel	5 Fiberglass	8 RMP (SR)	11 Other (specify) _____
2 Brass	4 Galvanized steel	6 Concrete tile	9 ABS	12 None used (open hole)

Screen or Perforation Openings Are:

1 Continuous slot	3 Mill slot	5 Gauzed wrapped	8 Saw cut	11 None (open hole)
2 Louvered shutter	4 Key punched	6 Wire wrapped	9 Drilled holes	
		7 Torch cut	10 Other (specify) _____	

Screen-Perforation Dia: **5** in. to **75** ft., Dia _____ in. to _____ ft., Dia _____ in. to _____ ft.

Screen-Perforated Intervals: From **65** ft. to **75** ft., From _____ ft. to _____ ft., From _____ ft. to _____ ft.

Gravel Pack Intervals: From **75** ft. to **60** ft., From _____ ft. to _____ ft., From _____ ft. to _____ ft.

5 GROUT MATERIAL: **1 Neat cement** 2 Cement grout 3 Bentonite 4 Other

Grouted Intervals: From **2** ft. to **1.5** ft., From _____ ft. to _____ ft., From _____ ft. to _____ ft.

What is the nearest source of possible contamination: **not determined**

1 Septic tank	4 Cess pool	7 Sewage lagoon	10 Fuel storage	14 Abandoned water well
2 Sewer lines	5 Seepage pit	8 Feed yard	11 Fertilizer storage	15 Oil well/Gas well
3 Lateral lines	6 Pit privy	9 Livestock pens	12 Insecticide storage	16 Other (specify below)

Direction from well _____ How many feet _____ ? Water Well Disinfected? Yes No

Was a chemical/bacteriological sample submitted to Department? Yes No If yes, date sample was submitted _____ month _____ day _____ year Pump Installed? Yes No

If Yes: Pump Manufacturer's name _____ Model No. _____ HP _____ Volts _____

Depth of Pump Intake _____ ft. Pumps Capacity rated at _____ gal./min.

Type of pump: 1 Submersible 2 Turbine 3 Jet 4 Centrifugal 5 Reciprocating 6 Other

6 CONTRACTOR'S OR LANDOWNER'S CERTIFICATION: This water well was **1** constructed, (2) reconstructed, or (3) plugged under my jurisdiction and was completed on **June** month **19** day **1978** year

and this record is true to the best of my knowledge and belief. Kansas Water Well Contractor's License No. _____

This Water Well Record was completed on **15** month **Nov** day **1982** year under the business name of _____ by (signature) **Patrick M Cobb**

LOCATE WELL'S LOCATION WITH AN "X" IN SECTION BOX:	FROM		TO		LITHOLOGIC LOG		LITHOLOGIC LOG		
	FROM	TO	FROM	TO	FROM	TO	FROM	TO	
	0	20			silt/clay, brownish gray to brown				
	20	25			brown silt, calcareous gray clay inclusions				
	25	31			same; some med. to very coarse sand				
	31	75			fine to coarse sand, fine gravel, pink clay				
					(abbreviatd log)				

ELEVATION: _____

Depth(s) Groundwater Encountered 1. _____ ft. 2. _____ ft. 3. _____ ft. 4. _____ ft. (Use a second sheet if needed)

INSTRUCTIONS: Use typewriter or ball point pen, please press firmly and PRINT clearly. Please fill in blanks, underline or circle the correct answers. Send top three copies to Kansas Department of Health and Environment, Division of Environment, Water Well Contractors, Topeka, KS 66620. Send one to WATER WELL OWNER and retain one for your records.

OFFICE USE ONLY

T

R

EW

SEC.

1/4

1/4

1/4

BIG BEND GMD#5-KGS
 WATER QUALITY
 OBSERVATION WELL
 NETWORK

SITE NUMBER : 3	LEGAL LOCATION : 36-23-13W
SITE LOCATION: SW SW SE	COUNTY : STAFFORD
SAMPLING DATE: OCTOBER 1978	NUMBER OF WELLS: 2

WATER QUALITY ANALYSIS (mg./l)

	<u>WELL#1</u>	<u>WELL#2</u>	<u>WELL#3</u>	<u>WELL#4</u>
TEMPERATURE, C	<u>15.3</u>	<u>15.2</u>	_____	_____
SPECIFIC CONDUCTANCE umho @ 25 deg C.	<u>1660</u>	<u>521</u>	_____	_____
pH	<u>7.0</u>	<u>7.1</u>	_____	_____
CALCIUM (Ca):	<u>76</u>	<u>60</u>	_____	_____
MAGNESIUM (Mg):	<u>12</u>	<u>5.4</u>	_____	_____
POTASSIUM (K):	<u>2.9</u>	<u>2.8</u>	_____	_____
SILICA (SiO ₂):	<u>20</u>	<u>16</u>	_____	_____
SODIUM (Na):	<u>252</u>	<u>40</u>	_____	_____
SAR:	<u>7.1</u>	<u>1.3</u>	_____	_____
BICARBONATE (HCO ₃):	<u>244</u>	<u>245</u>	_____	_____
CHLORIDE (Cl):	<u>382</u>	<u>36</u>	_____	_____
FLUORIDE (F):	<u>0.5</u>	<u>0.4</u>	_____	_____
NITRATE (NO ₃):	<u>0.1</u>	<u>0.2</u>	_____	_____
ORTHO-PHOSPHATE (PO ₄):	<u>0.16</u>	<u>0.51</u>	_____	_____
SULFATE(SO ₄):	<u>44</u>	<u>18</u>	_____	_____
SULFIDE (S):	_____	_____	_____	_____
STRONTIUM (Sr):	<u>0.6</u>	<u>0.3</u>	_____	_____

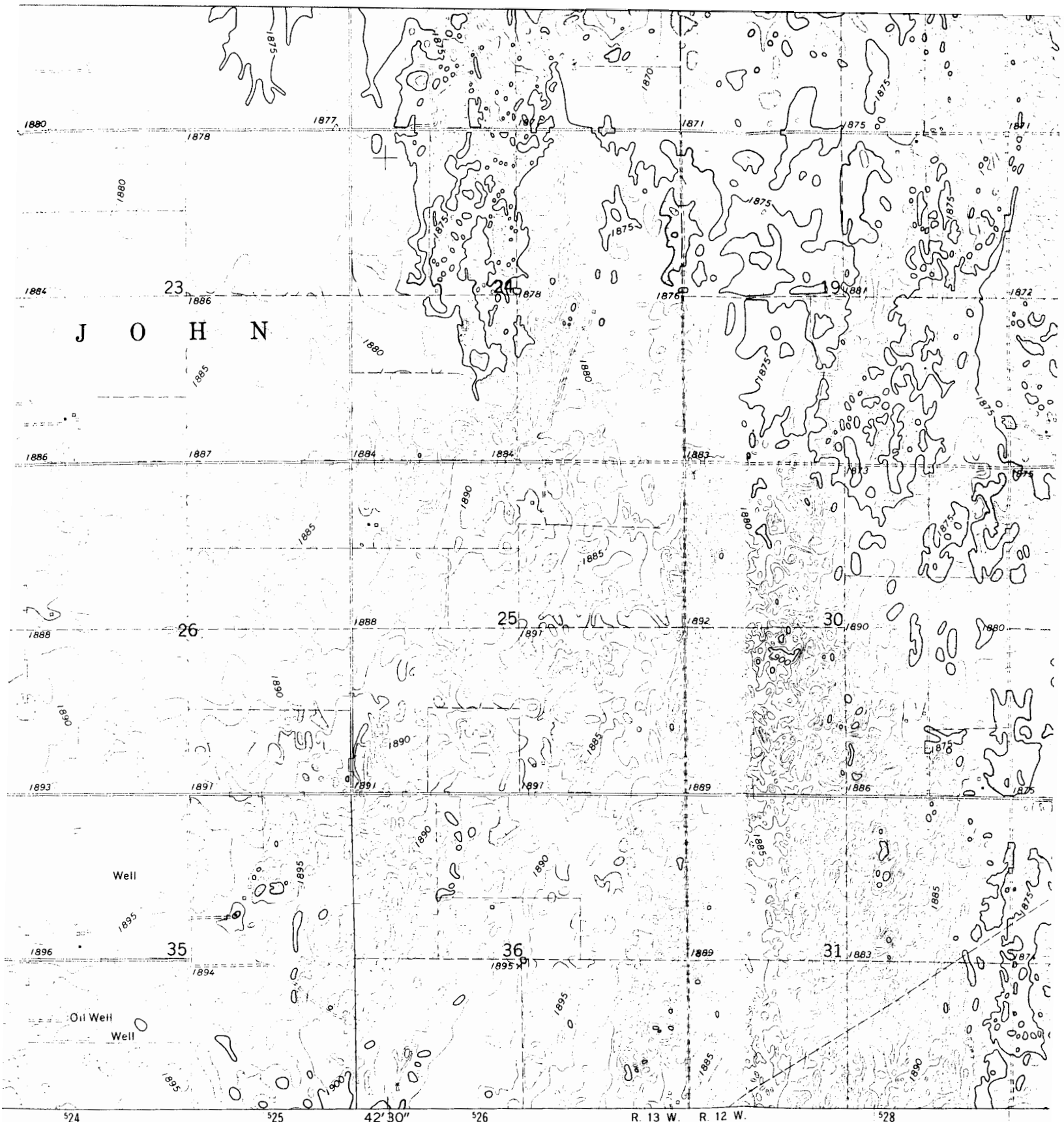

al Survey

SCALE 1:24 000

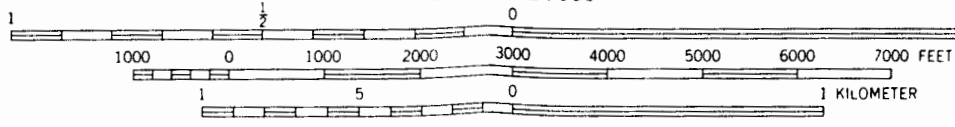

CONTOUR INTERVAL 5 FEET
DATUM IS MEAN SEA LEVEL

outh zone

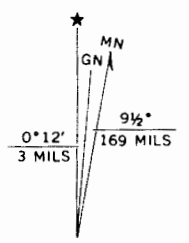

UTM GRID AND 1971 MAGNETIC NORTH DECLINATION AT CENTER OF SHEET

nes where
on is unchecked

THIS MAP COMPLIES WITH NATIONAL MAP ACCURACY STANDARDS
FOR SALE BY U. S. GEOLOGICAL SURVEY, DENVER, COLORADO 80225, OR WASHINGTON,
AND BY THE STATE GEOLOGICAL SURVEY, LAWRENCE, KANSAS 66044