

WATER WELL RECORD

Form WWC-5

Division of Water Resources App. No.

Well ID

MW13

Original Record Correction Change in Well Ust

1 LOCATION OF WATER WELL: County Hodgeman Fraction SW 1/4 NW 1/4 SE 1/4 NW 1/4 Section Number 6 Township Number T 23 S Range Number R 23 E W

2 WELL OWNER: Last Name: Business: KDHE Address: 1000 SW Jackson Blvd City Topeka State: KS ZIP: 66612 Street or Rural Address where well is located (if unknown, distance and direction from nearest town or intersection): 601 Main, Jetmore, KS

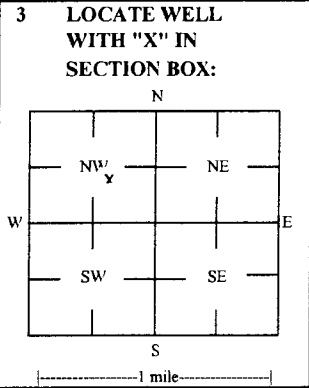

4 DEPTH OF COMPLETED WELL: 65 ft Depth(s) Groundwater Encountered: 1) 65 ft 2) ft 3) ft or 4) Dry Well WELL'S STATIC WATER LEVEL: 50.7 ft

5 Latitude: 38.08330 (decimal degrees) Longitude: 99.89418 (decimal degrees) Horizontal Datum: WGS 84 NAD 83 NAD 27 Source for Latitude/Longitude: GPS (unit make/model) (WAAS enabled? Yes No) Land Survey Topographic Map Online Mapper

6 Elevation: 2306.04 ft Ground Level TOC Source: Land Survey GPS Topographic Map Other

7 WELL WATER TO BE USED AS: 1 Domestic: Household Lawn & Garden Livestock Irrigation Feedlot Industrial 2 Public Water Supply: well ID 3 Dewatering: how many wells? 4 Aquifer Recharge: well ID 5 Monitoring: well ID MW13 6 Environmental Remediation: well ID Air Sparge Soil Vapor Extractor Recovery Injection 7 Oil Field Water Supply: lease 8 Test Hole: well ID Cased Uncased Geotechnical 9 Geothermal: How many bores? a) Closed Loop Horizontal Vertical b) Open Loop Surface Discharge Inj. of Water Other (specify):

Was a chemical/bacteriological sample submitted to KDHE? Yes No If yes, date sample was submitted: Water well disinfected? Yes No

8 TYPE OF CASING USED: Steel PVC Other CASING JOINTS: Glued Clamped Welded Threaded Casing diameter 2 in. to 45 ft, Diameter in. to ft, Diameter in. to ft, Casing height above land surface 0.20 in. Weight lbs./ft. Well thickness or gauge No

TYPE OF SCREEN OR PERFORATION MATERIAL: Steel Stainless Steel Fiberglass PVC Other (Specify) SCREEN OR PERFORATION OPENINGS ARE: Continuous Slot Mill Slot Gauze Wrapped Torch Cut Drilled Holes Other (Specify) Louvered Shutter Key Punched Wire Wrapped Saw Cut None (Open Hole) SCREEN-PERFORATED INTERVALS: From 45 ft. to 65 ft. From ft. to ft. From ft. to ft. GRAVEL PACK INTERVALS: From 43 ft. to 65 ft. From ft. to ft. From ft. to ft.

9 GROUT MATERIAL: Neat cement Cement grout Bentonite Other Concrete: 0-0.5 ft Grout intervals: From 0.5 ft. to 43 ft. From ft. to ft. From ft. to ft.

Nearest source of possible contamination: Septic Tank Lateral Lines Pit Privy Livestock Pens Insecticide Storage Sewer Lines Cess Pool Sewage Lagoon Fuel Storage Abandoned Water Well Watertight Sewer Lines Seepage Pit Feedyard Fertilizer Storage Oil Well / Gas Well Other (Specify) Direction from well? S Distance from well? ~85 ft

Table with 6 columns: FROM, TO, LITHOLOGIC LOG, FROM, TO, LITHO. LOG (cont.) or PLUGGING INTERVALS. Rows include: 0-0.5 Concrete, 0.5-1 Fill sand, 1-6 Silty clay, 6-57 Clavey silt, 57-61 Coarse sand, 61-65 Clavey silt with some coarse sand.

Notes: KDHE ID: Guthrie Station; U1-042-14957

11 CONTRACTOR'S OR LANDOWNER'S CERTIFICATION: This water well was constructed, reconstructed, or plugged under my jurisdiction and was completed on (mo-day-year) 11/6/17 and this record is true to the best of my knowledge and belief. Kansas Water Well Contractor's License No. 757 This Water Well Record was completed on (mo-day-year) 12/6/17 under the business name of Larsen & Associates, Inc. Signature

Mail 1 white copy along with a fee of \$5.00 for each constructed well to: Kansas Department of Health and Environment, Bureau of Water, 1000 SW Jackson St., Suite 420, Topeka, Kansas 66612-1367. Mail one to Water Well Owner and retain one for your records, Telephone 785-296-5524.

SMH CONSULTANTS

November 21, 2016

Larsen & Associates
Jessica Chapman
1311 East 25th Street, Suite B
Lawrence, Kansas 66046
Email: Jess@LarsenEnvironmental.com

RE: Project No. 1711MN1333

Dear Jessica:

The following is the information requested on a Monitoring Well Site, Guthrie Station, 611 Main Street, Jetmore, Hodgeman County, Kansas.

Point	North Coord.	East Coord.	Distance SE Cor. North	From S.06 West	Elev. Top Of Rim or PK Nail	Elev. Top of PVC Pipe	Latitude North	Longitude West
SE Corner S.06-T23S-R23W	10000	10000						
MW13	13479.53	6088.69	3479.53	3911.31	2306.24	2306.04	38.08330	99.89418
Site BM	13246.28	6151.69	3246.28	3848.31		BM Elevation = 2301.74		

BM Description: "□" Square cut on top of curb at northwest corner of Main and Tucker.

MW13 is in the: SW¼ NW¼ SE¼ NW¼ S.06-T23S-R23W

If you have any questions please do not hesitate in giving us a call.

Sincerely,



Tim Sloan, L.S.
SMH CONSULTANTS

NOTE: Figures exhibited within this report are only to be used within the context of this report. Placement of property lines, wells, structures, and roads is based on the available information from county appraiser maps, surveys, site visits, and/or previous vendor reports and should be considered approximate.

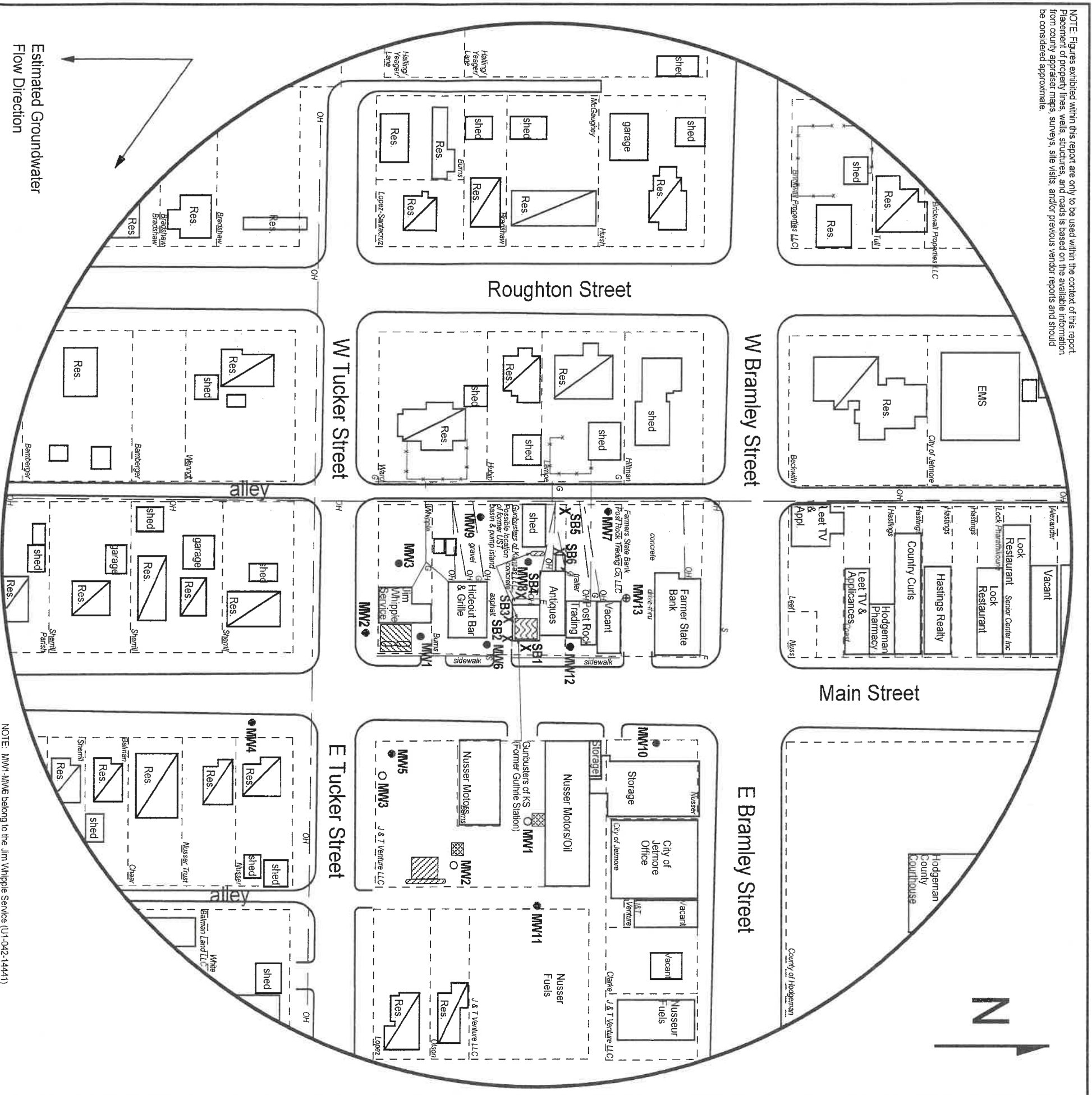

FIGURE 2.2 - 500 FT RADIUS AREA BASE MAP

larsen
 & ASSOCIATES, INC.

1311 E 25th St., Suite B (785) 841-8707 office
 Lawrence, KS 66046 (785) 865-4282 fax

PROJECT:
 Guthrie Station
 611 Main Street
 Jetmore, KS
 KDHE ID: U1-042-14957
 Date: 11/7/17

LEGEND:

- Approximate Location of Inactive UST Basin and Pump Island
- Approximate Location of Active UST Basin and Pump Islands
- Approximate Location of Former UST Basin and Pump Islands
- Approximate Location of Property Line
- Building with Basement
- Existing Monitoring Well
- Plugged Well
- Monitoring Well (Installed 11/6/17)
- Soil Boring (Drilled 7/11-13/17)
- Electric Meter
- Sewer Inlet
- Overhead Lines (25-40 ft high)
- Electric Lines (3-6 ft BGS)

NOTE: Utility depths, heights and locations are approximate.
 NOTE: SB5 & SB6 were drilled to collect hydrologic samples.
 NOTE: Location of product lines is unknown.

NOTE: MMW1-MMW5 belong to the Jim Whipple Service (U1-042-14441)
 NOTE: Wells MMW1-MMW5 were not within the scope of work.