

WATER WELL RECORD

Form WWC-5

Division of Water Resources App. No.

Well ID

MW14

Original Record Correction Change in Well Ust

1 LOCATION OF WATER WELL: County Hodgeman Fraction NE 1/4 SE 1/4 SW 1/4 NW 1/4 Section Number 6 Township Number T 23 S Range Number R 23 E W

2 WELL OWNER: Last Name: First: Street or Rural Address where well is located (if unknown, distance and direction from nearest town or intersection): If at owner's address, check here: ~150' SW of 611 Main, Jetmore, KS

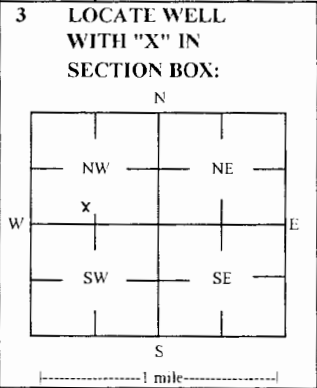

4 DEPTH OF COMPLETED WELL: 65 ft Depth(s) Groundwater Encountered: 1) 65 ft 2) ft 3) ft, or 4) Dry Well WELL'S STATIC WATER LEVEL: 51.50 ft

5 Latitude: 38.08263 (decimal degrees) Longitude: 99.89465 (decimal degrees) Horizontal Datum: WGS 84 X NAD 83 NAD 27 Source for Latitude/Longitude: GPS (unit make/model: ) (WAAS enabled? Yes No) X Land Survey Topographic Map Online Mapper

7 WELL WATER TO BE USED AS: 1 Domestic: Household Lawn & Garden Livestock Irrigation Feedlot Industrial 2 Public Water Supply: well ID 3 Dewatering: how many wells? 4 Aquifer Recharge: well ID 5 Monitoring: well ID MW14 6 Environmental Remediation: well ID 7 Air Sparge Soil Vapor Extraction Recovery Injection 8 Oil Field Water Supply: lease 9 Test Hole: well ID 10 Cased Uncased Geotechnical 11 Geothermal: How many bores? 12 a) Closed Loop Horizontal Vertical b) Open Loop Surface Discharge Inj. of Water Other (specify):

Was a chemical/bacteriological sample submitted to KDHE? Yes No If yes, date sample was submitted: Water well disinfected? Yes No

8 TYPE OF CASING USED: Steel PVC Other CASING JOINTS: Glued Clamped Welded Threaded Casing diameter 2 in. to 45 ft, Diameter in. to ft, Diameter in. to ft, Casing height above land surface -0.14 in. Weight lbs./ft. Well thickness or gauge No TYPE OF SCREEN OR PERFORATION MATERIAL: Steel Stainless Steel Fiberglass PVC Other (Specify) Brass Galvanized Steel Concrete tile None used (open hole) SCREEN OR PERFORATION OPENINGS ARE: Continuous Slot Mill Slot Gauze Wrapped Torch Cut Drilled Holes Other (Specify) Louvered Shutter Key Punched Wire Wrapped Saw Cut None (Open Hole) SCREEN-PERFORATED INTERVALS: From 45 ft. to 65 ft. From ft. to ft. From ft. to ft. GRAVEL PACK INTERVALS: From 43 ft. to 65 ft. From ft. to ft. From ft. to ft.

9 GROUT MATERIAL: Neat cement Cement grout Bentonite Other Concrete: 0-1 ft Grout intervals: From 1 ft. to 43 ft. From ft. to ft. From ft. to ft. Nearest source of possible contamination: Septic Tank Lateral Lines Pit Privy Livestock Pens Insecticide Storage Sewer Lines Cess Pool Sewage Lagoon Fuel Storage Abandoned Water Well Watertight Sewer Lines Seepage Pit Feedyard Fertilizer Storage Oil Well / Gas Well Other (Specify) Direction from well? NE Distance from well? ~180 ft

Table with columns: FROM, TO, LITHOLOGIC LOG, FROM, TO, LITHO. LOG (cont.) or PLUGGING INTERVALS. Rows: 0-25 Silt, loess; 25-53 Clayey silt; 53-62 Medium grained sand; 62-65 Silty clay. Notes: KDHE ID: Guthrie Station: UI-042-14957

11 CONTRACTOR'S OR LANDOWNER'S CERTIFICATION: This water well was constructed reconstructed or plugged under my jurisdiction and was completed on (mo-day-year) 5/16/18 and this record is true to the best of my knowledge and belief. Kansas Water Well Contractor's License No 757 This Water Well Record was completed on (mo-day-year) 5/24/18 under the business name of Larsen & Associates, Inc. Signature

# SMH CONSULTANTS

May 22, 2018

Larsen & Associates  
 Jessica Chapman  
 1311 East 25<sup>th</sup> Street, Suite B  
 Lawrence, Kansas 66046  
 Email: Jess@LarsenEnvironmental.com

RE: Project No. 1805DG1137

Dear Jessica:

The following is the information requested on a Monitoring Well Site, Guthrie Station, 611 Main Street, Jetmore, Hodgeman County, Kansas.

Point	North Coord.	East Coord.	Distance SE Cor. North	From S.06 West	Elev. Top Of Rim or PK Nail	Elev. Top of PVC Pipe	Latitude North	Longitude West
SE Corner S.06-T23S-R23W	10000	10000						
MW14	13232.63	5956.42	3232.63	4043.58	2303.85	2303.71	38.08263	99.89465
MW15	13301.20	5829.71	3301.20	4170.29	2303.64	2303.35	38.08283	99.89509
MW16	13440.42	5827.79	3440.42	4172.21	2304.53	2304.25	38.08321	99.89509
Site BM	13246.28	6151.69	3246.28	3848.31				BM Elevation = 2301.74

BM Description: "□" Square cut on top of curb at northwest corner of Main and Tucker.

MW14 is in the: NE¼ SE¼ SW¼ NW¼ S.06-T23S-R23W  
 MW15, MW16 are in the: SE¼ NE¼ SW¼ NW¼ S.06-T23S-R23W

If you have any questions please do not hesitate in giving us a call.

Sincerely,



Tim Sloan, L.S.  
 SMH CONSULTANTS

RECEIVED  
 JUN 18 2018  
 BUREAU OF WATER

Hodgeman 6-23-23 W

NOTE: Figures exhibited within this report are only to be used within the context of this report. Placement of property lines, wells, structures, and roads is based on the available information from county appraiser maps, surveys, site visits, and/or previous vendor reports and should be considered approximate.

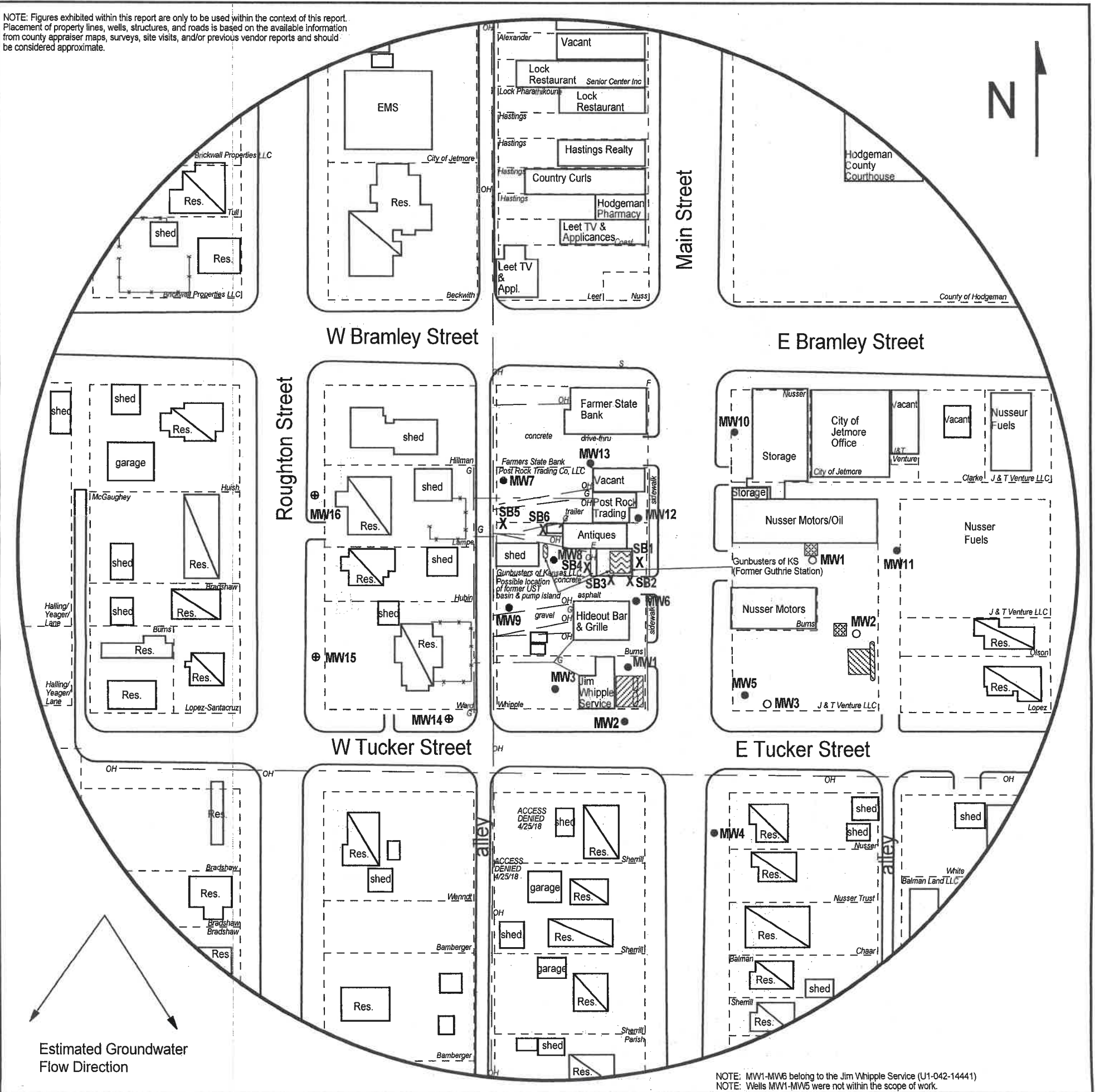

NOTE: MW1-MW6 belong to the Jim Whipple Service (U1-042-14441)  
NOTE: Wells MW1-MW5 were not within the scope of work.

**FIGURE 2.2 - 500 FT RADIUS AREA BASE MAP**

**LEGEND:**

- Approximate Location of Inactive UST Basin and Pump Island
- Approximate Location of Active UST Basin and Pump Islands
- Approximate Location of Former UST Basin and Pump Islands
- Approximate Location of Property Line
- Building with Basement
- Existing Monitoring Well
- Plugged Well
- Monitoring Well (Installed 5/16-17/18)
- Soil Boring (Drilled 7/11-13/17)
- Electric Meter
- Sewer Inlet
- Overhead Lines (25-40 ft high)
- Electric Lines (3-6 ft BGS)

NOTE: Utility depths, heights and locations are approximate.  
NOTE: SB5 & SB6 were drilled to collect hydrologic samples.  
NOTE: Location of product lines is unknown.



**PROJECT:**  
Guthrie Station  
611 Main Street  
Jetmore, KS  
KDHE ID: U1-042-14957  
Date: 5/18/18

1311 E 25th St., Suite B (785) 841-8707 office  
Lawrence, KS 66046 (785) 865-4282 fax

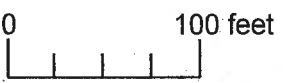

RECEIVED  
JUN 18 2018  
BUREAU OF WATER