

WATER WELL RECORD

Form WWC-5

Division of Water Resources App. No.

Well ID

MW15

Original Record Correction Change in Well Ust

1 LOCATION OF WATER WELL: Fraction Section Number Township Number Range Number

2 WELL OWNER: Last Name: Business: Address: City: State: ZIP: Street or Rural Address where well is located

3 LOCATE WELL WITH "X" IN SECTION BOX: 4 DEPTH OF COMPLETED WELL: 5 Latitude: Longitude: Elevation: Source

7 WELL WATER TO BE USED AS: 1 Domestic: 2 Irrigation: 3 Feedlot: 4 Industrial: 5 Public Water Supply: well ID: 6 Dewatering: how many wells?: 7 Aquifer Recharge: well ID: 8 Monitoring: well ID MW15: 9 Environmental Remediation: well ID: 10 Oil Field Water Supply: lease: 11 Test Hole: well ID: 12 Geothermal: How many bores?:

Was a chemical/bacteriological sample submitted to KDHE? Water well disinfected?

8 TYPE OF CASING USED: CASING JOINTS: TYPE OF SCREEN OR PERFORATION MATERIAL: SCREEN OR PERFORATION OPENINGS ARE: SCREEN-PERFORATED INTERVALS: GRAVEL PACK INTERVALS:

9 GROUT MATERIAL: Grout intervals:

Nearest source of possible contamination: Direction from well? Distance from well?

Table with columns: FROM, TO, LITHOLOGIC LOG, FROM, TO, LITHO. LOG (cont.) or PLUGGING INTERVALS

11 CONTRACTOR'S OR LANDOWNER'S CERTIFICATION: This water well was constructed, reconstructed, or plugged under my jurisdiction and was completed on (mo-day-year) 5/17/18 and this record is true to the best of my knowledge and belief.

SMH CONSULTANTS

May 22, 2018

Larsen & Associates
Jessica Chapman
1311 East 25th Street, Suite B
Lawrence, Kansas 66046
Email: Jess@LarsenEnvironmental.com

RE: Project No. 1805DG1137

Dear Jessica:

The following is the information requested on a Monitoring Well Site, Guthrie Station, 611 Main Street, Jetmore, Hodgeman County, Kansas.

Point	North Coord.	East Coord.	Distance SE Cor. North	From S.06 West	Elev. Top Of Rim or PK Nail	Elev. Top of PVC Pipe	Latitude North	Longitude West
SE Corner S.06-T23S-R23W	10000	10000						
MW14	13232.63	5956.42	3232.63	4043.58	2303.85	2303.71	38.08263	99.89465
MW15	13301.20	5829.71	3301.20	4170.29	2303.64	2303.35	38.08283	99.89509
MW16	13440.42	5827.79	3440.42	4172.21	2304.53	2304.25	38.08321	99.89509
Site BM	13246.28	6151.69	3246.28	3848.31				BM Elevation = 2301.74

BM Description: "□" Square cut on top of curb at northwest corner of Main and Tucker.

MW14 is in the: NE¼ SE¼ SW¼ NW¼ S.06-T23S-R23W
MW15, MW16 are in the: SE¼ NE¼ SW¼ NW¼ S.06-T23S-R23W

If you have any questions please do not hesitate in giving us a call.

Sincerely,



Tim Sloan, L.S.
SMH CONSULTANTS

RECEIVED
JUN 18 2018
BUREAU OF WATER

Hodgeman 6-23-23 W

NOTE: Figures exhibited within this report are only to be used within the context of this report. Placement of property lines, wells, structures, and roads is based on the available information from county appraiser maps, surveys, site visits, and/or previous vendor reports and should be considered approximate.

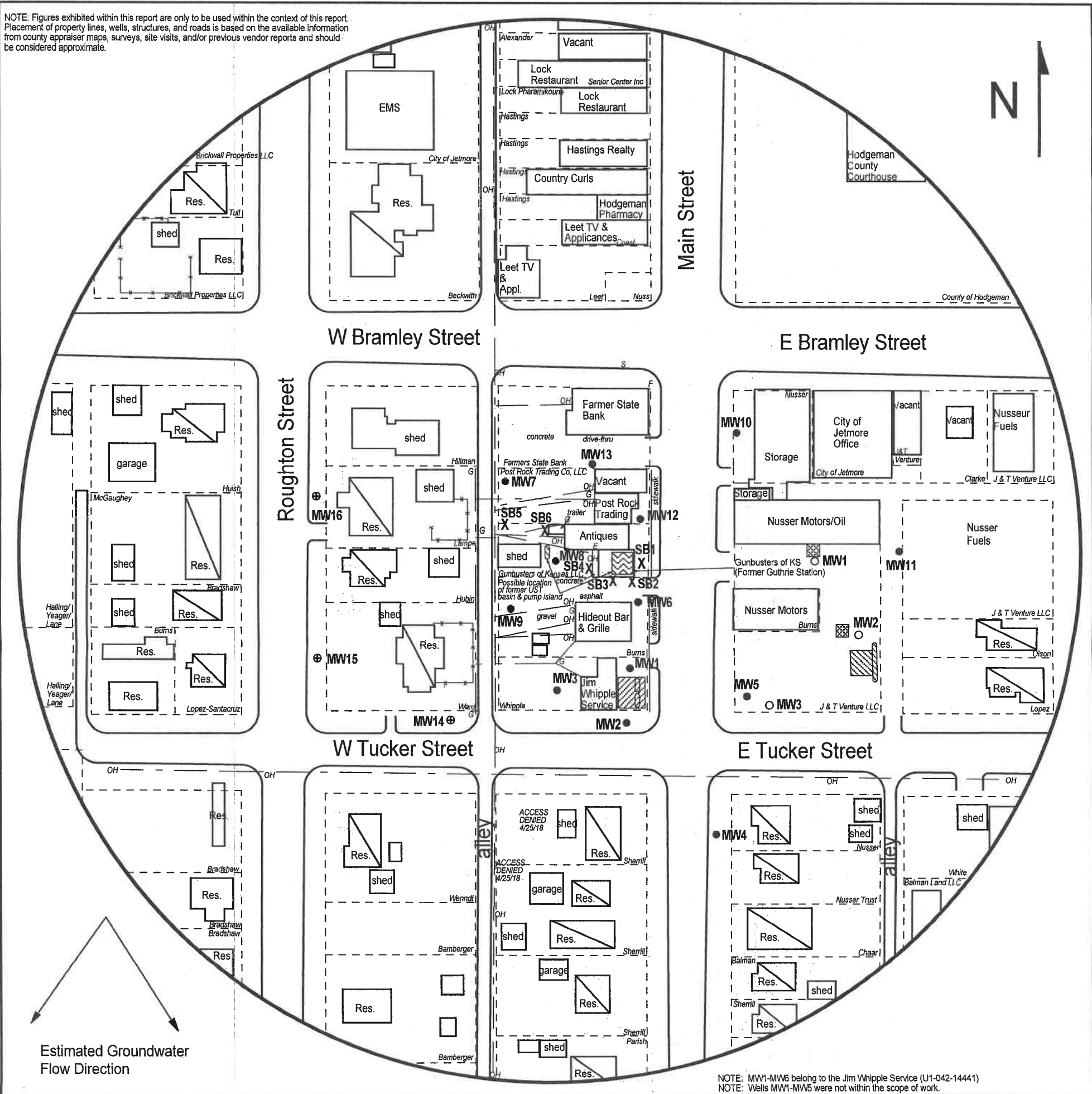

NOTE: MW1-MW6 belong to the Jim Whipple Service (U1-042-14441)
NOTE: Wells MW1-MW5 were not within the scope of work.

FIGURE 2.2 - 500 FT RADIUS AREA BASE MAP

LEGEND:

- Approximate Location of Inactive UST Basin and Pump Island
- Approximate Location of Active UST Basin and Pump Islands
- Approximate Location of Former UST Basin and Pump Islands
- Approximate Location of Property Line
- Building with Basement
- Existing Monitoring Well
- Plugged Well
- Monitoring Well (Installed 5/16-17/18)
- Soil Boring (Drilled 7/11-13/17)
- Electric Meter
- Sewer Inlet
- Overhead Lines (25-40 ft high)
- Electric Lines (3-6 ft BGS)

NOTE: Utility depths, heights and locations are approximate.
NOTE: SB5 & SB6 were drilled to collect hydrologic samples.
NOTE: Location of product lines is unknown.



PROJECT:
Guthrie Station
611 Main Street
Jetmore, KS
KDHE ID: U1-042-14957
Date: 5/18/18

1311 E 25th St., Suite B (785) 841-8707 office
Lawrence, KS 66046 (785) 865-4282 fax

0 100 feet

RECEIVED
JUN 18 2018
BUREAU OF WATER