

WATER WELL RECORD

Form WWC-5

Division of Water Resources App. No.

Well ID

MW16

Original Record Correction Change in Well Use

1 LOCATION OF WATER WELL: County: Hodgeman Fraction: SE 1/4 NE 1/4 SW 1/4 NW 1/4 Section Number: 6 Township Number: T 23 S Range Number: R 23 E W

2 WELL OWNER: Last Name: Business: KDHE Address: 1000 SW Jackson Blvd City: Topeka State: KS ZIP: 66612 Street or Rural Address where well is located (if unknown, distance and direction from nearest town or intersection): ~185' NW of 611 Main, Jetmore, KS

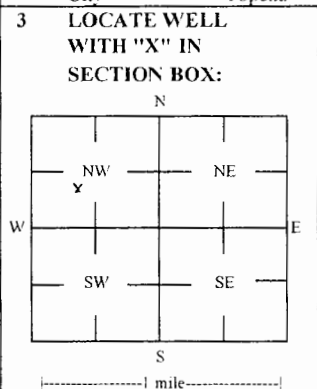

3 LOCATE WELL WITH 'X' IN SECTION BOX: 4 DEPTH OF COMPLETED WELL: 65 ft Depth(s) Groundwater Encountered: 1) _____ ft 2) _____ ft 3) _____ ft, or 4) Dry Well WELLS STATIC WATER LEVEL: 49.16 ft. [X] below land surface, measured on (mo-day-yr) 5/17/2018 [] above land surface, measured on (mo-day-yr) Pump test data: Well water was _____ ft after _____ hours pumping _____ gpm Water well was _____ ft after _____ hours pumping _____ gpm Estimated Yield: _____ gpm Bore Hole Diameter: 7.25 in to _____ ft, and _____ in to _____ ft

5 Latitude: 38.08321 (decimal degrees) Longitude: 99.89509 (decimal degrees) Horizontal Datum: [] WGS 84 [X] NAD 83 [] NAD 27 Source for Latitude/Longitude: [] GPS (unit make/model: _____) (WAAS enabled? [] Yes [] No) [X] Land Survey [] Topographic Map [] Online Mapper

6 Elevation: 2304.25 ft [] Ground Level [X] TOC Source: [X] Land Survey [] GPS [] Topographic Map [] Other

7 WELL WATER TO BE USED AS: 1 Domestic: [] Household [] Lawn & Garden [] Livestock 2 Irrigation 3 Feedlot 4 Industrial 5 Public Water Supply: well ID 6 Dewatering: how many wells? 7 Aquifer Recharge: well ID 8 [X] Monitoring: well ID MW16 9 Environmental Remediation: well ID [] Air Sparge [] Soil Vapor Extractor [] Recovery [] Injection 10 Oil Field Water Supply: lease 11 Test Hole: well ID [] Cased [] Uncased [] Geotechnical 12 Geothermal: How many bores? a) Closed Loop [] Horizontal [] Vertical b) Open Loop [] Surface Discharge [] Inj. of Water [] Other (specify):

Was a chemical/bacteriological sample submitted to KDHE? [] Yes [X] No If yes, date sample was submitted: Water well disinfected? [] Yes [X] No

8 TYPE OF CASING USED: [] Steel [X] PVC [] Other CASING JOINTS: [] Glued [] Clamped [] Welded [X] Threaded Casing diameter 2 in. to 45 ft, Diameter _____ in. to _____ ft, Diameter _____ in. to _____ ft, Casing height above land surface -0.28 in. Weight _____ lbs./ft. Well thickness or gauge No _____ TYPE OF SCREEN OR PERFORATION MATERIAL: [] Steel [] Stainless Steel [] Fiberglass [X] PVC [] Brass [] Galvanized Steel [] Concrete tile [] None used (open hole) SCREEN OR PERFORATION OPENINGS ARE: [] Continuous Slot [X] Mill Slot [] Gauze Wrapped [] Torch Cut [] Drilled Holes [] Other (Specify) [] Louvered Shutter [] Key Punched [] Wire Wrapped [] Saw Cut [] None (Open Hole) SCREEN-PERFORATED INTERVALS: From 45 ft. to 65 ft., From _____ ft. to _____ ft., From _____ ft. to _____ ft., GRAVEL PACK INTERVALS: From 43 ft. to 65 ft., From _____ ft. to _____ ft., From _____ ft. to _____ ft.,

9 GROUT MATERIAL: [] Neat cement [X] Cement grout [X] Bentonite [X] Other Concrete: 0-1 ft Grout intervals: From 1 ft. to 43 ft., From _____ ft. to _____ ft., From _____ ft. to _____ ft.,

Nearest source of possible contamination: [] Septic Tank [] Lateral Lines [] Pit Privy [] Livestock Pens [] Insecticide Storage [] Sewer Lines [] Cess Pool [] Sewage Lagoon [X] Fuel Storage [] Abandoned Water Well [] Watertight Sewer Lines [] Seepage Pit [] Feedyard [] Fertilizer Storage [] Oil Well / Gas Well [] Other (Specify) Direction from well? SE Distance from well? ~225 ft

10 FROM TO LITHOLOGIC LOG FROM TO LITHO. LOG (cont.) or PLUGGING INTERVALS

0	6	Silt			
6	43	Clavey silt			
43	47	Fine grained sand			
47	54	Medium grained sand			
54	60	Coarse grained sand			
60	65	Fine to medium sand			

Notes: KDHE ID: Guthrie Station; U1-042-14957

11 CONTRACTOR'S OR LANDOWNER'S CERTIFICATION: This water well was [X] constructed, [] reconstructed, or [] plugged under my jurisdiction and was completed on (mo-day-year) 5/17/18 and this record is true to the best of my knowledge and belief. Kansas Water Well Contractor's License No 757 This Water Well Record was completed on (mo-day-year) 5/24/18 under the business name of Larsen & Associates, Inc. Signature

SMH CONSULTANTS

May 22, 2018

Larsen & Associates
 Jessica Chapman
 1311 East 25th Street, Suite B
 Lawrence, Kansas 66046
 Email: Jess@LarsenEnvironmental.com

RE: Project No. 1805DG1137

Dear Jessica:

The following is the information requested on a Monitoring Well Site, Guthrie Station, 611 Main Street, Jetmore, Hodgeman County, Kansas.

Point	North Coord.	East Coord.	Distance SE Cor. North	From S.06 West	Elev. Top Of Rim or PK Nail	Elev. Top of PVC Pipe	Latitude North	Longitude West
SE Corner S.06-T23S-R23W	10000	10000						
MW14	13232.63	5956.42	3232.63	4043.58	2303.85	2303.71	38.08263	99.89465
MW15	13301.20	5829.71	3301.20	4170.29	2303.64	2303.35	38.08283	99.89509
MW16	13440.42	5827.79	3440.42	4172.21	2304.53	2304.25	38.08321	99.89509
Site BM	13246.28	6151.69	3246.28	3848.31		BM Elevation = 2301.74		

BM Description: "□" Square cut on top of curb at northwest corner of Main and Tucker.

MW14 is in the: NE¼ SE¼ SW¼ NW¼ S.06-T23S-R23W
 MW15, MW16 are in the: SE¼ NE¼ SW¼ NW¼ S.06-T23S-R23W

If you have any questions please do not hesitate in giving us a call.

Sincerely,



Tim Sloan, L.S.
 SMH CONSULTANTS

RECEIVED
 JUN 18 2018
 BUREAU OF WATER

Hodgeman 6-23-23 W

NOTE: Figures exhibited within this report are only to be used within the context of this report. Placement of property lines, wells, structures, and roads is based on the available information from county appraiser maps, surveys, site visits, and/or previous vendor reports and should be considered approximate.

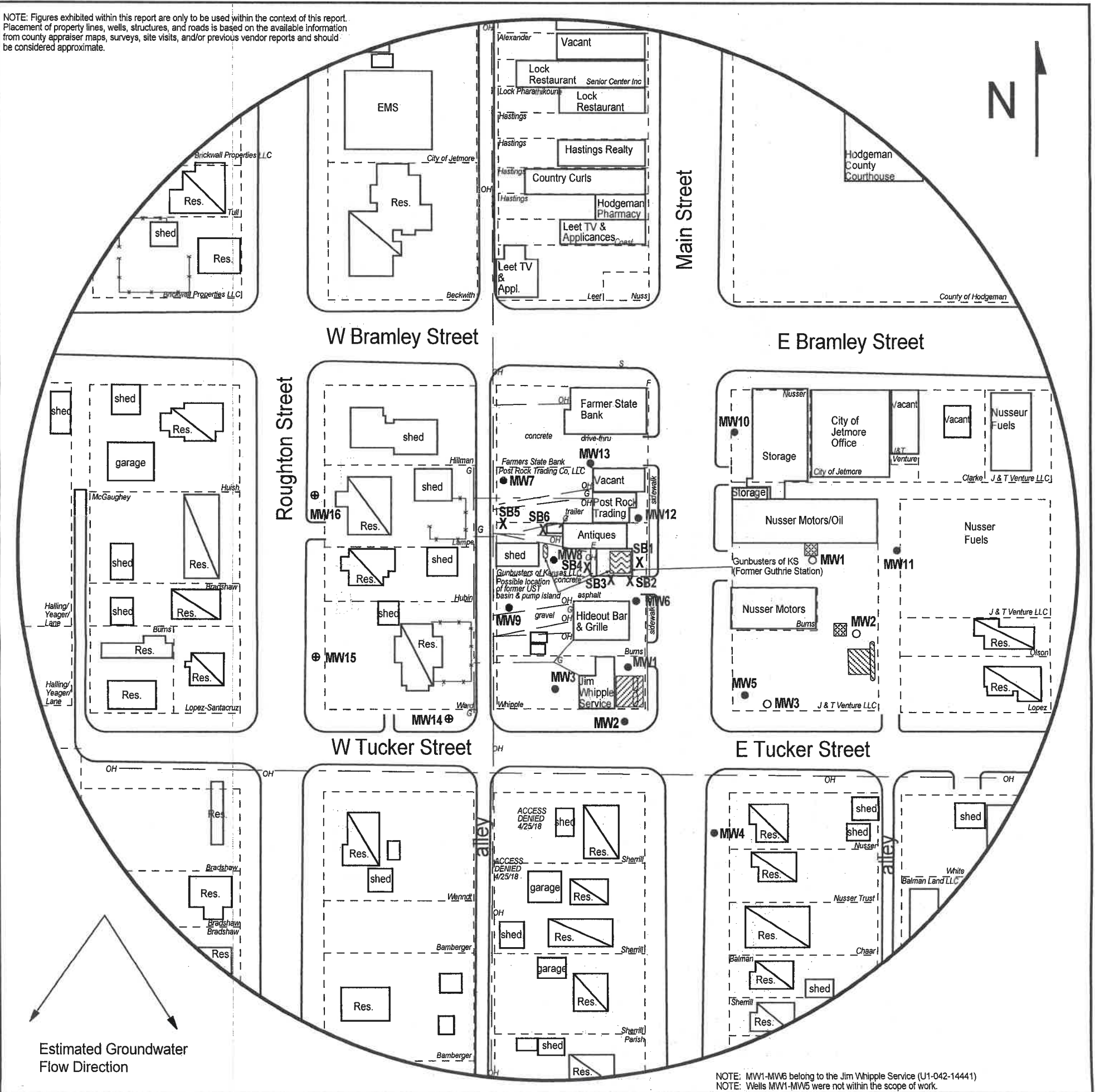

NOTE: MW1-MW6 belong to the Jim Whipple Service (U1-042-14441)
NOTE: Wells MW1-MW5 were not within the scope of work.

FIGURE 2.2 - 500 FT RADIUS AREA BASE MAP

LEGEND:

- Approximate Location of Inactive UST Basin and Pump Island
 - Approximate Location of Active UST Basin and Pump Islands
 - Approximate Location of Former UST Basin and Pump Islands
 - Approximate Location of Property Line
 - Building with Basement
 - Existing Monitoring Well
 - Plugged Well
 - Monitoring Well (Installed 5/16-17/18)
 - Soil Boring (Drilled 7/11-13/17)
 - Electric Meter
 - Sewer Inlet
 - Overhead Lines (25-40 ft high)
 - Electric Lines (3-6 ft BGS)
- NOTE: Utility depths, heights and locations are approximate.
NOTE: SB5 & SB6 were drilled to collect hydrologic samples.
NOTE: Location of product lines is unknown.



PROJECT:
Guthrie Station
611 Main Street
Jetmore, KS
KDHE ID: U1-042-14957
Date: 5/18/18

1311 E 25th St., Suite B (785) 841-8707 office
Lawrence, KS 66046 (785) 865-4282 fax

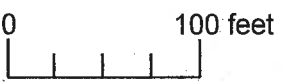

RECEIVED
JUN 18 2018
BUREAU OF WATER