

County: Hodgeman Fraction: SW SE NW NE Sec. 14 T. 23 S R. 26 W

CORRECTION(S) to WATER WELL COMPLETION RECORD Form WWC-5 (to rectify lacking or incorrect information)

Owner: Todd Hamilton

If location corrected, was listed as:

Section-Township-Range: 29-28-23W

Fraction (¼ calls): SW SE NW NE

Location changed to:

14-23-26W

SW SE NW NE

Other changes: Initial statements: _____

Changed to: _____

Comments: lat/long and STR puts property in Ford County.

Verification method: Checked parcel search under Farm Fever owned by Todd Hamilton and found 14-23-26W. This is written on WWC5 in location .

Initials: SH Date: 08-25-2021

Submitted by: Kansas Geological Survey, Data Resources Library, 1930 Constant Ave., Lawrence, KS 66047-3724
 Kansas Dept. of Health & Environment, Bureau of Water, 1000 SW Jackson, Suite 420, Topeka, KS 66612-1367

1 LOCATION OF WATER WELL: Fraction SW 1/4 SE 1/4 NW 1/4 NE 1/4 Section Number 29 Township Number 28 T S Range Number 23 E W
 County: Hodgeman

Street/Rural Address of Well Location; if unknown, distance & direction from nearest town or intersection: If at owner's address, check here Township Benton
14-0235-026W

Global Positioning Systems (GPS) information:
 Latitude: 37.584375 (in decimal degrees)
 Longitude: 99.557436 (in decimal degrees)
 Elevation: 2444
 Datum: WGS84, NAD83, NAD27
 Collection Method:
 GPS unit (Make/Model: Garmin)
 Digital Map/Photo, Topographic Map, Land Survey
 Est. Accuracy: <3 m, 3-5 m, 5-15 m, >15 m

2 WATER WELL OWNER: Todd Hamilton
 RR#, St. Address, Box #: 25500 88nd Rd
 City, State ZIP Code: Ensign KS 67841

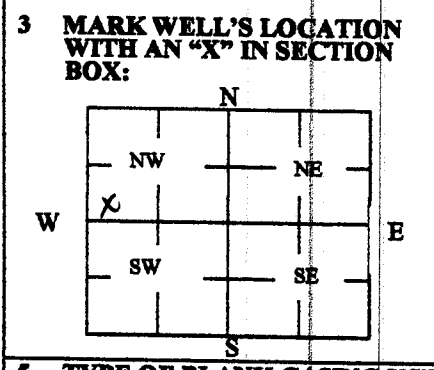

4 DEPTH OF WELL 60 ft.
WELL'S STATIC WATER LEVEL 50 ft.
WELL WAS USED AS:
 Domestic Public Water Supply Dewatering
 Irrigation Oil Field Water Supply Monitoring
 Feedlot Domestic (Lawn & Garden) Injection Well
 Industrial Air Conditioning Other _____
 Was a chemical/bacteriological sample submitted to Department? Yes No

5 TYPE OF BLANK CASING USED:
 Steel RMP (SR) Wrought Fiberglass Other (Specify below)
 PVC ABS Asbestos-Cement Concrete Tile
 Blank casing diameter 5 in. Was casing pulled? Yes No If yes, how much _____
 Casing height above or below land surface 48 in.

6 GROUT PLUG MATERIAL: Neat cement Cement grout Bentonite Other _____
 Grout Plug Intervals: From 50 ft. to 45 ft., From 4 ft. to 0 ft., From _____ ft. to _____ ft.
 What is the nearest source of possible contamination:
 Septic tank Seepage pit Fuel storage Other (specify below)
 Sewer lines Pit privy Fertilizer storage
 Watertight sewer lines Sewage lagoon Insecticide storage
 Lateral lines Feedyard Abandoned water well
 Cess pool Livestock pens Oil well/Gas well
 Direction from well? SE
 How many feet? 5280

FROM	TO	PLUGGING MATERIALS	FROM	TO	PLUGGING MATERIALS
60	50	Clean Fill Sand			
50	45	Bentonite			
45	4	Clean Fill Sand			
4	0	Bentonite			

7 CONTRACTOR'S OR LANDOWNER'S CERTIFICATION: This water well was plugged under my jurisdiction and was completed on (mo/day/year) 3/16/15 and this record is true to the best of my knowledge and belief. Kansas Water Well Contractor's License No. 816. This Water Well Record was completed on (mo/day/year) 3/17/15 under the business name of Nash Water Well Service LLC by (signature) John J. Cook

INSTRUCTIONS: Use typewriter or ballpoint pen. Please press firmly and print clearly. Please fill in blanks, underline or circle the correct answers. Send top three copies to Kansas Department of Health and Environment, Bureau of Water, Geology Section, 1000 SW Jackson St., Ste. 420, Topeka, Kansas 66612-1367. Telephone: 785/296-5524. Send one to Water Well Owner and retain one for your records. Visit us at <http://www.kdheks.gov/waterwell/index.html>.