

WATER WELL RECORD

Form WWC-5

Division of Water Resources App. No.

1 LOCATION OF WATER WELL: County: <u>Finney</u>	Fraction <u>1/4 NE 1/4 NW 1/4 NW 1/4</u>	Section Number <u>24</u>	Township No. T <u>23</u> S	Range Number R <u>29</u> <input type="checkbox"/> E <input checked="" type="checkbox"/> W
Street/Rural Address of Well Location; if unknown, distance & direction from nearest town or intersection: If at owner's address, check here <input checked="" type="checkbox"/> .		Global Positioning System (GPS) information: Latitude: (in decimal degrees) Longitude: (in decimal degrees) Elevation: Datum: <input type="checkbox"/> WGS 84, <input type="checkbox"/> NAD 83, <input type="checkbox"/> NAD 27 Collection Method: <input type="checkbox"/> GPS unit (Make/Model:) <input type="checkbox"/> Digital Map/Photo, <input type="checkbox"/> Topographic Map, <input type="checkbox"/> Land Survey Est. Accuracy: <input type="checkbox"/> <3 m, <input type="checkbox"/> 3-5 m, <input type="checkbox"/> 5-15 m, <input type="checkbox"/> >15 m		
2 WATER WELL OWNER: RR#, Street Address, Box #: City, State, ZIP Code		Max Oyler <u>23940 E. Co. Rd V</u> <u>Ingalls, KS. 67853</u>		

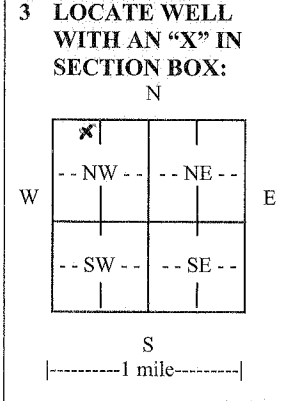

4 DEPTH OF COMPLETED WELL 115 ft.

Depth(s) Groundwater Encountered (1)..... ft. (2)..... ft. (3)..... ft.

WELL'S STATIC WATER LEVEL..... 67 ft. below land surface measured on mo/day/yr. 12/12/12

Pump test data: Well water was.....ft. after..... hours pumping..... gpm

EST. YIELD..... gpm. Well water was.....ft. after..... hours pumping..... gpm

Bore Hole Diameter 7/8 in. to 115 ft., and in. to ft.

WELL WATER TO BE USED AS: Public water supply Geothermal Injection well

Domestic Feedlot Oil field water supply Dewatering Other (Specify below)

Irrigation Industrial Domestic-lawn & garden Monitoring well

Was a chemical/bacteriological sample submitted to Department? Yes No

If yes, mo/day/yr sample was submitted.....

Water well disinfected? Yes No

5 TYPE OF CASING USED: Steel PVC Other

CASING JOINTS: Glued Clamped Welded Threaded

Casing diameter in. to ft., Diameter in. to ft., Diameter in. to ft.

Casing height above land surface..... 12 in., Weight lbs./ft., Wall thickness or gauge No. SPR 21

TYPE OF SCREEN OR PERFORATION MATERIAL:

Steel Stainless Steel PVC Other (Specify)

Brass Galvanized Steel None used (open hole)

SCREEN OR PERFORATION OPENINGS ARE:

Continuous slot Mill slot Gauze wrapped Torch cut Drilled holes None (open hole)

Louvered shutter Key punched Wire wrapped Saw cut Other (specify)

SCREEN-PERFORATED INTERVALS: From..... 7.5 ft. to 115 ft., From ft. to ft.

From..... ft. to ft., From ft. to ft.

GRAVEL PACK INTERVALS: From..... 24 ft. to 115 ft., From ft. to ft.

From..... ft. to ft., From ft. to ft.

6 GROUT MATERIAL: Neat cement Cement grout Bentonite Other

Grout Intervals: From..... 7 ft. to 24 ft., From ft. to ft., From ft. to ft.

What is the nearest source of possible contamination:

Septic tank Lateral lines Pit privy Livestock pens Insecticide storage Other (specify below)

Sewer lines Cesspool Sewage lagoon Fuel storage Abandoned water well

Watertight sewer lines Seepage pit Feedyard Fertilizer storage Oil well/gas well

Direction from well North Distance from well 15'

FROM	TO	LITHOLOGIC LOG	FROM	TO	LITHO. LOG (cont.) or PLUGGING INTERVALS
<u>0</u>	<u>30</u>	<u>Tan clay</u>			
<u>30</u>	<u>54</u>	<u>Tan Sandy clay</u>			
<u>54</u>	<u>65</u>	<u>Tan Sandy clay & white rock</u>			
<u>65</u>	<u>115</u>	<u>med sand</u>			

7 CONTRACTOR'S OR LANDOWNER'S CERTIFICATION: This water well was constructed, reconstructed, or plugged under my jurisdiction and was completed on (mo/day/year) 12/12/12, and this record is true to the best of my knowledge and belief.

Kansas Water Well Contractor's License No. 533 This Water Well Record was completed on (mo/day/year) 10/6/13 under the business name of Jantzen Water Well by (signature) [Signature]

INSTRUCTIONS: Use typewriter or ball point pen. PLEASE PRESS FIRMLY and PRINT clearly. Please fill in blanks and check the correct answers. Send three copies (white, blue, pink) to Kansas Department of Health and Environment, Bureau of Water, Geology Section, 1000 SW Jackson St., Suite 420, Topeka, Kansas 66612-1367. Telephone 785-296-5524. Send one copy to WATER WELL OWNER and retain one for your records. Include fee of \$5.00 for each constructed well. Visit us at <http://www.kdheks.gov/waterwell/index.html>.