

**1 LOCATION OF WATER WELL:** Fraction NW 1/4 NW 1/4 SW 1/4 Section Number 13 Township Number 23 Range Number 35 E/W  
 County: Kearney

Distance and direction from nearest town or city street address of well if located within city? From Deerfield, approx. 3 1/2 mi. North

**2 WATER WELL OWNER:** Garden City Company **Global Positioning System** (decimal degrees, min. of 4 digits)  
 RR#, St. Address, Box #: PO Box 597 Latitude: \_\_\_\_\_  
 City, State, ZIP Code: Garden City, Ks, 67846 Longitude: \_\_\_\_\_  
 Elevation: \_\_\_\_\_  
 Datum: \_\_\_\_\_  
 Data Collection Method: \_\_\_\_\_

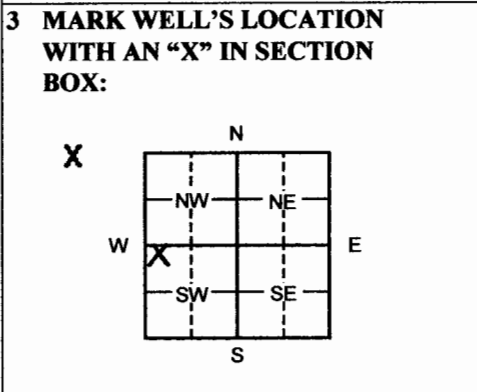

**4 DEPTH OF WELL** 309 ft.  
 WELL'S STATIC WATER LEVEL 153 ft.  
 WELL WAS USED AS:  
 1 Domestic      5 Public Water Supply      9 Dewatering  
 2 Irrigation     6 Oil Field Water Supply     10 Monitoring  
 3 Feedlot       7 Domestic (Lawn & Garden)   11 Injection Well  
 4 Industrial     8 Air Conditioning            12 Other \_\_\_\_\_  
 Was a chemical/bacteriological sample submitted to Department? Yes \_\_\_ No x

**5 TYPE OF BLANK CASING USED:**  
 1 Steel      3 RMP (SR)      5 Wrought      7 Fiberglass      9 Other (Specify below)  
 2 PVC      4 ABS            6 Asbestos-Cement      8 Concrete Tile

Blank casing diameter 16 in. Was casing pulled? Yes \_\_\_ No x If yes, how much \_\_\_\_\_  
 Casing height above or below land surface -48 in.

**6 GROUT PLUG MATERIAL:** 1 Neat cement      2 Cement grout      3 Bentonite      4 Other \_\_\_\_\_

Grout Plug Intervals: From 4 ft. to 14 ft., From \_\_\_\_\_ ft. to \_\_\_\_\_ ft., From \_\_\_\_\_ to \_\_\_\_\_ ft.

What is the nearest source of possible contamination:  
 1 Septic tank      6 Seepage pit      11 Fuel Storage      16 Other (specify below)  
 2 Sewer lines     7 Pit privy        12 Fertilizer storage  
 3 Watertight sewer lines   8 Sewage lagoon   13 Insecticide storage  
 4 Lateral lines     9 Feedyard        14 Abandoned water well      Direction from well? North  
 5 Cess pool        10 Livestock pens   15 Oil well/Gas well      How many feet? 70

FROM	TO	PLUGGING MATERIALS	FROM	TO	PLUGGING MATERIALS
0	4	Backfill			
4	14	Cement			
14	153	Clay			
153	309	Sand			

**7 CONTRACTOR'S OR LANDOWNER'S CERTIFICATION:** This water well was plugged under my jurisdiction and was completed on (mo/day/year) 11/25/08 and this record is true to the best of my knowledge and belief. Kansas Water Well Contractor's License No. 145. This Water Well Record was completed on (mo/day/year) 12/19/08 under the business name of Henkle Drilling & Supply Co., Inc. by (signature) [Signature]

**INSTRUCTIONS:** Please fill in blanks or circle the correct answers. Send top three copies to Kansas Department of Health and Environment, Bureau of Water, Geology Section, 1000 SW Jackson St., Ste. 420, Topeka, Kansas 66612-1367. Telephone: 785/296-5522. Send one to Water Well Owner and retain one for your records. Visit us at <http://www.kdheks.gov/waterwell>.