

# WATER WELL PLUGGING RECORD Form WWC-5P

KSA 82a-1212

ID NO.

MW-18

<b>1 LOCATION OF WATER WELL:</b> County: <u>Reno</u>	Fraction <u>SE 1/4 NE 1/4 SE 1/4 SW 1/4</u>	Section Number <u>9</u>	Township Number <u>T 23 S</u>	Range Number <u>5</u> <input type="checkbox"/> E <input checked="" type="checkbox"/> W
---	--	----------------------------	----------------------------------	---

Street/Rural Address of Well Location; if unknown, distance & direction from nearest town or intersection: If at owner's address, check here ☒ 2700 E. 4th Avenue  
Hutchinson, KS 67501

## Global Positioning Systems (GPS) information:

Latitude: 38.05928 (in decimal degrees)

Longitude: -97.87612 (in decimal degrees)

Elevation: 1521.25

Horizontal Datum: ☐ WGS84, ☐ NAD83, ☒ NAD27

Collection Method:

☒ GPS unit (Make/Model: Garmin)

☐ Digital Map/Photo, ☐ Topographic Map, ☐ Land Survey

Est. Accuracy: ☐ < 3 m, ☐ 3-5 m, ☐ 5-15 m, ☐ > 15 m

**2 WATER WELL OWNER:** Dillons Distribution Center  
RR#, St. Address, Box #: 2700 E. 4th Avenue  
City, State ZIP Code: Hutchinson, KS 67501

## 3 MARK WELL'S LOCATION WITH AN "X" IN SECTION BOX:

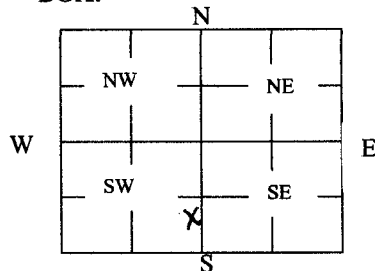

## 4 DEPTH OF WELL 19.71 ft.

WELL'S STATIC WATER LEVEL 10.64 ft

WELL WAS USED AS:

☐ Domestic  
☐ Irrigation  
☐ Feedlot  
☐ Industrial

☐ Public Water Supply  
☐ Oil Field Water Supply  
☐ Domestic (Lawn & Garden)  
☐ Air Conditioning

☒ Dewatering  
☐ Monitoring  
☐ Injection Well  
☐ Other \_\_\_\_\_

Was a chemical/bacteriological sample submitted to Department? Yes ☐ No ☒

## 5 TYPE OF BLANK CASING USED:

☐ Steel  
☒ PVC

☐ RMP (SR)  
☐ ABS

☐ Wrought  
☐ Asbestos-Cement

☐ Fiberglass  
☐ Concrete Tile

☐ Other (Specify below) \_\_\_\_\_

Blank casing diameter 2.0 in. Was casing pulled? Yes ☒ No ☐ If yes, how much 3.0 ft.  
Casing height above or below land surface 3.72 in.

## 6 GROUT PLUG MATERIAL: ☐ Neat cement ☐ Cement grout ☒ Bentonite ☐ Other \_\_\_\_\_

Grout Plug Intervals: From 19.71 ft. to 3.0 ft., From \_\_\_\_\_ ft. to \_\_\_\_\_ ft., From \_\_\_\_\_ ft. to \_\_\_\_\_ ft.

What is the nearest source of possible contamination:

☐ Septic tank  
☐ Sewer lines  
☐ Watertight sewer lines  
☐ Lateral lines  
☐ Cess pool

☐ Seepage pit  
☐ Pit privy  
☐ Sewage lagoon  
☐ Feedyard  
☐ Livestock pens

☒ Fuel storage  
☐ Fertilizer storage  
☐ Insecticide storage  
☐ Abandoned water well  
☐ Oil well/Gas well

☐ Other (specify below) \_\_\_\_\_

Direction from well? West

How many feet? 340 ft.

FROM	TO	PLUGGING MATERIALS	FROM	TO	PLUGGING MATERIALS
19.71	3.00	Hydrated Bentonite			
3.00	Grade	Bag Topsoil			

**7 CONTRACTOR'S OR LANDOWNER'S CERTIFICATION:** This water well was plugged under my jurisdiction and was completed on (mo/day/year) 10/18/18 and this record is true to the best of my knowledge and belief. Kansas Water Well Contractor's License No. 337 LG. This Water Well Record was completed on (mo/day/year) 10/31/18 under the business name of Knightly Environmental Inc. by (signature) [Signature]

Send one white copy to Kansas Department of Health & Environment, Geology Section, 1000 SW Jackson Street, Ste. 420, Topeka, KS 66612-1367. Send one copy to WATER WELL OWNER and retain one for your records.  
Visit us at <http://www.kdheks.gov/waterwell/index.html> Telephone 785-296-5524.

KSA82a-1212

Revised 1/20/2015

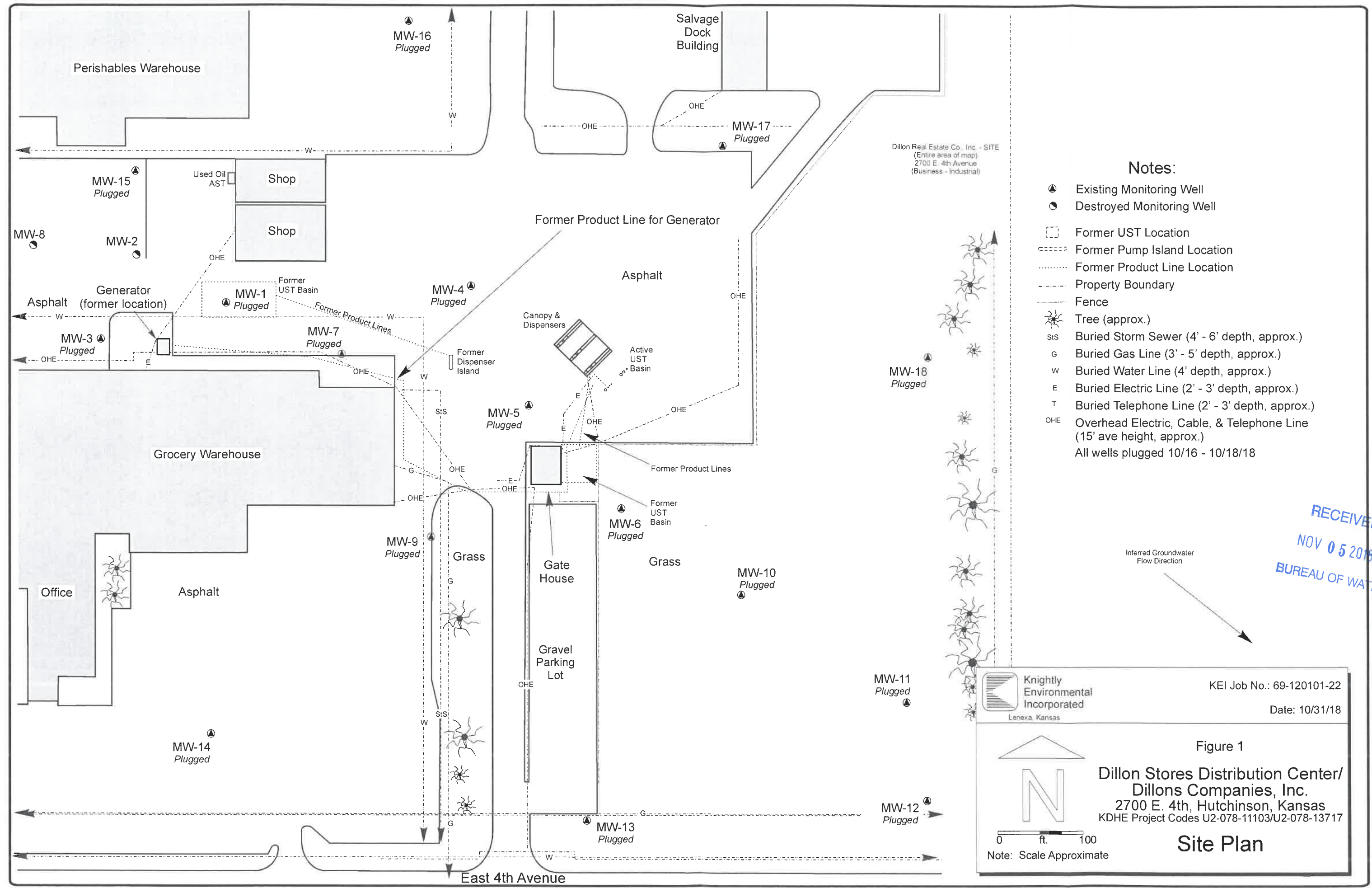

Notes:

- Existing Monitoring Well
- Destroyed Monitoring Well
- Former UST Location
- Former Pump Island Location
- Former Product Line Location
- Property Boundary
- Fence
- Tree (approx.)
- SIS Buried Storm Sewer (4' - 6' depth, approx.)
- G Buried Gas Line (3' - 5' depth, approx.)
- W Buried Water Line (4' depth, approx.)
- E Buried Electric Line (2' - 3' depth, approx.)
- T Buried Telephone Line (2' - 3' depth, approx.)
- OHE Overhead Electric, Cable, & Telephone Line (15' ave height, approx.)
- All wells plugged 10/16 - 10/18/18

RECEIVED  
NOV 05 2018  
BUREAU OF WATER

Knightly Environmental Incorporated  
Lenexa, Kansas

KEI Job No.: 69-120101-22  
Date: 10/31/18

Figure 1  
Dillon Stores Distribution Center/  
Dillons Companies, Inc.  
2700 E. 4th, Hutchinson, Kansas  
KDHE Project Codes U2-078-11103/U2-078-13717

Site Plan

0 ft. 100  
Note: Scale Approximate