

WATER WELL PLUGGING RECORD Form WWC-5P

KSA 82a-1212

ID NO.

MW-16

1 LOCATION OF WATER WELL: County: Reno	Fraction SW 1/4 NE 1/4 SE 1/4 SW 1/4	Section Number 9	Township Number T 23 S	Range Number 5 <input type="checkbox"/> E <input checked="" type="checkbox"/> W
---	--	----------------------------	----------------------------------	---

Street/Rural Address of Well Location; if unknown, distance & direction from nearest town or intersection: If at owner's address, check here ☒ **2700 E. 4th Avenue Hutchinson, KS 67501**

Global Positioning Systems (GPS) information:

Latitude: **38.06038** (in decimal degrees)
Longitude: **-97.87821** (in decimal degrees)
Elevation: **1522.90**
Horizontal Datum: ☐ WGS84, ☐ NAD83, ☒ NAD27
Collection Method:

☒ GPS unit (Make/Model: **Garmin**)
☐ Digital Map/Photo, ☐ Topographic Map, ☐ Land Survey

Est. Accuracy: ☐ < 3 m, ☐ 3-5 m, ☐ 5-15 m, ☐ > 15 m

3 MARK WELL'S LOCATION WITH AN "X" IN SECTION BOX:

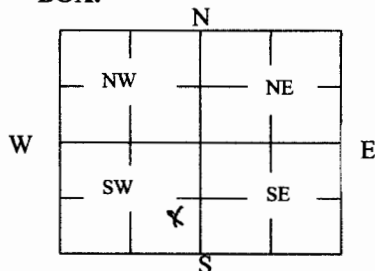

4 DEPTH OF WELL **20.06** ft.

WELL'S STATIC WATER LEVEL **11.85** ft

WELL WAS USED AS:

<input type="checkbox"/> Domestic	<input type="checkbox"/> Public Water Supply	<input type="checkbox"/> Dewatering
<input type="checkbox"/> Irrigation	<input type="checkbox"/> Oil Field Water Supply	<input checked="" type="checkbox"/> Monitoring
<input type="checkbox"/> Feedlot	<input type="checkbox"/> Domestic (Lawn & Garden)	<input type="checkbox"/> Injection Well
<input type="checkbox"/> Industrial	<input type="checkbox"/> Air Conditioning	<input type="checkbox"/> Other

Was a chemical/bacteriological sample submitted to Department? Yes ☐ No ☒

5 TYPE OF BLANK CASING USED:

☐ Steel ☐ RMP (SR) ☐ Wrought ☐ Fiberglass ☐ Other (Specify below)
☒ PVC ☐ ABS ☐ Asbestos-Cement ☐ Concrete Tile

Blank casing diameter **2.0** in. Was casing pulled? Yes ☒ No ☐ If yes, how much **3.0** ft.
Casing height above or below land surface **2.76** in.

6 GROUT PLUG MATERIAL: ☐ Neat cement ☐ Cement grout ☒ Bentonite ☐ Other

Grout Plug Intervals: From **20.06** ft. to **3.0** ft., From _____ ft. to _____ ft., From _____ ft. to _____ ft.

What is the nearest source of possible contamination:

<input type="checkbox"/> Septic tank	<input type="checkbox"/> Seepage pit	<input checked="" type="checkbox"/> Fuel storage	<input type="checkbox"/> Other (specify below)
<input type="checkbox"/> Sewer lines	<input type="checkbox"/> Pit privy	<input type="checkbox"/> Fertilizer storage	
<input type="checkbox"/> Watertight sewer lines	<input type="checkbox"/> Sewage lagoon	<input type="checkbox"/> Insecticide storage	
<input type="checkbox"/> Lateral lines	<input type="checkbox"/> Feedyard	<input type="checkbox"/> Abandoned water well	Direction from well? Southeast
<input type="checkbox"/> Cess pool	<input type="checkbox"/> Livestock pens	<input type="checkbox"/> Oil well/Gas well	How many feet? 480 ft.

FROM	TO	PLUGGING MATERIALS	FROM	TO	PLUGGING MATERIALS
20.06	3.00	Hydrated Bentonite			
3.00	Grade	Bag Topsoil			

7 CONTRACTOR'S OR LANDOWNER'S CERTIFICATION: This water well was plugged under my jurisdiction and was completed on (mo/day/year) **10/18/18** and this record is true to the best of my knowledge and belief. Kansas Water Well Contractor's License No. **337 LG**. This Water Well Record was completed on (mo/day/year) **10/31/18** under the business name of **Knightly Environmental Inc.** by (signature) *[Signature]*

Send one white copy to Kansas Department of Health & Environment, Geology Section, 1000 SW Jackson Street, Ste. 420, Topeka, KS 66612-1367. Send one copy to WATER WELL OWNER and retain one for your records.
Visit us at <http://www.kdheks.gov/waterwell/index.html> Telephone 785-296-5524.

KSA82a-1212

Revised 1/20/2015

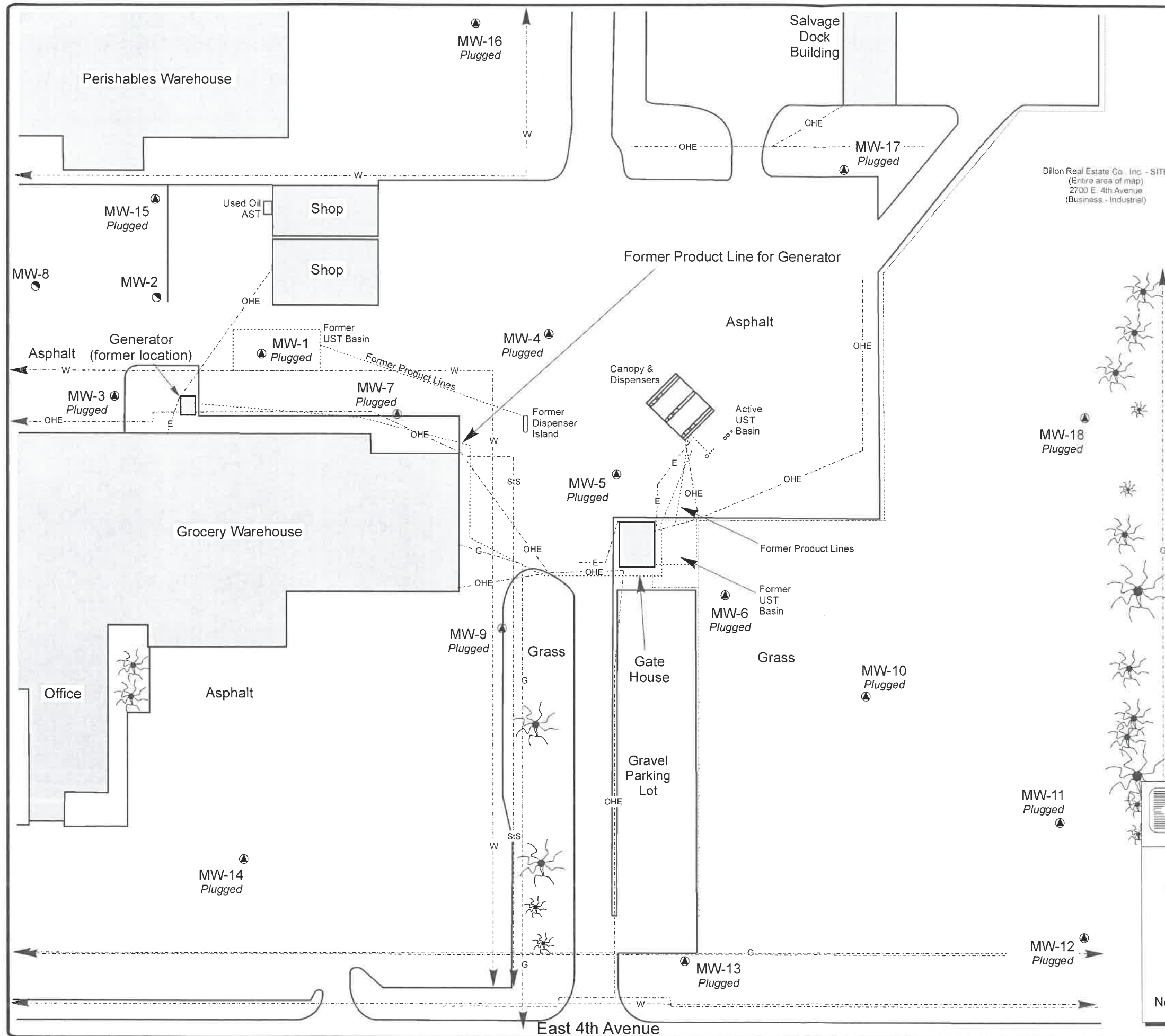

Notes:

- Existing Monitoring Well
- Destroyed Monitoring Well
- Former UST Location
- Former Pump Island Location
- Former Product Line Location
- Property Boundary
- Fence
- 🌳 Tree (approx.)
- sis Buried Storm Sewer (4' - 6' depth, approx.)
- G Buried Gas Line (3' - 5' depth, approx.)
- W Buried Water Line (4' depth, approx.)
- E Buried Electric Line (2' - 3' depth, approx.)
- T Buried Telephone Line (2' - 3' depth, approx.)
- OHE Overhead Electric, Cable, & Telephone Line (15' ave height, approx.)
- All wells plugged 10/16 - 10/18/18

Inferred Groundwater Flow Direction

RECEIVED
NOV 05 2018
BUREAU OF WATER

Knightly
Environmental
Incorporated
Lenexa, Kansas

KEI Job No.: 69-120101-22

Date: 10/31/18

Figure 1

Dillon Stores Distribution Center/
Dillons Companies, Inc.
2700 E. 4th, Hutchinson, Kansas
KDHE Project Codes U2-078-11103/U2-078-13717

Site Plan

0 ft. 100
Note: Scale Approximate