

WATER WELL PLUGGING RECORD Form WWC-5P

KSA 82a-1212

ID NO.

MW-6

1 LOCATION OF WATER WELL: County: <u>Reno</u>	Fraction <u>SE 1/4 NW 1/4 SE 1/4 SW 1/4</u>	Section Number <u>9</u>	Township Number <u>T 23 S</u>	Range Number <u>5</u> <input type="checkbox"/> E <input checked="" type="checkbox"/> W
Street/Rural Address of Well Location; if unknown, distance & direction from nearest town or intersection: If at owner's address, check here <input checked="" type="checkbox"/> <u>2700 E. 4th Avenue</u> <u>Hutchinson, KS 67501</u>		Global Positioning Systems (GPS) information: Latitude: <u>38.05882</u> (in decimal degrees) Longitude: <u>-97.87738</u> (in decimal degrees) Elevation: <u>1522.87</u> Horizontal Datum: <input type="checkbox"/> WGS84, <input type="checkbox"/> NAD83, <input checked="" type="checkbox"/> NAD27 Collection Method: <input checked="" type="checkbox"/> GPS unit (Make/Model: <u>Garmin</u>) <input type="checkbox"/> Digital Map/Photo, <input type="checkbox"/> Topographic Map, <input type="checkbox"/> Land Survey Est. Accuracy: <input type="checkbox"/> < 3 m, <input type="checkbox"/> 3-5 m, <input type="checkbox"/> 5-15 m, <input type="checkbox"/> > 15 m		
2 WATER WELL OWNER: <u>Dillons Distribution Center</u> RR#, St. Address, Box #: <u>2700 E. 4th Avenue</u> City, State ZIP Code: <u>Hutchinson, KS 67501</u>				

3 MARK WELL'S LOCATION WITH AN "X" IN SECTION BOX: 	4 DEPTH OF WELL <u>20.39</u> ft. WELL'S STATIC WATER LEVEL <u>12.31</u> ft WELL WAS USED AS: <input type="checkbox"/> Domestic <input type="checkbox"/> Public Water Supply <input checked="" type="checkbox"/> Dewatering <input type="checkbox"/> Irrigation <input type="checkbox"/> Oil Field Water Supply <input type="checkbox"/> Monitoring <input type="checkbox"/> Feedlot <input type="checkbox"/> Domestic (Lawn & Garden) <input type="checkbox"/> Injection Well <input type="checkbox"/> Industrial <input type="checkbox"/> Air Conditioning <input type="checkbox"/> Other _____ Was a chemical/bacteriological sample submitted to Department? Yes <input type="checkbox"/> No <input checked="" type="checkbox"/>
---	---

5 TYPE OF BLANK CASING USED:

☐ Steel ☐ RMP (SR) ☐ Wrought ☐ Fiberglass ☐ Other (Specify below)
☒ PVC ☐ ABS ☐ Asbestos-Cement ☐ Concrete Tile

Blank casing diameter 2.0 in. Was casing pulled? Yes ☒ No ☐ If yes, how much 3.0 ft.

Casing height above or below land surface 3.60 in.

6 GROUT PLUG MATERIAL: ☐ Neat cement ☐ Cement grout ☒ Bentonite ☐ Other _____

Grout Plug Intervals: From 20.39 ft. to 3.0 ft., From _____ ft. to _____ ft., From _____ ft. to _____ ft.

What is the nearest source of possible contamination:

<input type="checkbox"/> Septic tank	<input type="checkbox"/> Seepage pit	<input checked="" type="checkbox"/> Fuel storage	<input type="checkbox"/> Other (specify below) _____
<input type="checkbox"/> Sewer lines	<input type="checkbox"/> Pit privy	<input type="checkbox"/> Fertilizer storage	
<input type="checkbox"/> Watertight sewer lines	<input type="checkbox"/> Sewage lagoon	<input type="checkbox"/> Insecticide storage	
<input type="checkbox"/> Lateral lines	<input type="checkbox"/> Feedyard	<input type="checkbox"/> Abandoned water well	
<input type="checkbox"/> Cess pool	<input type="checkbox"/> Livestock pens	<input type="checkbox"/> Oil well/Gas well	

Direction from well? North
How many feet? 140 ft.

FROM	TO	PLUGGING MATERIALS	FROM	TO	PLUGGING MATERIALS
20.39	3.00	Hydrated Bentonite			
3.00	Grade	Bag Topsoil			

7 CONTRACTOR'S OR LANDOWNER'S CERTIFICATION: This water well was plugged under my jurisdiction and was completed on (mo/day/year) 10/17/18 and this record is true to the best of my knowledge and belief. Kansas Water Well Contractor's License No. 337 LG. This Water Well Record was completed on (mo/day/year) 10/31/18 under the business name of Knightly Environmental Inc. by (signature) [Signature]

Send one white copy to Kansas Department of Health & Environment, Geology Section, 1000 SW Jackson Street, Ste. 420, Topeka, KS 66612-1367. Send one copy to WATER WELL OWNER and retain one for your records.
Visit us at <http://www.kdheks.gov/waterwell/index.html> Telephone 785-296-5524.

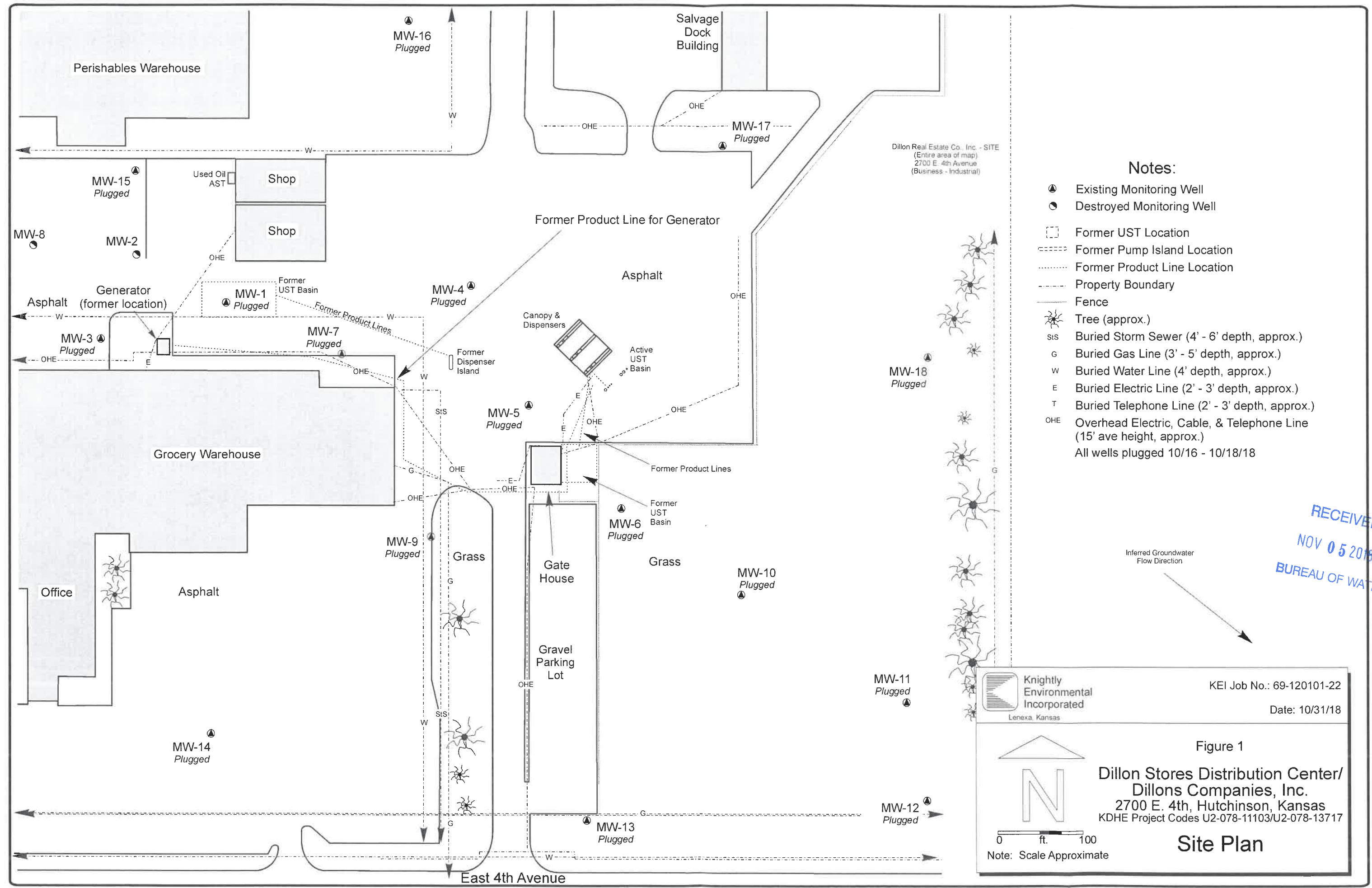

Notes:

- Existing Monitoring Well
- Destroyed Monitoring Well
- Former UST Location
- Former Pump Island Location
- Former Product Line Location
- Property Boundary
- Fence
- Tree (approx.)
- StS Buried Storm Sewer (4' - 6' depth, approx.)
- G Buried Gas Line (3' - 5' depth, approx.)
- W Buried Water Line (4' depth, approx.)
- E Buried Electric Line (2' - 3' depth, approx.)
- T Buried Telephone Line (2' - 3' depth, approx.)
- OHE Overhead Electric, Cable, & Telephone Line (15' ave height, approx.)
- All wells plugged 10/16 - 10/18/18

RECEIVED
NOV 05 2018
BUREAU OF WATER



Knightly
Environmental
Incorporated
Lenexa, Kansas

KEI Job No.: 69-120101-22
Date: 10/31/18

Figure 1
Dillon Stores Distribution Center/
Dillons Companies, Inc.
2700 E. 4th, Hutchinson, Kansas
KDHE Project Codes U2-078-11103/U2-078-13717

Site Plan