

WATER WELL PLUGGING RECORD Form WWC-5P

KSA 82a-1212

ID NO.

MW-12

1 LOCATION OF WATER WELL: County: Reno	Fraction SE ¼ SE ¼ SE ¼ SW ¼	Section Number 9	Township Number T 23 S	Range Number 5 <input type="checkbox"/> E <input checked="" type="checkbox"/> W
--------------------------------------------------	---------------------------------	---------------------	---------------------------	------------------------------------------------------------------------------------

Street/Rural Address of Well Location; if unknown, distance & direction from nearest town or intersection: If at owner's address, check here ☒ 2700 E. 4th Avenue
Hutchinson, KS 67501

Global Positioning Systems (GPS) information:

Latitude: 38.05785 (in decimal degrees)
Longitude: -97.87614 (in decimal degrees)
Elevation: 1520.17
Horizontal Datum: ☐ WGS84, ☐ NAD83, ☒ NAD27
Collection Method:

☒ GPS unit (Make/Model: Garmin
☐ Digital Map/Photo, ☐ Topographic Map, ☐ Land Survey

Est. Accuracy: ☐ < 3 m, ☐ 3-5 m, ☐ 5-15 m, ☐ > 15 m

2 WATER WELL OWNER: Dillons Distribution Center
RR#, St. Address, Box #: 2700 E. 4th Avenue
City, State ZIP Code: Hutchinson, KS 67501

3 MARK WELL'S LOCATION WITH AN "X" IN SECTION BOX:

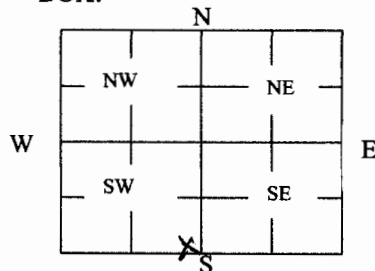

4 DEPTH OF WELL 19.64 ft.

WELL'S STATIC WATER LEVEL 9.92 ft

WELL WAS USED AS:

- | | | |
|-------------------------------------|---------------------------------------------------|------------------------------------------------|
| <input type="checkbox"/> Domestic | <input type="checkbox"/> Public Water Supply | <input type="checkbox"/> Dewatering |
| <input type="checkbox"/> Irrigation | <input type="checkbox"/> Oil Field Water Supply | <input checked="" type="checkbox"/> Monitoring |
| <input type="checkbox"/> Feedlot | <input type="checkbox"/> Domestic (Lawn & Garden) | <input type="checkbox"/> Injection Well |
| <input type="checkbox"/> Industrial | <input type="checkbox"/> Air Conditioning | <input type="checkbox"/> Other |

Was a chemical/bacteriological sample submitted to Department? Yes ☐ No ☒

5 TYPE OF BLANK CASING USED:

- ☐ Steel ☐ RMP (SR) ☐ Wrought ☐ Fiberglass ☐ Other (Specify below)
☒ PVC ☐ ABS ☐ Asbestos-Cement ☐ Concrete Tile

Blank casing diameter 2.0 in. Was casing pulled? Yes ☒ No ☐ If yes, how much 3.0 ft.
Casing height above or below land surface 2.28 in.

6 GROUT PLUG MATERIAL: ☐ Neat cement ☐ Cement grout ☒ Bentonite ☐ Other

Grout Plug Intervals: From 19.64 ft. to 3.0 ft., From ft. to ft., From ft. to ft.

What is the nearest source of possible contamination:

- | | | | |
|-------------------------------------------------|-----------------------------------------|--------------------------------------------------|------------------------------------------------|
| <input type="checkbox"/> Septic tank | <input type="checkbox"/> Seepage pit | <input checked="" type="checkbox"/> Fuel storage | <input type="checkbox"/> Other (specify below) |
| <input type="checkbox"/> Sewer lines | <input type="checkbox"/> Pit privy | <input type="checkbox"/> Fertilizer storage | |
| <input type="checkbox"/> Watertight sewer lines | <input type="checkbox"/> Sewage lagoon | <input type="checkbox"/> Insecticide storage | |
| <input type="checkbox"/> Lateral lines | <input type="checkbox"/> Feedyard | <input type="checkbox"/> Abandoned water well | Direction from well? Northwest |
| <input type="checkbox"/> Cess pool | <input type="checkbox"/> Livestock pens | <input type="checkbox"/> Oil well/Gas well | How many feet? 610 ft. |

FROM	TO	PLUGGING MATERIALS	FROM	TO	PLUGGING MATERIALS
19.64	3.00	Hydrated Bentonite			
3.00	Grade	Bag Topsoil			

7 CONTRACTOR'S OR LANDOWNER'S CERTIFICATION: This water well was plugged under my jurisdiction and was completed on (mo/day/year) 10/18/18 and this record is true to the best of my knowledge and belief. Kansas Water Well Contractor's License No. 337 LG. This Water Well Record was completed on (mo/day/year) 10/31/18 under the business name of Knightly Environmental Inc. by (signature) *Paul Knightly*

Send one white copy to Kansas Department of Health & Environment, Geology Section, 1000 SW Jackson Street, Ste. 420, Topeka, KS 66612-1367. Send one copy to WATER WELL OWNER and retain one for your records.
Visit us at <http://www.kdheks.gov/waterwell/index.html> Telephone 785-296-5524.

KSA82a-1212

Revised 1/20/2015

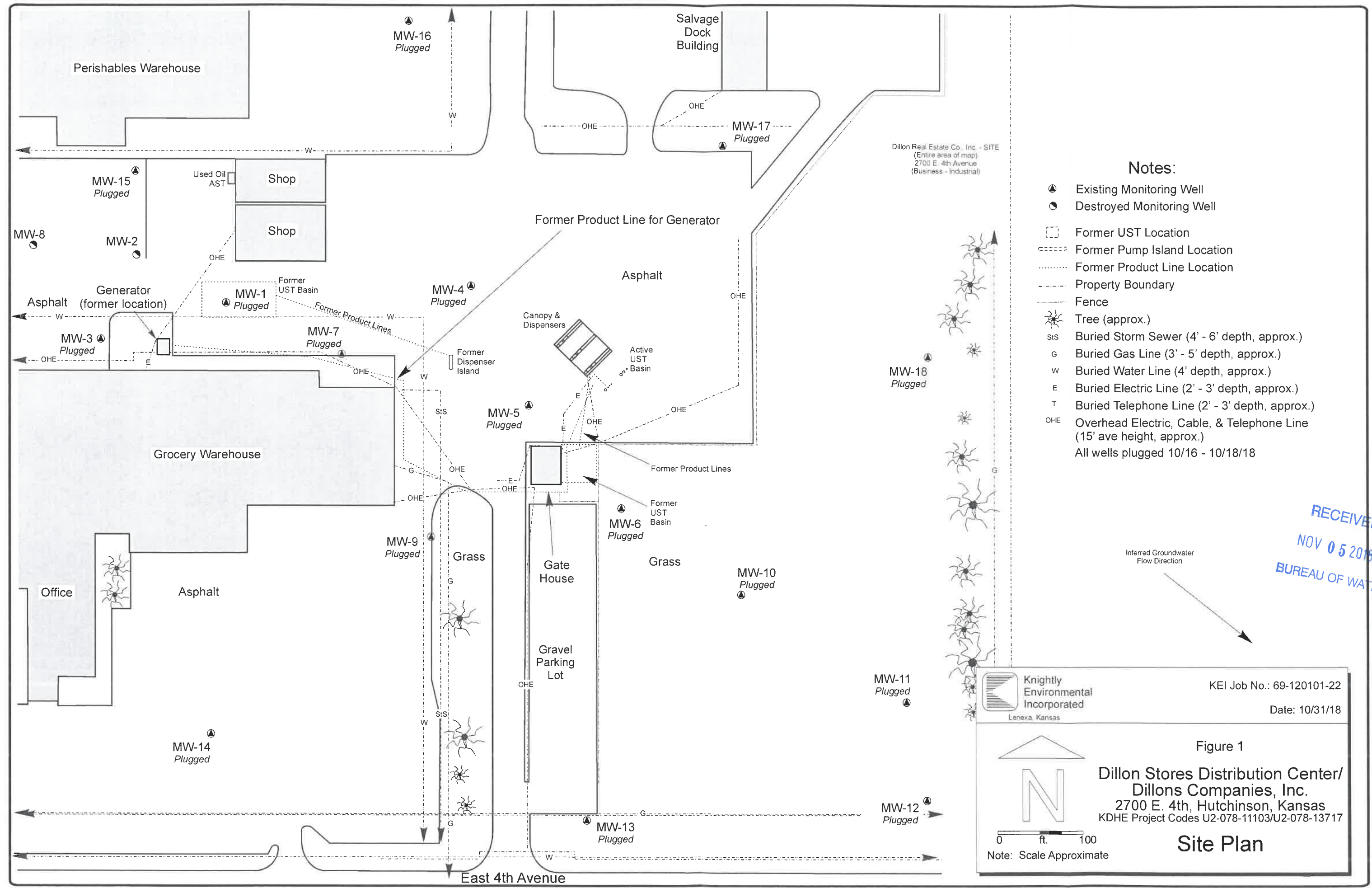

Notes:

- Existing Monitoring Well
- Destroyed Monitoring Well
- Former UST Location
- Former Pump Island Location
- Former Product Line Location
- Property Boundary
- Fence
- Tree (approx.)
- StS Buried Storm Sewer (4' - 6' depth, approx.)
- G Buried Gas Line (3' - 5' depth, approx.)
- W Buried Water Line (4' depth, approx.)
- E Buried Electric Line (2' - 3' depth, approx.)
- T Buried Telephone Line (2' - 3' depth, approx.)
- OHE Overhead Electric, Cable, & Telephone Line (15' ave height, approx.)
- All wells plugged 10/16 - 10/18/18

RECEIVED
NOV 05 2018
BUREAU OF WATER

Knightly Environmental Incorporated
Lenexa, Kansas

KEI Job No.: 69-120101-22
Date: 10/31/18

Figure 1
Dillon Stores Distribution Center/
Dillons Companies, Inc.
2700 E. 4th, Hutchinson, Kansas
KDHE Project Codes U2-078-11103/U2-078-13717

Site Plan

0 ft. 100
Note: Scale Approximate