

## WATER WELL PLUGGING RECORD Form WWC-5P

KSA 82a-1212

ID NO.

MW-14

<b>1 LOCATION OF WATER WELL:</b> County: <u>Reno</u> Street/Rural Address of Well Location; if unknown, distance & direction from nearest town or intersection: If at owner's address, check here <input checked="" type="checkbox"/> <u>2700 E. 4th Avenue</u> <u>Hutchinson, KS 67501</u>	Fraction <u>SW 1/4 SW 1/4 SE 1/4 SW 1/4</u> Section Number <u>9</u> Township Number <u>T 23 S</u> Range Number <u>5</u> <input type="checkbox"/> E <input checked="" type="checkbox"/> W	<b>Global Positioning Systems (GPS) information:</b> Latitude: <u>38.05814</u> (in decimal degrees) Longitude: <u>-97.87901</u> (in decimal degrees) Elevation: <u>1521.14</u> Horizontal Datum: <input type="checkbox"/> WGS84, <input type="checkbox"/> NAD83, <input checked="" type="checkbox"/> NAD27 Collection Method: <input checked="" type="checkbox"/> GPS unit (Make/Model: <u>Garmin</u> ) <input type="checkbox"/> Digital Map/Photo, <input type="checkbox"/> Topographic Map, <input type="checkbox"/> Land Survey Est. Accuracy: <input type="checkbox"/> < 3 m, <input type="checkbox"/> 3-5 m, <input type="checkbox"/> 5-15 m, <input type="checkbox"/> > 15 m																																																
<b>2 WATER WELL OWNER:</b> <u>Dillons Distribution Center</u> <u>RR#, St. Address, Box #: 2700 E. 4th Avenue</u> <u>City, State ZIP Code: Hutchinson, KS 67501</u>	<b>3 MARK WELL'S LOCATION WITH AN "X" IN SECTION BOX:</b> <div style="text-align: center;"> </div>																																																	
<b>4 DEPTH OF WELL</b> <u>20.21</u> ft. WELL'S STATIC WATER LEVEL <u>10.49</u> ft. WELL WAS USED AS: <div style="display: flex; justify-content: space-between;"> <div style="width: 30%;"> <input type="checkbox"/> Domestic  <input type="checkbox"/> Irrigation  <input type="checkbox"/> Feedlot  <input type="checkbox"/> Industrial         </div> <div style="width: 30%;"> <input type="checkbox"/> Public Water Supply  <input type="checkbox"/> Oil Field Water Supply  <input type="checkbox"/> Domestic (Lawn &amp; Garden)  <input type="checkbox"/> Air Conditioning         </div> <div style="width: 30%;"> <input type="checkbox"/> Dewatering  <input checked="" type="checkbox"/> Monitoring  <input type="checkbox"/> Injection Well  <input type="checkbox"/> Other _____         </div> </div> Was a chemical/bacteriological sample submitted to Department? Yes <input type="checkbox"/> No <input checked="" type="checkbox"/>																																																		
<b>5 TYPE OF BLANK CASING USED:</b> <div style="display: flex; justify-content: space-between;"> <div style="width: 20%;"> <input type="checkbox"/> Steel  <input checked="" type="checkbox"/> PVC         </div> <div style="width: 20%;"> <input type="checkbox"/> RMP (SR)  <input type="checkbox"/> ABS         </div> <div style="width: 20%;"> <input type="checkbox"/> Wrought  <input type="checkbox"/> Asbestos-Cement         </div> <div style="width: 20%;"> <input type="checkbox"/> Fiberglass  <input type="checkbox"/> Concrete Tile         </div> <div style="width: 20%;"> <input type="checkbox"/> Other (Specify below) _____         </div> </div> Blank casing diameter <u>2.0</u> in. Was casing pulled? Yes <input checked="" type="checkbox"/> No <input type="checkbox"/> If yes, how much <u>3.0</u> ft. Casing height above or below land surface <u>3.00</u> in.																																																		
<b>6 GROUT PLUG MATERIAL:</b> <input type="checkbox"/> Neat cement <input type="checkbox"/> Cement grout <input checked="" type="checkbox"/> Bentonite <input type="checkbox"/> Other _____ Grout Plug Intervals: From <u>20.21</u> ft. to <u>3.0</u> ft., From _____ ft. to _____ ft., From _____ ft. to _____ ft. What is the nearest source of possible contamination: <div style="display: flex; justify-content: space-between;"> <div style="width: 30%;"> <input type="checkbox"/> Septic tank  <input type="checkbox"/> Sewer lines  <input type="checkbox"/> Watertight sewer lines  <input type="checkbox"/> Lateral lines  <input type="checkbox"/> Cess pool         </div> <div style="width: 30%;"> <input type="checkbox"/> Seepage pit  <input type="checkbox"/> Pit privy  <input type="checkbox"/> Sewage lagoon  <input type="checkbox"/> Feedyard  <input type="checkbox"/> Livestock pens         </div> <div style="width: 30%;"> <input checked="" type="checkbox"/> Fuel storage  <input type="checkbox"/> Fertilizer storage  <input type="checkbox"/> Insecticide storage  <input type="checkbox"/> Abandoned water well  <input type="checkbox"/> Oil well/Gas well         </div> </div> Direction from well? <u>Northeast</u> How many feet? <u>600</u> ft.																																																		
<table border="1" style="width:100%; border-collapse: collapse;"> <thead> <tr> <th>FROM</th> <th>TO</th> <th>PLUGGING MATERIALS</th> <th>FROM</th> <th>TO</th> <th>PLUGGING MATERIALS</th> </tr> </thead> <tbody> <tr> <td>20.21</td> <td>3.00</td> <td>Hydrated Bentonite</td> <td></td> <td></td> <td></td> </tr> <tr> <td>3.00</td> <td>0.5</td> <td>Bag Topsoil</td> <td></td> <td></td> <td></td> </tr> <tr> <td>0.5</td> <td>Grade</td> <td>Asphalt</td> <td></td> <td></td> <td></td> </tr> <tr><td> </td><td> </td><td> </td><td> </td><td> </td><td> </td></tr> <tr><td> </td><td> </td><td> </td><td> </td><td> </td><td> </td></tr> <tr><td> </td><td> </td><td> </td><td> </td><td> </td><td> </td></tr> <tr><td> </td><td> </td><td> </td><td> </td><td> </td><td> </td></tr> </tbody> </table>			FROM	TO	PLUGGING MATERIALS	FROM	TO	PLUGGING MATERIALS	20.21	3.00	Hydrated Bentonite				3.00	0.5	Bag Topsoil				0.5	Grade	Asphalt																											
FROM	TO	PLUGGING MATERIALS	FROM	TO	PLUGGING MATERIALS																																													
20.21	3.00	Hydrated Bentonite																																																
3.00	0.5	Bag Topsoil																																																
0.5	Grade	Asphalt																																																
<b>7 CONTRACTOR'S OR LANDOWNER'S CERTIFICATION:</b> This water well was plugged under my jurisdiction and was completed on (mo/day/year) <u>10/17/18</u> and this record is true to the best of my knowledge and belief. Kansas Water Well Contractor's License No. <u>337 LG</u> . This Water Well Record was completed on (mo/day/year) <u>10/31/18</u> under the business name of <u>Knightly Environmental Inc.</u> by (signature) <u>[Signature]</u>																																																		
Send one white copy to Kansas Department of Health & Environment, Geology Section, 1800 SW Jackson Street, Ste. 420, Topeka, KS 66612-1367. Send one copy to WATER WELL OWNER and retain one for your records. Visit us at <a href="http://www.kdheks.gov/waterwell/index.html">http://www.kdheks.gov/waterwell/index.html</a> Telephone 785-296-5524.																																																		

KSA82a-1212

Revised 1/20/2015

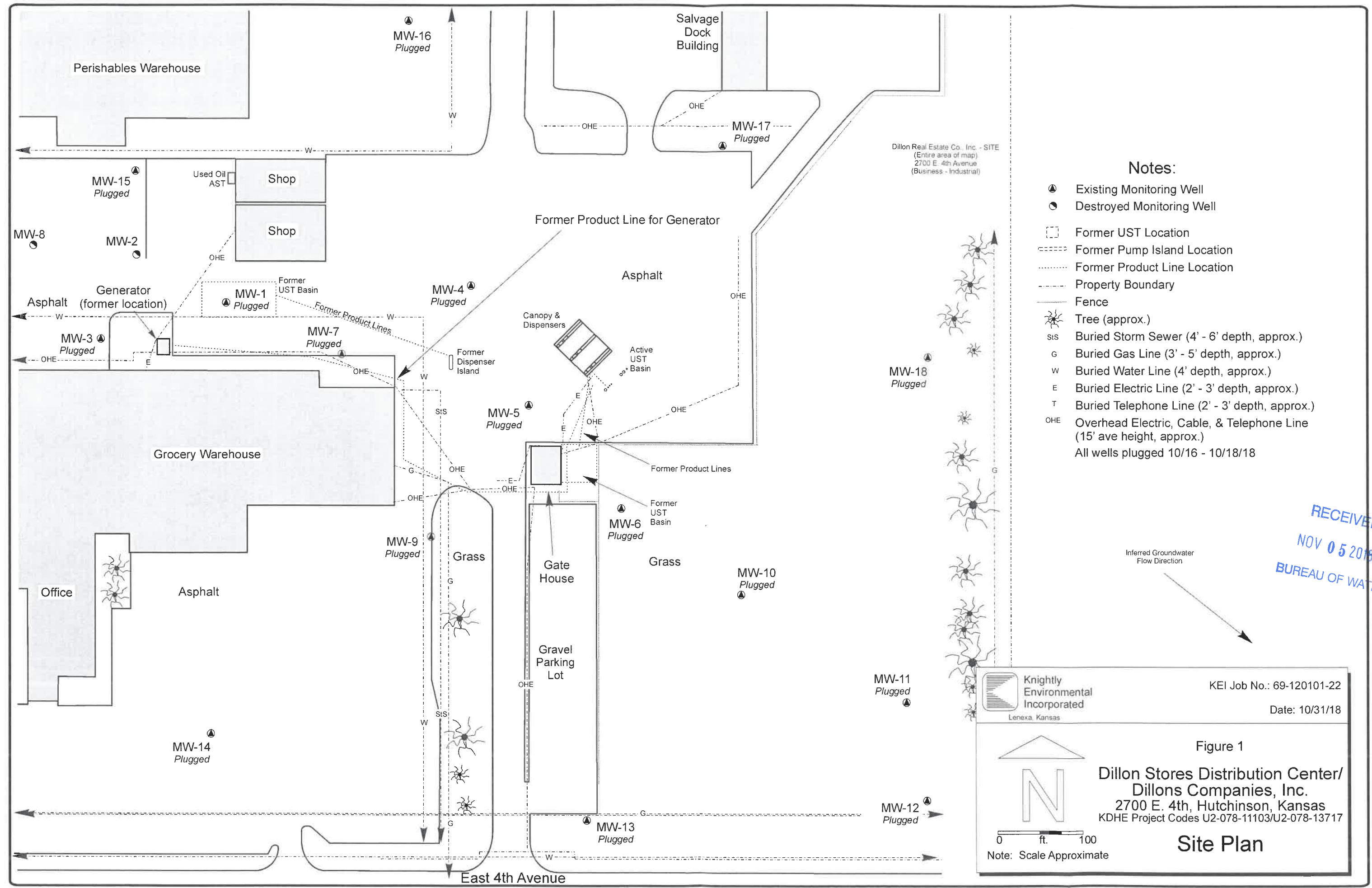

Notes:

- Existing Monitoring Well
- Destroyed Monitoring Well
- Former UST Location
- Former Pump Island Location
- Former Product Line Location
- Property Boundary
- Fence
- Tree (approx.)
- SIS Buried Storm Sewer (4' - 6' depth, approx.)
- G Buried Gas Line (3' - 5' depth, approx.)
- W Buried Water Line (4' depth, approx.)
- E Buried Electric Line (2' - 3' depth, approx.)
- T Buried Telephone Line (2' - 3' depth, approx.)
- OHE Overhead Electric, Cable, & Telephone Line (15' ave height, approx.)
- All wells plugged 10/16 - 10/18/18

RECEIVED  
NOV 05 2018  
BUREAU OF WATER

Knightly Environmental Incorporated  
Lenexa, Kansas

KEI Job No.: 69-120101-22  
Date: 10/31/18

Figure 1  
Dillon Stores Distribution Center/  
Dillons Companies, Inc.  
2700 E. 4th, Hutchinson, Kansas  
KDHE Project Codes U2-078-11103/U2-078-13717

Site Plan

0 ft. 100  
Note: Scale Approximate