

# WATER WELL PLUGGING RECORD Form WWC-5P

KSA 82a-1212

ID NO.

MW-3

|   |                                 |   |                           |  |
|---|---------------------------------|---|---------------------------|--|
| <b>1 LOCATION OF WATER WELL:</b><br>County: Reno  | Fraction<br>NW ¼ SW ¼ SE ¼ SW ¼ | Section Number<br>9   | Township Number<br>T 23 S | Range Number<br>5 <input type="checkbox"/> E <input checked="" type="checkbox"/> W |
| Street/Rural Address of Well Location; if unknown, distance & direction from nearest town or intersection: If at owner's address, check here <input checked="" type="checkbox"/> 2700 E. 4th Avenue<br>Hutchinson, KS 67501 |                                 | <b>Global Positioning Systems (GPS) information:</b><br>Latitude: 38.05930 (in decimal degrees)<br>Longitude: -97.87938 (in decimal degrees)<br>Elevation: 1522.04<br>Horizontal Datum: <input type="checkbox"/> WGS84, <input type="checkbox"/> NAD83, <input checked="" type="checkbox"/> NAD27<br>Collection Method: |                           |  |

|   |  |
|---|--|
| <b>2 WATER WELL OWNER:</b> Dillons Distribution Center<br>RR#, St. Address, Box #: 2700 E. 4th Avenue<br>City, State ZIP Code: Hutchinson, KS 67501 | <input checked="" type="checkbox"/> GPS unit (Make/Model: Garmin)<br><input type="checkbox"/> Digital Map/Photo, <input type="checkbox"/> Topographic Map, <input type="checkbox"/> Land Survey<br>Est. Accuracy: <input type="checkbox"/> < 3 m, <input type="checkbox"/> 3-5 m, <input type="checkbox"/> 5-15 m, <input type="checkbox"/> > 15 m |
|---|--|

|   |  |
|---|--|
| <b>3 MARK WELL'S LOCATION WITH AN "X" IN SECTION BOX:</b><br> | <b>4 DEPTH OF WELL</b> 20.34 ft.<br><b>WELL'S STATIC WATER LEVEL</b> 10.95 ft.<br><b>WELL WAS USED AS:</b><br><input type="checkbox"/> Domestic <input type="checkbox"/> Public Water Supply <input type="checkbox"/> Dewatering<br><input type="checkbox"/> Irrigation <input type="checkbox"/> Oil Field Water Supply <input checked="" type="checkbox"/> Monitoring<br><input type="checkbox"/> Feedlot <input type="checkbox"/> Domestic (Lawn & Garden) <input type="checkbox"/> Injection Well<br><input type="checkbox"/> Industrial <input type="checkbox"/> Air Conditioning <input type="checkbox"/> Other<br>Was a chemical/bacteriological sample submitted to Department? Yes <input type="checkbox"/> No <input checked="" type="checkbox"/> |
|---|--|

**5 TYPE OF BLANK CASING USED:**

☐ Steel ☐ RMP (SR) ☐ Wrought ☐ Fiberglass ☐ Other (Specify below)  
☒ PVC ☐ ABS ☐ Asbestos-Cement ☐ Concrete Tile

Blank casing diameter 2.0 in. Was casing pulled? Yes ☒ No ☐ If yes, how much 3.0 ft.  
 Casing height above or below land surface 3.36 in.

**6 GROUT PLUG MATERIAL:** ☐ Neat cement ☐ Cement grout ☒ Bentonite ☐ Other

Grout Plug Intervals: From 20.34 ft. to 3.0 ft., From \_\_\_\_\_ ft. to \_\_\_\_\_ ft., From \_\_\_\_\_ ft. to \_\_\_\_\_ ft.

What is the nearest source of possible contamination:

|   |   |  |  |
|---|---|--|--|
| <input type="checkbox"/> Septic tank            | <input type="checkbox"/> Seepage pit    | <input checked="" type="checkbox"/> Fuel storage | <input type="checkbox"/> Other (specify below) |
| <input type="checkbox"/> Sewer lines            | <input type="checkbox"/> Pit privy      | <input type="checkbox"/> Fertilizer storage      |  |
| <input type="checkbox"/> Watertight sewer lines | <input type="checkbox"/> Sewage lagoon  | <input type="checkbox"/> Insecticide storage     |  |
| <input type="checkbox"/> Lateral lines          | <input type="checkbox"/> Feedyard       | <input type="checkbox"/> Abandoned water well    |  |
| <input type="checkbox"/> Cess pool              | <input type="checkbox"/> Livestock pens | <input type="checkbox"/> Oil well/Gas well       |  |

Direction from well? East  
 How many feet? 590 ft.

| FROM  | TO    | PLUGGING MATERIALS | FROM | TO | PLUGGING MATERIALS |
|-------|-------|--------------------|------|----|--------------------|
| 20.34 | 3.00  | Hydrated Bentonite |      |    |                    |
| 3.00  | 0.5   | Bag Topsoil        |      |    |                    |
| 0.5   | Grade | Asphalt            |      |    |                    |
|       |       |                    |      |    |                    |
|       |       |                    |      |    |                    |
|       |       |                    |      |    |                    |
|       |       |                    |      |    |                    |

**7 CONTRACTOR'S OR LANDOWNER'S CERTIFICATION:** This water well was plugged under my jurisdiction and was completed on (mo/day/year) 10/17/18 and this record is true to the best of my knowledge and belief. Kansas Water Well Contractor's License No. 337 LG. This Water Well Record was completed on (mo/day/year) 10/31/18 under the business name of Knightly Environmental Inc. by (signature) *[Signature]*

Send one white copy to Kansas Department of Health & Environment, Geology Section, 1000 SW Jackson Street, Ste. 420, Topeka, KS 66612-1367. Send one copy to WATER WELL OWNER and retain one for your records.  
 Visit us at <http://www.kdheks.gov/waterwell/index.html> Telephone 785-296-5524.

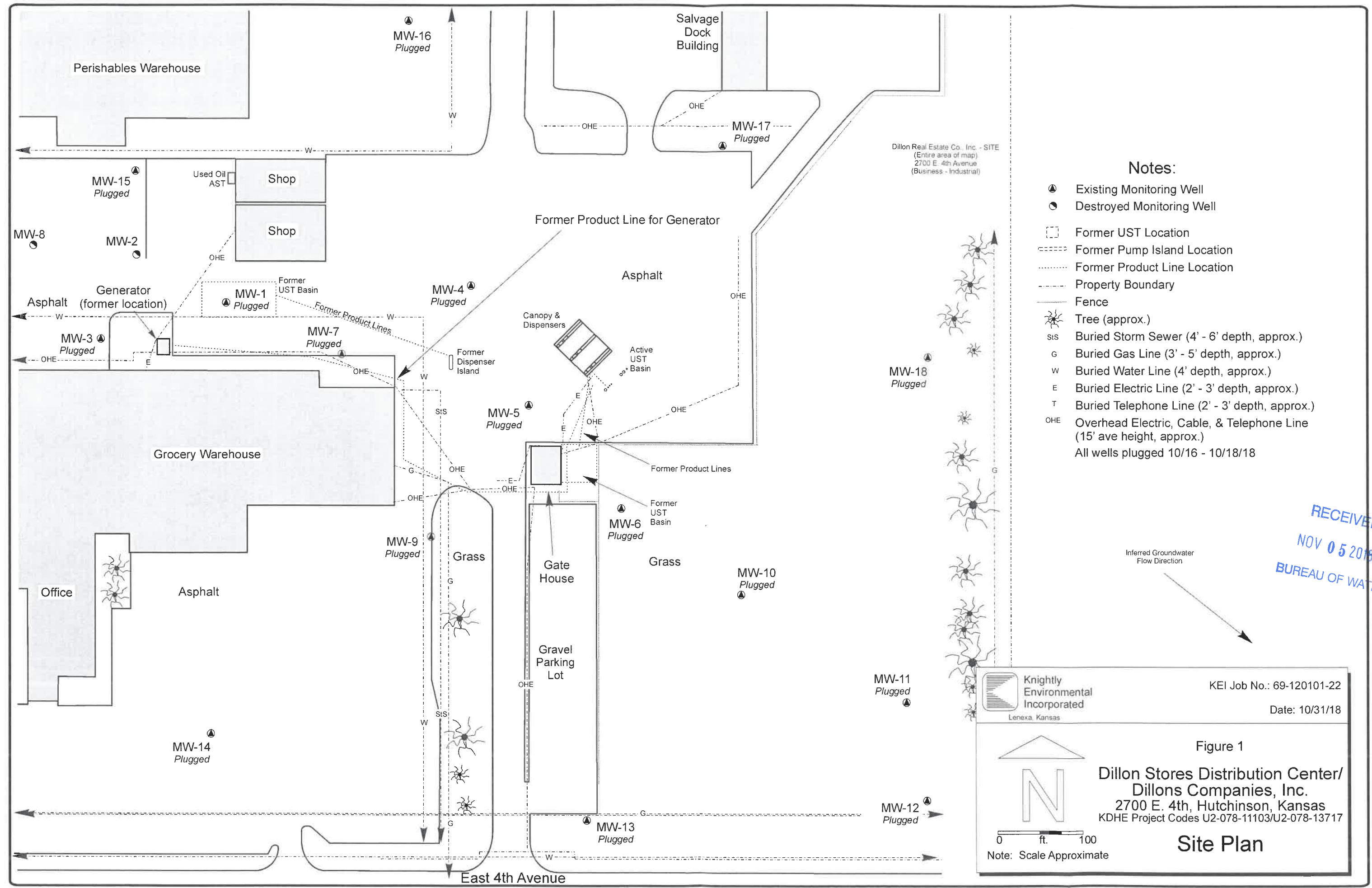

Notes:

- Existing Monitoring Well
- Destroyed Monitoring Well
- Former UST Location
- Former Pump Island Location
- Former Product Line Location
- Property Boundary
- Fence
- Tree (approx.)
- SIS Buried Storm Sewer (4' - 6' depth, approx.)
- G Buried Gas Line (3' - 5' depth, approx.)
- W Buried Water Line (4' depth, approx.)
- E Buried Electric Line (2' - 3' depth, approx.)
- T Buried Telephone Line (2' - 3' depth, approx.)
- OHE Overhead Electric, Cable, & Telephone Line (15' ave height, approx.)
- All wells plugged 10/16 - 10/18/18

RECEIVED  
NOV 05 2018  
BUREAU OF WATER



Knightly  
Environmental  
Incorporated  
Lenexa, Kansas

KEI Job No.: 69-120101-22  
Date: 10/31/18

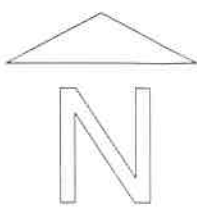

Figure 1  
Dillon Stores Distribution Center/  
Dillons Companies, Inc.  
2700 E. 4th, Hutchinson, Kansas  
KDHE Project Codes U2-078-11103/U2-078-13717

0 ft. 100

Note: Scale Approximate

Site Plan