

1 LOCATION OF WATER WELL: Fraction **SW ¼ NE ¼ NE ¼** Section Number **20** Township Number **T 24 S** Range Number **R 16 E/W**
 County: **Edwards**
 Distance and direction from nearest town or city street address of well if located within city?

2 WATER WELL OWNER: **Southern Plains Coop**
 RR#, St. Address, Box #: **PO Bos 128** Board of Agriculture, Division of Water Resources
 City, State, ZIP Code: **Lewis, KS 67552** Application Number:

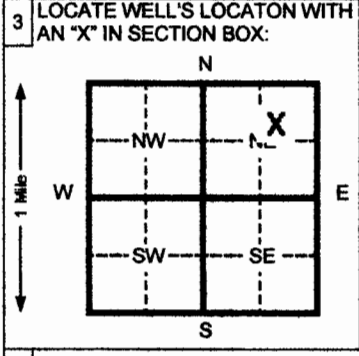

4 DEPTH OF COMPLETED WELL **50** ft. ELEVATION: _____
 Depth(s) Groundwater Encountered 1 _____ ft. 2 _____ ft. 3 _____ ft.
 WELL'S STATIC WATER LEVEL **33** ft. below land surface measured on mo/day/yr
 Pump test data: Well water was _____ ft. after _____ hours pumping _____ gpm
 Est. Yield _____ gpm: Well water was _____ ft. after _____ hours pumping _____ gpm
 Bore Hole Diameter **8.25** in. to **5.0** ft. and _____ in. to _____ ft.
 WELL WATER TO BE USED AS: 5 Public water supply 8 Air conditioning 11 Injection well
 1 Domestic 3 Feed lot 6 Oil field water supply 9 Dewatering 12 Other (Specify below)
 2 Irrigation 4 Industrial 7 Lawn and garden (domestic) **10** Monitoring well
 Was a chemical/bacteriological sample submitted to Department? Yes _____ No **X** If yes, mo/day/yr sample was submitted _____
 Water Well Disinfected? Yes _____ No **X**

5 TYPE OF BLANK CASING USED: 5 Wrought Iron 8 Concrete tile CASING JOINTS: Glued **X** Clamped _____
 1 Steel 3 RMP (SR) 6 Asbestos-Cement 9 Other (specify below) Welded _____
2 PVC 4 ABS 7 Fiberglass Threaded _____
 Blank casing diameter **2** in. to **35** ft., Dia _____ in. to _____ ft., Dia _____ in. to _____ ft.
 Casing height above land surface **0** in., weight **.716** lbs./ft. Wall thickness or gauge No. **.154**
 TYPE OF SCREEN OR PERFORATION MATERIAL: **7** PVC 10 Asbestos-cement
 1 Steel 3 Stainless steel 5 Fiberglass 8 RMP (SR) 11 Other (specify) _____
 2 Brass 4 Galvanized steel 6 Concrete tile 9 ABS 12 None used (open hole)
 SCREEN OR PERFORATION OPENINGS ARE: 5 Gauzed wrapped **8** Saw cut 11 None (open hole)
 1 Continuous slot 3 Mill slot 6 Wire wrapped 9 Drilled holes
 2 Louvered shutter 4 Key punched 7 Torch cut 10 Other (specify) _____
 SCREEN-PERFORATED INTERVALS: From **35** ft. to **50** ft. From _____ ft. to _____ ft.
 From _____ ft. to _____ ft. From _____ ft. to _____ ft.
 GRAVEL PACK INTERVALS: From **33** ft. to **50** ft. From _____ ft. to _____ ft.
 From _____ ft. to _____ ft. From _____ ft. to _____ ft.

6 GROUT MATERIAL: 1 Neat cement 2 Cement grout 3 Bentonite 4 Other _____
 Grout Intervals From **0** ft. to **31** ft. From **31** ft. to **33** ft. From _____ ft. to _____ ft.
 What is the nearest source of possible contamination:
 1 Septic tank 4 Lateral lines 7 Pit privy 10 Livestock pens 14 Abandoned water well
 2 Sewer lines 5 Cess pool 8 Sewage lagoon 11 Fuel storage 15 Oil well/ Gas well
 3 Watertight sewer lines 6 Seepage pit 9 Feedyard 12 Fertilizer storage 16 Other (specify below)
Contaminated Site
 Direction from well? _____ How many feet? _____

FROM	TO	CODE	LITHOLOGIC LOG	FROM	TO	PLUGGING INTERVALS
0	.5		Sand, gravel, rock (fill)			Clayey, sat
.5	3.5		Silt, dk br, clayey, moist	50		BH
3.5	7.5		Silty clay, gy br, stiff, damp, trc			
			Caliche			
7.5	17		Sand, lt brn, silty, fine gr, damp			
17	21		Sand, y br, sil clayey, fine-med, damp			
21	33		Silty clay, rd br, frim, moist, Caliche, sli sand			
33	34		Sandy, clay, rd br, f-med, wet			
34	37		Aa but sat			
37	50		Sand, y br, f-med, trc, crs,			

7 CONTRACTOR'S OR LANDOWNER'S CERTIFICATION: This water well was **(1)** constructed, (2) reconstructed, or (3) plugged under my jurisdiction and was completed on (mo/day/yr) **5/30/07** and this record is true to the best of my knowledge and belief. Kansas Water Well Contractor's License No. **554** This Water Well Record was completed on (mo/day/yr) **6/18/07** under the business name of **Woofter Pump & Well Inc.** by (signature) *Jay C. Woofter*
 INSTRUCTIONS: Please fill in blanks and circle the correct answers. Send three copies to Kansas Department of Health and Environment, Bureau of Water, 1000 S W Jackson St., Ste. 420, Topeka, Kansas 66612-1367. Telephone: 913-298-5545. Send one to WATER WELL OWNER and retain one for your records.

OFFICE USE ONLY

T

R

SEC