

**WATER WELL PLUGGING RECORD Form WWC-5P KSA 82a-1212 ID NO.**

1 **LOCATION OF WATER WELL:** Fraction NW 1/4 SW 1/4 NW 1/4 SW 1/4 Section Number 35 Township Number 24 T S Range Number 24  E  W  
 County: Hodgeman

Street/Rural Address of Well Location; if unknown, distance & direction from nearest town or intersection: If at owner's address, check here  Township South Posole  
35-0245-026 W

**Global Positioning Systems (GPS) information:**  
 Latitude: 37.919091 (in decimal degrees)  
 Longitude: 100.153077 (in decimal degrees)  
 Elevation: 2598  
 Datum:  WGS84,  NAD83,  NAD27  
 Collection Method:  
 GPS unit (Make/Model: Garmin)  
 Digital Map/Photo,  Topographic Map,  Land Survey  
 Est. Accuracy:  <3 m,  3-5 m,  5-15 m,  >15 m

2 **WATER WELL OWNER:** Todd Hamilton  
 RR#, St. Address, Box #: 24506 22nd Rd  
 City, State ZIP Code: Ensign KS 67841

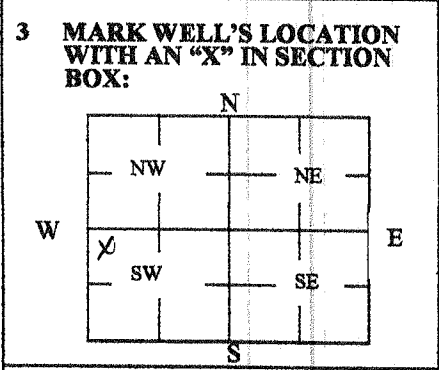

4 **DEPTH OF WELL** 36 ft.  
**WELL'S STATIC WATER LEVEL** 0 ft.  
**WELL WAS USED AS:**  
 Domestic  Public Water Supply  Dewatering  
 Irrigation  Oil Field Water Supply  Monitoring  
 Feedlot  Domestic (Lawn & Garden)  Injection Well  
 Industrial  Air Conditioning  Other \_\_\_\_\_  
 Was a chemical/bacteriological sample submitted to Department? Yes  No

5 **TYPE OF BLANK CASING USED:**  
 Steel  RMP (SR)  Wrought  Fiberglass  Other (Specify below)  
 PVC  ABS  Asbestos-Cement  Concrete Tile  
 Blank casing diameter 5 in. Was casing pulled? Yes  No  If yes, how much \_\_\_\_\_  
 Casing height above or below land surface 48 in.

6 **GROUT PLUG MATERIAL:**  Neat cement  Cement grout  Bentonite  Other \_\_\_\_\_  
 Grout Plug Intervals: From 36 ft. to 40 ft., From 4 ft. to 0 ft., From \_\_\_\_\_ ft. to \_\_\_\_\_ ft.  
 What is the nearest source of possible contamination:  
 Septic tank  Seepage pit  Fuel storage  Other (specify below) \_\_\_\_\_  
 Sewer lines  Pit privy  Fertilizer storage \_\_\_\_\_  
 Watertight sewer lines  Sewage lagoon  Insecticide storage \_\_\_\_\_  
 Lateral lines  Feedyard  Abandoned water well Direction from well? \_\_\_\_\_  
 Cess pool  Livestock pens  Oil well/Gas well How many feet? \_\_\_\_\_

FROM	TO	PLUGGING MATERIALS	FROM	TO	PLUGGING MATERIALS
36	40	Bentonite			
40	4	Clean Fill Sand			
4	0	Bentonite			

7 **CONTRACTOR'S OR LANDOWNER'S CERTIFICATION:** This water well was plugged under my jurisdiction and was completed on (mo/day/year) 3-16-15 and this record is true to the best of my knowledge and belief. Kansas Water Well Contractor's License No. 846. This Water Well Record was completed on (mo/day/year) 3-17-15 under the business name of Nash Water Well Service LLC by (signature) [Signature]

**INSTRUCTIONS:** Use typewriter or ballpoint pen. Please press firmly and print clearly. Please fill in blanks, underline or circle the correct answers. Send top three copies to Kansas Department of Health and Environment, Bureau of Water, Geology Section, 1000 SW Jackson St., Ste. 420, Topeka, Kansas 66612-1367. Telephone: 785/296-5524. Send one to Water Well Owner and retain one for your records. Visit us at <http://www.kdheks.gov/waterwell/index.html>.