

WATER WELL RECORD

Form WWC-5

Division of Water Resources App. No.

FI 6 & 9,308

1 LOCATION OF WATER WELL: County: FINNEY Fraction 1/4 NW 1/4 SE 1/4 SE 1/4 Section Number 14 Township No. T 24 S Range Number R 31 [ ] E [X] W

Street/Rural Address of Well Location; if unknown, distance & direction from nearest town or intersection: If at owner's address, check here [ ]. E SIDE OF GARDEN CITY-6 M E ON HWY. 50, 3 M E ON POLE LINE RD, 1.035 FT. N. & 800 FT. W.

2 WATER WELL OWNER: ROY AND JANICE HARMS RR#, Street Address, Box #: 2007 ANTELOPE DRIVE City, State, ZIP Code : GARDEN CITY, KS 67846

Global Positioning System (GPS) information: Latitude: (in decimal degrees) Longitude: (in decimal degrees) Elevation: Datum: [ ] WGS 84, [ ] NAD 83, [ ] NAD 27 Collection Method: [ ] GPS unit (Make/Model: ) [ ] Digital Map/Photo, [ ] Topographic Map, [ ] Land Survey Est. Accuracy: [ ] <3 m, [ ] 3-5 m, [ ] 5-15 m, [ ] >15 m

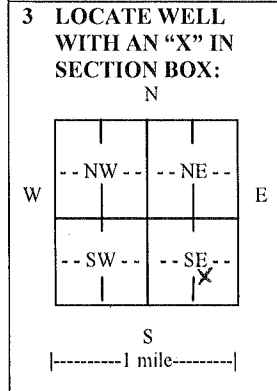

3 LOCATE WELL WITH AN 'X' IN SECTION BOX: 4 DEPTH OF COMPLETED WELL 280 ft. Depth(s) Groundwater Encountered (1) ft. (2) ft. (3) ft. WELL'S STATIC WATER LEVEL 188 ft. below land surface measured on mo/day/yr. 1-20-14 Pump test data: Well water was ft. after hours pumping gpm EST. YIELD gpm. Well water was ft. after hours pumping gpm Bore Hole Diameter 30 in. to 280 ft., and in. to ft. WELL WATER TO BE USED AS: [ ] Public water supply [ ] Geothermal [ ] Injection well [ ] Domestic [ ] Feedlot [ ] Oil field water supply [ ] Dewatering [ ] Other (Specify below) [X] Irrigation [ ] Industrial [ ] Domestic-lawn & garden [ ] Monitoring well Was a chemical/bacteriological sample submitted to Department? [ ] Yes [X] No If yes, mo/day/yr sample was submitted Water well disinfected? [ ] Yes [X] No

5 TYPE OF CASING USED: [X] Steel [ ] PVC [ ] Other CASING JOINTS: [ ] Glued [ ] Clamped [X] Welded [ ] Threaded Casing diameter 16 in. to 205 ft., Diameter in. to ft., Diameter in. to ft. Casing height above land surface 12 in., Weight 42.05 lbs./ft., Wall thickness or gauge No. 250 TYPE OF SCREEN OR PERFORATION MATERIAL: [X] Steel [ ] Stainless Steel [ ] PVC [ ] Brass [ ] Galvanized Steel [ ] None used (open hole) [ ] Other (Specify) SCREEN OR PERFORATION OPENINGS ARE: [ ] Continuous slot [X] Mill slot [ ] Gauze wrapped [ ] Torch cut [ ] Drilled holes [ ] None (open hole) [ ] Louvered shutter [ ] Key punched [X] Wire wrapped [ ] Saw cut [ ] Other (specify) SCREEN-PERFORATED INTERVALS: From 205 ft. to 280 ft., From ft. to ft. From ft. to ft., From ft. to ft. GRAVEL PACK INTERVALS: From 20 ft. to 135 ft., From 195 ft. to 280 ft. From ft. to ft., From ft. to ft.

6 GROUT MATERIAL: [ ] Neat cement [X] Cement grout [ ] Bentonite [ ] Other Grout Intervals: From 0 ft. to 20 ft., From 135 ft. to 195 ft., From ft. to ft. What is the nearest source of possible contamination: [ ] Septic tank [ ] Lateral lines [ ] Pit privy [ ] Livestock pens [ ] Insecticide storage [ ] Other (specify below) [ ] Sewer lines [ ] Cesspool [ ] Sewage lagoon [ ] Fuel storage [X] Abandoned water well [ ] Watertight sewer lines [ ] Seepage pit [ ] Feedyard [ ] Fertilizer storage [ ] Oil well/gas well Direction from well NORTHWEST Distance from well 25 FT. NORTH & 100 FT. WEST

Table with 6 columns: FROM, TO, LITHOLOGIC LOG, FROM, TO, LITHO. LOG (cont.) or PLUGGING INTERVALS. Row 1 contains 'SEE ATTACHED LOG'.

7 CONTRACTOR'S OR LANDOWNER'S CERTIFICATION: This water well was [X] constructed, [ ] reconstructed, or [ ] plugged under my jurisdiction and was completed on (mo/day/year) 1-28-14 and this record is true to the best of my knowledge and belief. Kansas Water Well Contractor's License No. 208 This Water Well Record was completed on (mo/day/year) 1-31-14 under the business name of MINTER-WILSON DRILLING CO., INC. by (signature) Nora Keller

INSTRUCTIONS: Use typewriter or ball point pen. PLEASE PRESS FIRMLY and PRINT clearly. Please fill in blanks and check the correct answers. Send one copy to Kansas Department of Health and Environment, Bureau of Water, Geology Section, 1000 SW Jackson St., Suite 420, Topeka, Kansas 66612-1367. Telephone 785-296-5524. Send one copy to WATER WELL OWNER and retain one for your records. Include fee of \$5.00 for each constructed well. Visit us at http://www.kdheks.gov/waterwell/index.html

*The  
Professionals*

# MINTER-WILSON DRILLING CO.

INCORPORATED

Irrigation  
and Domestic  
Water Systems  
Complete Installation  
and Repairing

Phone 620-276-8269 • P.O. Box A • GARDEN CITY, KANSAS 67846

NAME ROY HARMIS  
COUNTY FINNEY  
DATE 12-11-13

LOCATION: SE 1/4 14-24-31 - POLE LINE ROAD - 2-3/4 MILES EAST & 1/4 MILE  
NORTH THRU YARD  
- 100 FT. EAST OF EXISTING WELL

STATIC WATER LEVEL - APPROX. 190 FT.

## TEST # 1

0' TO 1' - TOP SOIL  
1' TO 25' - BROWN CLAY  
25' TO 47' - BROWN CLAY WITH WHITE ROCK MIXED  
47' TO 55' - FINE TO MEDIUM SAND & GRAVEL  
55' TO 68' - FINE TO MEDIUM SAND & GRAVEL - CEMENTED  
68' TO 80' - BROWN CLAY WITH GRAVEL STREAKS  
80' TO 110' - BROWN CLAY  
110' TO 125' - BROWN CLAY WITH STREAK OF GRAVEL  
125' TO 188' - BROWN CLAY  
188' TO 200' - BROWN CLAY WITH GRAVEL STREAKS  
200' TO 212' - FINE TO MEDIUM SAND & GRAVEL  
212' TO 218' - BROWN CLAY  
218' TO 245' - BROWN CLAY WITH GRAVEL STREAKS  
245' TO 265' - FINE TO MEDIUM SAND & GRAVEL  
265' TO 282' - BROWN YELLOW CLAY  
282' TO 290' - SHALE