

WATER WELL PLUGGING RECORD Form WWC-5P KSA 82a-1212 ID NO. N/A

1 LOCATION OF WATER WELL: Fraction 1/4 SW 1/4 NE 1/4 NE 1/4 Section Number 1 Township Number T 24 S Range Number 33 E W
 County: FINNEY

Street/Rural Address of Well Location; if unknown, distance & direction from nearest town or intersection: If at owner's address, check here From the intersection of Hickory Street
& BUS Hwy 83 go approx. 1/4 mile West

Global Positioning Systems (GPS) information:
 Latitude: 38.0000010 N (in decimal degrees)
 Longitude: -100.887910 W (in decimal degrees)
 Elevation: _____
 Datum: WGS84, NAD83, NAD27
 Collection Method:
 GPS unit (Make/Model: Garmin eTrex 10)
 Digital Map/Photo, Topographic Map, Land Survey
 Est. Accuracy: < 3 m, 3-5 m, 5-15 m, > 15 m

2 WATER WELL OWNER: Brookover Feed Yard
 RR#, St. Address, Box #: P.O. Box 917
 City, State ZIP Code: Garden City Ks., 67846

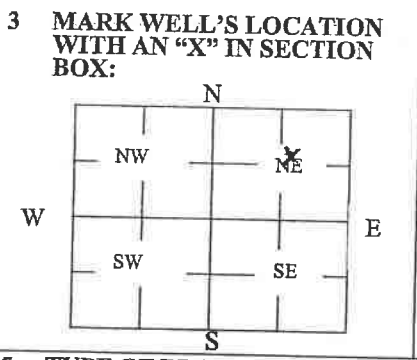

4 DEPTH OF WELL 145' ft.
 WELL'S STATIC WATER LEVEL No Water ft.
 WELL WAS USED AS:
 Domestic Public Water Supply Dewatering
 Irrigation Oil Field Water Supply Monitoring
 Feedlot Domestic (Lawn & Garden) Injection Well
 Industrial Air Conditioning Other _____
 Was a chemical/bacteriological sample submitted to Department? Yes No

5 TYPE OF BLANK CASING USED:
 Steel RMP (SR) Wrought Fiberglass Other (Specify below)
 PVC ABS Asbestos-Cement Concrete Tile
 Blank casing diameter 16" in. Was casing pulled? Yes No If yes, how much 60"
 Casing height above or below land surface Below 60" in.

6 GROUT PLUG MATERIAL: Neat cement Cement grout Bentonite Other _____
 Grout Plug Intervals: From 10' ft. to 5' ft., From _____ ft. to _____ ft., From _____ to _____ ft.
 What is the nearest source of possible contamination:
 Septic tank Seepage pit Fuel Storage Other (specify below)
 Sewer lines Pit privy Fertilizer storage
 Watertight sewer lines Sewage lagoon Insecticide storage
 Lateral lines Feedyard Abandoned water well
 Cess pool Livestock pens Oil well/Gas well
 Direction from well? Southwest
 How many feet? 190' approx.

FROM	TO	PLUGGING MATERIALS	FROM	TO	PLUGGING MATERIALS
145'	10'	Oversized Rock with Clay Chunks	10'	5'	3,000 PSI CONCRETE

7 CONTRACTOR'S OR LANDOWNER'S CERTIFICATION: This water well was plugged under my jurisdiction and was completed on (mo/day/year) 10-27-2021 and this record is true to the best of my knowledge and belief. Kansas Water Well Contractor's License No. 145. This Water Well Record was completed on (mo/day/year) 10-28-2021 under the business name of Hydro Resources Mid Continent by (signature) Gary Clepper

INSTRUCTIONS: Use typewriter or ballpoint pen. Please press firmly and print clearly. Please fill in blanks, underline or circle the correct answers. Send top three copies to Kansas Department of Health and Environment, Bureau of Water, Geology Section, 1000 SW Jackson St., Ste. 420, Topeka, Kansas 66612-1367. Telephone: 785/296-5524. Send one to Water Well Owner and retain one for your records. Visit us at <http://www.kdheks.gov/waterwell/index.html>.

Check one: White Copy Blue Copy Pink Copy