

WATER WELL RECORD Form WWC-5

Original Record Correction Change in Well Use

Division of Water Resources App. No.

Well ID

1 LOCATION OF WATER WELL: County: Kearney Fraction NW 1/4 NE 1/4 NW 1/4 NW 1/4 Section Number 24 Township Number T 24 S Range Number R 35 E W

2 WELL OWNER: Last Name: Castro First: Ramon Street or Rural Address where well is located (if unknown, distance and direction from nearest town or intersection): If at owner's address, check here:
 Business Address: 2415 Rd 160 N 37, 959264
 Address: Oberfield State: Ko ZIP: 67867 W 101.118815
 City: _____

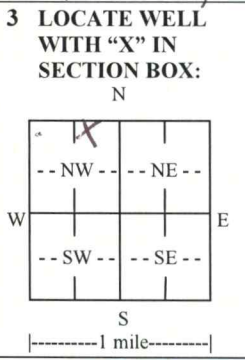

4 DEPTH OF COMPLETED WELL: 272 ft.
 Depth(s) Groundwater Encountered: 1) _____ ft.
 2) _____ ft. 3) _____ ft., or 4) Dry Well
 WELL'S STATIC WATER LEVEL: 10.9 ft.
 below land surface, measured on (mo-day-yr) _____
 above land surface, measured on (mo-day-yr) 8-14-18
 Pump test data: Well water was _____ ft.
 after _____ hours pumping _____ gpm
 Well water was _____ ft.
 after _____ hours pumping _____ gpm
 Estimated Yield: 20 gpm
 Bore Hole Diameter: 1.8 in. to 2.80 ft. and _____ in. to _____ ft.

5 Latitude: N 37.5714 (decimal degrees)
Longitude: W 101.118815 (decimal degrees)
 Horizontal Datum: WGS 84 NAD 83 NAD 27
 Source for Latitude/Longitude: E 101 30
 GPS (unit make/model: _____)
 (WAAS enabled? Yes No)
 Land Survey Topographic Map
 Online Mapper: _____
6 Elevation: 2900 ft. Ground Level TOC
 Source: Land Survey GPS Topographic Map
 Other: RGA

7 WELL WATER TO BE USED AS:

1. Domestic: Household Lawn & Garden Livestock
 2. Irrigation
 3. Feedlot
 4. Industrial

5. Public Water Supply: well ID _____
 6. Dewatering: how many wells? _____
 7. Aquifer Recharge: well ID _____
 8. Monitoring: well ID _____
 9. Environmental Remediation: well ID _____
 Air Sparge Soil Vapor Extraction
 Recovery Injection

10. Oil Field Water Supply: lease _____
 11. Test Hole: well ID _____
 Cased Uncased Geotechnical
 12. Geothermal: how many bores? _____
 a) Closed Loop Horizontal Vertical
 b) Open Loop Surface Discharge Inj. of Water
 13. Other (specify): _____

Was a chemical/bacteriological sample submitted to KDHE? Yes No If yes, date sample was submitted: _____
 Water well disinfected? Yes No

8 TYPE OF CASING USED: Steel PVC Other _____ CASING JOINTS: Glued Clamped Welded Threaded
 Casing diameter: 5 in. to 2.72 ft., Diameter _____ in. to _____ ft., Diameter _____ in. to _____ ft.
 Casing height above land surface: 18 in. Weight 200 lbs./ft. Wall thickness or gauge No. S.O.R. 21
TYPE OF SCREEN OR PERFORATION MATERIAL:
 Steel Stainless Steel Fiberglass PVC Other (Specify) _____
 Brass Galvanized Steel Concrete tile None used (open hole)
SCREEN OR PERFORATION OPENINGS ARE:
 Continuous Slot Mill Slot Gauze Wrapped Torch Cut Drilled Holes Other (Specify) _____
 Louvered Shutter Key Punched Wire Wrapped Saw Cut None (Open Hole)
SCREEN-PERFORATED INTERVALS: From 252 ft. to 272 ft., From 1 ft. to _____ ft., From _____ ft. to _____ ft.
GRAVEL PACK INTERVALS: From 256 ft. to 272 ft., From 50 ft. to 200 ft., From _____ ft. to _____ ft.

9 GROUT MATERIAL: Neat cement Cement grout Bentonite Other _____
 Grout Intervals: From 5 ft. to 50 ft., From 200 ft. to 250 ft., From _____ ft. to _____ ft.
Nearest source of possible contamination:
 Septic Tank Lateral Lines Pit Privy Livestock Pens Insecticide Storage
 Sewer Lines Cess Pool Sewage Lagoon Fuel Storage Abandoned Water Well
 Watertight Sewer Lines Seepage Pit Feedyard Fertilizer Storage Oil Well/Gas Well
 Other (Specify) _____
 Direction from well? East Distance from well? 200 ft.

10 FROM	TO	LITHOLOGIC LOG	FROM	TO	LITHO. LOG (cont.) or PLUGGING INTERVALS
0	5	TOPSOIL	234	240	Brown Sandy clay
5	10	Brown Sandy clay	240	248	Blue Sand
10	47	Coarse gravel (Rock &)	248	253	Blue Sand
47	83	Brown Sandy clay	253	262	Brown Sandy clay
83	93	Brown clay & Rock	262	272	Blue Sand & gravel
93	170	Blue clay	272	280	Brown clay
170	187	Fine to med Sand & gravel			
187	232	Brown Sandy clay			
232	234	Fine to med Sand & gravel			

11 CONTRACTOR'S OR LANDOWNER'S CERTIFICATION: This water well was constructed, reconstructed, or plugged under my jurisdiction and was completed on (mo-day-year) 9-30-18 and this record is true to the best of my knowledge and belief. Kansas Water Well Contractor's License No. 172. This Water Well Record was completed on (mo-day-year) 6-10-19 under the business name of Tanager Water Well Services, LLC Signature M. B.