

1 LOCATION OF WATER WELL: Fraction SE 1/4 NW 1/4 NE 1/4 Section Number 27 Township Number T 24 S Range Number R 36 EW
 County: **Kearyn**
 Distance and direction from nearest town or city street address of well if located within city?
200 N. Main, Lakin

2 WATER WELL OWNER: **Farmers Cooperative**
 RR#, St. Address, Box # : **200 N. Main** Board of Agriculture, Division of Water Resources
 City, State, ZIP Code : **Lakin, Kansas 67860** Application Number:

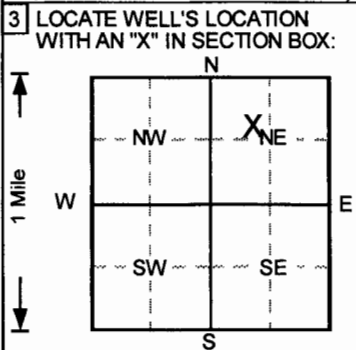

4 DEPTH OF COMPLETED WELL 30 ft. ELEVATION: 3004.8
 Depth(s) Groundwater Encountered 1. ft. 2. ft. 3. ft.
 WELL'S STATIC WATER LEVEL 18.3 ft. below land surface measured on mo/day/yr 7/10/2007
 Pump test data: Well water was NA ft. after hours pumping gpm
 Est. Yield NA gpm: Well water was ft. after hours pumping gpm
 Bore Hole Diameter 8 in. to 30 ft., and in. to ft.
 WELL WATER TO BE USED AS:
 5 Public water supply 8 Air conditioning 11 Injection well
 1 Domestic 3 Feedlot 6 Oil field water supply 9 Dewatering 12 Other (Specify below)
 2 Irrigation 4 Industrial 7 Lawn and garden only 10 Monitoring well
 Was a chemical/bacteriological sample submitted to Department? Yes No
 If yes, mo/day/yr sample was submitted Water Well Disinfected? Yes No

5 TYPE OF BLANK CASING USED: 1 Steel 3 RMP (SR) 5 Wrought iron 8 Concrete tile CASING JOINTS: Glued Clamped
 2 PVC 4 ABS 6 Asbestos-Cement 9 Other (specify below) Welded
 7 Fiberglass Threaded
 Blank casing diameter 2 in. to 10 ft. Dia. in. to ft. Dia. in. to ft.
 Casing height above land surface -5.88 in., weight lbs./ft. Wall thickness or gauge No. Sch. 40
 TYPE OF SCREEN OR PERFORATION MATERIAL 7 PVC 10 Asbestos-cement
 1 Steel 3 Stainless steel 5 Fiberglass 8 RMP (SR) 11 Other (specify)
 2 Brass 4 Galvanized steel 6 Concrete tile 9 ABS 12 None used (open hole)
 SCREEN OR PERFORATION OPENINGS ARE: 3 Mill slot 8 Saw cut 11 None (open hole)
 1 Continuous slot 6 Wire wrapped 9 Drilled holes
 2 Louvered shutter 4 Key punched 7 Torch cut 10 Other (specify)
 SCREEN-PERFORATED INTERVALS: From 10 ft. to 30 ft. ft. to ft.
 From ft. to ft. ft. to ft.
 GRAVEL PACK INTERVALS: From 8 ft. to 30 ft. ft. to ft.
 From ft. to ft. ft. to ft.

6 GROUT MATERIAL: 1 Neat cement 2 Cement grout 3 Bentonite 4 Other
 Grout Intervals: From 1 ft. to 8 ft. ft. to ft. From ft. to ft.
 What is the nearest source of possible contamination:
 1 Septic tank 4 Lateral lines 7 Pit privy 10 Livestock pens 14 Abandoned water well
 2 Sewer lines 5 Cess pool 8 Sewage lagoon 11 Fuel storage 15 Oil well/Gas well
 3 Watertight sewer lines 6 Seepage pit 9 Feedyard 12 Fertilizer storage 16 Other (specify below)
 13 Insecticide storage
 Direction from well? How many feet?

FROM	TO	LITHOLOGIC LOG	FROM	TO	PLUGGING INTERVALS
0	0.5	Gravel parking lot,			
0.5	10	Clay, silty, sl. plastic, no odor, dry, Med. Brow			
10	13	Silt, v. clayey, moist, no odor, Gray-Brown			
13	18	Sand (vf), v. silty, moist, no odor, Gray-Brown			
18	26	Sand (f-m), silty, sat. @ 20', Gray-Brown			
26	28	Sand (c to gravel), wet, sl. odor, Gray-Brown			
28	30	Clay, sl. sandy, plastic, Brown			

MW14 , Tag # 00375841 , Flushmount
 Project Name: **Cropland Coop of Lakin (former Farmers**
 GeoCore # 296 , KDHE # U1 047 00304

CORRECTED

7 CONTRACTOR'S OR LANDOWNER'S CERTIFICATION: This water well was (1) constructed, (2) reconstructed, or (3) plugged under my jurisdiction and was completed on (mo/day/year) 7/10/2007 and this record is true to the best of my knowledge and belief.
 Kansas Water Well Contractor's License No. 527 This Water Well Record was completed on (mo/day/yr) 7/20/2007 under the business name of **GeoCore, Inc.** by (signature)

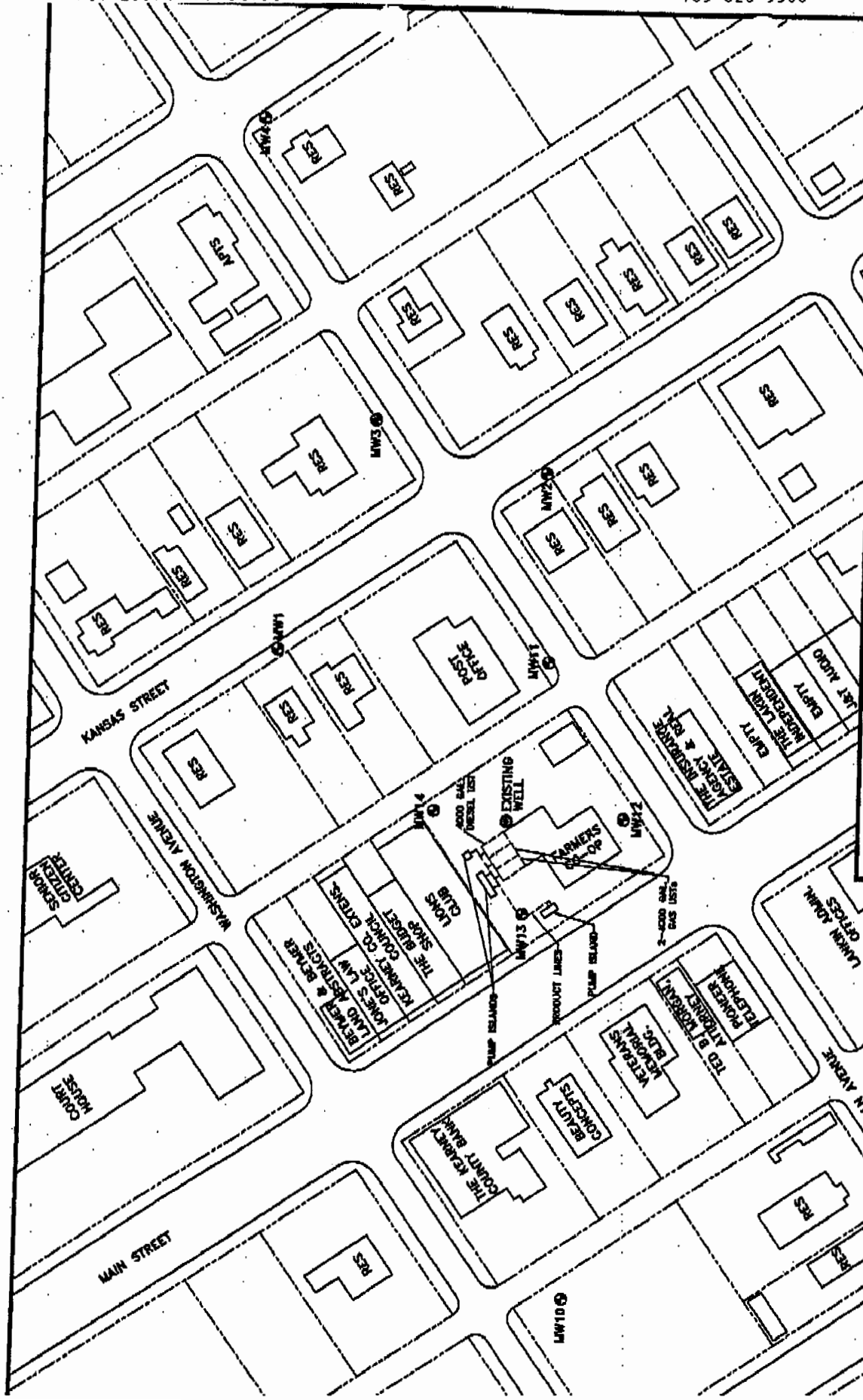

GEOCORE INC.
P.O. BOX 388 (785) 828-1816 SALINA, KANSAS

SITE AREA MAP
GEOCORE PROJECT NO. 296

DATE ORIGINATED: 04/04
SCALE: 1"=100'

SITE: FARMER'S COOP LAKIN
LOCATION: LAKIN, KANSAS
SPOT: SEC 27, T24S, R26W
NW 35, NW, NE
DRAFTER: RLR

PROJECT: 040101-000

MONITORING WELL
EXISTING WELL

SCALE: 1" = 100'



SLOAN MEIER HANCOCK
ENGINEERS SURVEYORS

July 20, 2007

Donovan Miller
GeoCore, Inc.
PO Box 386
Salina, KS 67424-0386

Dear Donovan:

The following is the information requested on a Monitoring Well Site, Farmer's Coop, Lakin, Kearny County, Kansas.

Point	North Coord	East Coord	Distance from SE Cor. Sec. 27		Elev. Top of Rim or PK Nail	Elev. Top of PVC Pipe	Latitude North	Longitude West
			North	West				
SE Cor. S27-T24S-R36W	5000	5000						
MW 12	9251.85	3205.88	4291.85	1794.12	3003.98	3003.45	37.94156	101.25525
MW 13	9334.82	3121.64	4334.82	1878.36	3004.48	3003.96	37.94175	101.25553
MW 14	9417.87	3202.35	4417.87	1797.65	3004.80	3004.31	37.94172	101.25556
Site B.M.	9302.53	3105.10	4302.53	1894.90	B.M. Elev. = 3004.04			

Description: Square "□" cut on northeast corner of light pole base at northwest corner of property.

MW12 is in the SW/4, SE/4, NW/4, SW/4 S27-T24S-R36W
MW13 and MW14 are in the NW/4, SE/4, NW/4, SW/4 S27-T24S-R36W

If you have any questions, please do not hesitate in giving us a call.

Sincerely,

Tim Sloan

 Tim Sloan,
Sloan Meier Hancock Engineers Surveyors, P.A.