

WATER WELL PLUGGING RECORD Form WWC-5P

KSA 82a-1212 ID NO.

12,508

1 LOCATION OF WATER WELL: County: KEARNY	Fraction ¼ SE ¼ NW ¼ SE ¼	Section Number 31	Township Number T 24 S	Range Number 36 <input type="checkbox"/> E <input checked="" type="checkbox"/> W
--	------------------------------	----------------------	---------------------------	---

Street/Rural Address of Well Location; if unknown, distance & direction from nearest town or intersection: If at owner's address, check here NW CORNER OF LAKIN-3 M W, 2 M S,
1 M E, 2,370 FT. N. & 1,460 FT. W.

2 WATER WELL OWNER: MEISEL, INC.
RR#, St. Address, Box #: PO BOX 283
City, State ZIP Code: LAKIN, KANSAS 67860

Global Positioning Systems (GPS) information:
Latitude: _____ (in decimal degrees)
Longitude: _____ (in decimal degrees)
Elevation: _____
Datum: WGS84, NAD83, NAD27
Collection Method: _____
 GPS unit (Make/Model): _____
 Digital Map/Photo, Topographic Map, Land Survey
Est. Accuracy: < 3 m, 3-5 m, 5-15 m, > 15 m

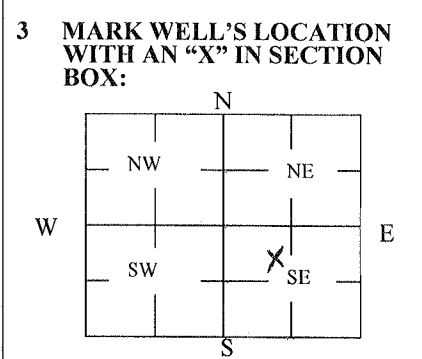

4 DEPTH OF WELL 87 ft.
WELL'S STATIC WATER LEVEL 77 ft.
WELL WAS USED AS:
 Domestic Public Water Supply Dewatering
 Irrigation Oil Field Water Supply Monitoring
 Feedlot Domestic (Lawn & Garden) Injection Well
 Industrial Air Conditioning Other _____
Was a chemical/bacteriological sample submitted to Department? Yes No

5 TYPE OF BLANK CASING USED:
 Steel RMP (SR) Wrought Fiberglass Other (Specify below)
 PVC ABS Asbestos-Cement Concrete Tile

Blank casing diameter 16 in. Was casing pulled? Yes No If yes, how much 36 INCHES
Casing height above or below land surface 36 in.

6 GROUT PLUG MATERIAL: Neat cement Cement grout Bentonite Other _____
Grout Plug Intervals: From _____ ft. to _____ ft., From _____ ft. to _____ ft., From _____ to _____ ft.

What is the nearest source of possible contamination:
 Septic tank Seepage pit Fuel Storage Other (specify below)
 Sewer lines Pit privy Fertilizer storage
 Watertight sewer lines Sewage lagoon Insecticide storage
 Lateral lines Feedyard Abandoned water well Direction from well? N/A
 Cess pool Livestock pens Oil well/Gas well How many feet? _____

FROM	TO	PLUGGING MATERIALS	FROM	TO	PLUGGING MATERIALS
0'	3'	TOP SOIL			
3'	87'	CEMENT GROUT			

7 CONTRACTOR'S OR LANDOWNER'S CERTIFICATION: This water well was plugged under my jurisdiction and was completed on (mo/day/year) 7-24-14 and this record is true to the best of my knowledge and belief. Kansas Water Well Contractor's License No. 208. This Water Well Record was completed on (mo/day/year) 7-30-14 under the business name of MINTER-WILSON DRILLING CO., INC. by (signature) Nora Keller

INSTRUCTIONS: Use typewriter or ballpoint pen. Please press firmly and print clearly. Please fill in blanks, underline or circle the correct answers. Send one copy to Kansas Department of Health and Environment, Bureau of Water, Geology Section, 1000 SW Jackson St., Ste. 420, Topeka, Kansas 66612-1367. Telephone: 785/296-5524. Send one to Water Well Owner and retain one for your records. Visit us at <http://www.kdheks.gov/waterwell/index.html>.