

**WATER WELL RECORD Form WWC-5**

Original Record  Correction  Change in Well Use

Division of Water Resources App. No.

Well ID

1 LOCATION OF WATER WELL: County: Douglas Fraction: 1/2 SE 1/4 SE 1/4 SE 1/4 Section Number: 25 Township Number: T 25 S Range Number: R 1 E W

2 WELL OWNER: Last Name: Delane First:  Street or Rural Address where well is located (if unknown, distance and direction from nearest town or intersection): If at owner's address, check here:   
 Business: 101 Red Bud  
 Address: 101 Red Bud  
 City: Vally Center State: Ks ZIP: 67147

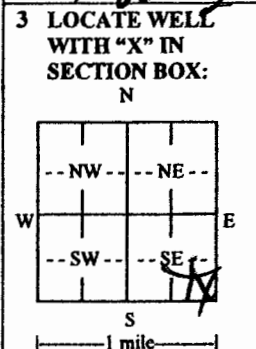

4 DEPTH OF COMPLETED WELL: 47 ft.  
 Depth(s) Groundwater Encountered: 1) 17 ft. 2) 17 ft. 3) 17 ft. or 4)  Dry Well  
 WELL'S STATIC WATER LEVEL: 17 ft.  
 below land surface, measured on (mo-day-yr) 4-26-16  
 above land surface, measured on (mo-day-yr) 4-26-16  
 Pump test data: Well water was 9 gpm after 17 hours pumping  
 Well water was 17 gpm after 17 hours pumping  
 Estimated Yield: 9 gpm  
 Bore Hole Diameter: 9 in. to 17 ft. and 17 in. to 17 ft.

5 Latitude: 37.16 (decimal degrees)  
 Longitude: 94.76 (decimal degrees)  
 Horizontal Datum:  WGS 84  NAD 83  NAD 27  
 Source for Latitude/Longitude:  GPS (unit make/model: Garmin)  
 (WAAS enabled?  Yes  No)  
 Land Survey  Topographic Map  
 Online Mapper:  
 6 Elevation: 1000 ft.  Ground Level  TOC  
 Source:  Land Survey  GPS  Topographic Map  
 Other

7 WELL WATER TO BE USED AS:

1. Domestic: <input type="checkbox"/> Household <input checked="" type="checkbox"/> Lawn & Garden <input checked="" type="checkbox"/> Livestock	2. <input type="checkbox"/> Irrigation	3. <input type="checkbox"/> Feedlot	4. <input type="checkbox"/> Industrial	5. <input type="checkbox"/> Public Water Supply: well ID <u>        </u>	6. <input type="checkbox"/> Dewatering: how many wells? <u>        </u>	7. <input type="checkbox"/> Aquifer Recharge: well ID <u>        </u>	8. <input type="checkbox"/> Monitoring: well ID <u>        </u>	9. Environmental Remediation: well ID <u>        </u> <input type="checkbox"/> Air Sparge <input type="checkbox"/> Soil Vapor Extraction <input type="checkbox"/> Recovery <input type="checkbox"/> Injection	10. <input type="checkbox"/> Oil Field Water Supply: lease <u>        </u>	11. Test Hole: well ID <u>        </u> <input type="checkbox"/> Cased <input type="checkbox"/> Uncased <input type="checkbox"/> Geotechnical	12. Geothermal: how many bores? <u>        </u> a) Closed Loop <input type="checkbox"/> Horizontal <input type="checkbox"/> Vertical b) Open Loop <input type="checkbox"/> Surface Discharge <input type="checkbox"/> Inj. of Water	13. <input type="checkbox"/> Other (specify): <u>        </u>
--	--	-------------------------------------	--	--	---	---	---	---	--	---	---	---

Was a chemical/bacteriological sample submitted to KDHE?  Yes  No If yes, date sample was submitted:           
 Water well disinfected?  Yes  No

8 TYPE OF CASING USED:  Steel  PVC  Other CASING JOINTS:  Glued  Clamped  Welded  Threaded  
 Casing diameter 5 in. to 32 ft., Diameter          in. to          ft., Diameter          in. to          ft.  
 Casing height above land surface 12 in. Weight          lbs./ft. Wall thickness or gauge No. 160  
 TYPE OF SCREEN OR PERFORATION MATERIAL:  
 Steel  Stainless Steel  Fiberglass  PVC  Other (Specify)           
 Brass  Galvanized Steel  Concrete tile  None used (open hole)  
 SCREEN OR PERFORATION OPENINGS ARE:  
 Continuous Slot  Mill Slot  Gauze Wrapped  Torch Cut  Drilled Holes  Other (Specify)           
 Louvered Shutter  Key Punched  Wire Wrapped  Saw Cut  None (Open Hole)  
 SCREEN-PERFORATED INTERVALS: From 32 ft. to 47 ft., From          ft. to          ft., From          ft. to          ft.  
 GRAVEL PACK INTERVALS: From          ft. to          ft., From          ft. to          ft., From          ft. to          ft.

9 GROUT MATERIAL:  Neat cement  Cement grout  Bentonite  Other  
 Grout Intervals: From 0 ft. to 17 ft., From          ft. to          ft., From          ft. to          ft.  
 Nearest source of possible contamination:  
 Septic Tank  Lateral Lines  Pit Privy  Livestock Pens  Insecticide Storage  
 Sewer Lines  Cess Pool  Sewage Lagoon  Fuel Storage  Abandoned Water Well  
 Watertight Sewer Lines  Seepage Pit  Feedyard  Fertilizer Storage  Oil Well/Gas Well  
 Other (Specify)           
 Direction from well? North East Distance from well? 50'

10 FROM	TO	LITHOLOGIC LOG	FROM	TO	LITHO. LOG (cont.) or PLUGGING INTERVALS
0	9	Top Soil			
9	21	Fine sand			
21	47	Coarse sand			

Notes:         

11 CONTRACTOR'S OR LANDOWNER'S CERTIFICATION: This water well was  constructed,  reconstructed, or  plugged under my jurisdiction and was completed on (mo-day-year) 4-26-16 and this record is true to the best of my knowledge and belief.  
 Kansas Water Well Contractor's License No. 4112 This Water Well Record was completed on (mo-day-year) 4-26-16  
 under the business name of Boards Pump & Well Signature David Board

Mail 1 white copy along with a fee of \$5.00 for each constructed well to: Kansas Department of Health and Environment, Bureau of Water, GWTS Section, 1000 SW Jackson St., Suite 420, Topeka, Kansas 66612-1367. Mail one to Water Well Owner and retain one for your records. Telephone 785-296-5524.  
 Visit us at <http://www.kdheks.gov/waterwell/index.html> KSA 82a-1212 Revised 7/10/2015