

1 LOCATION OF WATER WELL: County: Edwards	Fraction 1/4 NE 1/4 NE 1/4 SW 1/4	Section Number 28	Township No. T 25 S	Range Number R 17 <input type="checkbox"/> E <input checked="" type="checkbox"/> W
Street/Rural Address of Well Location; if unknown, distance & direction from nearest town or intersection: If at owner's address, check here <input type="checkbox"/> Approximately 6 miles south and 3 miles east of Lewis.		Global Positioning System (GPS) information: Latitude: 37.847072 (in decimal degrees) Longitude: -99.198747 (in decimal degrees) Elevation: Unknown Datum: <input type="checkbox"/> WGS 84, <input checked="" type="checkbox"/> NAD 83, <input type="checkbox"/> NAD 27 Collection Method: <input checked="" type="checkbox"/> GPS unit (Make/Model: WAAS) <input type="checkbox"/> Digital Map/Photo, <input type="checkbox"/> Topographic Map, <input type="checkbox"/> Land Survey Est. Accuracy: <input type="checkbox"/> <3 m, <input checked="" type="checkbox"/> 3-5 m, <input type="checkbox"/> 5-15 m, <input type="checkbox"/> >15 m		

2 WATER WELL OWNER: Higbie Farms
 RR#, Street Address, Box #: **2360 P Road**
 City, State, ZIP Code : **Lewis, KS 67552**

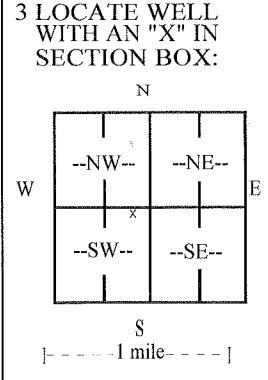

4 DEPTH OF COMPLETED WELL 79 ft.

Depth(s) Groundwater Encountered (1) _____ ft. (2) _____ ft. (3) _____ ft.
 WELL'S STATIC WATER LEVEL **32** ft. below land surface measured on mo/day/yr **11/11/15**
 Pump test data: Well water was **not checked** ft. after _____ hours pumping _____ gpm
 EST. YIELD _____ gpm. Well water was _____ ft. after _____ hours pumping _____ gpm
 Bore Hole Diameter **9** in. to **80** ft., and _____ in. to _____ ft.
 WELL WATER TO BE USED AS: Public water supply Geothermal Injection well
 Domestic Feedlot Oil field water supply Dewatering Other (Specify below) **Stock**
 Irrigation Industrial Domestic-lawn & garden Monitoring well
 Was a chemical/bacteriological sample submitted to Department? Yes No
 If yes, mo/day/yr sample was submitted _____
 Water well disinfected? Yes No

5 TYPE OF CASING USED: Steel PVC Other
 CASING JOINTS: Glued Clamped Welded Threaded Other (Specify) _____
 Casing diameter **5** in. to **57** ft., Diameter **5** in. to **77** ft., Diameter _____ in. to _____ ft.
 Casing height above land surface **24** in., Weight **2.36** lbs./ft., Wall thickness or gauge No. **.214**
 TYPE OF SCREEN OR PERFORATION MATERIAL:
 Steel Stainless Steel PVC Other (Specify) _____
 Brass Galvanized Steel None used (open hole)
 SCREEN OR PERFORATION OPENINGS ARE:
 Continuous slot Mill slot Gauze wrapped Torch cut Drilled holes None (open hole)
 Louvered shutter Key punched Wire wrapped Saw cut Other (specify) _____
 SCREEN-PERFORATED INTERVALS: From **57** ft. to **72** ft., From _____ ft. to _____ ft.
 From _____ ft. to _____ ft., From _____ ft. to _____ ft.
 GRAVEL PACK INTERVALS: From **20** ft. to **80** ft., From _____ ft. to _____ ft.
 From _____ ft. to _____ ft., From _____ ft. to _____ ft.

6 GROUT MATERIAL: Neat cement Cement grout Bentonite Other
 Grout Intervals: From **0** ft. to **20** ft., From _____ ft. to _____ ft., From _____ ft. to _____ ft.
 What is the nearest source of possible contamination:
 Septic tank Lateral lines Pit privy Livestock pens Insecticide storage Other (specify below) _____
 Sewer lines Cesspool Sewage lagoon Fuel storage Abandoned water well None Known
 Watertight sewer lines Seepage pit Feedyard Fertilizer storage Oil well/gas well
 Direction from well _____ Distance from well _____

FROM	TO	LITHOLOGIC LOG	FROM	TO	LITHO. LOG (cont.) or PLUGGING INTERVALS
0	4	Topsoil			
4	13	Clay, brown			
13	26	Sand, gravel, fine to coarse			
26	29	Clay, white, caliche			
29	46	Sand, gravel, fine to coarse			
46	47	Clay, brown			
47	63	Sand, gravel, fine to coarse			
63	75	Sand, gravel, fine to medium, sand, tan, clay streaks			
75	80	Clay, white, brown			

7 CONTRACTOR'S OR LANDOWNER'S CERTIFICATION: This water well was constructed, reconstructed, or plugged under my jurisdiction and was completed on (mo/day/year) **11/11/15** and this record is true to the best of my knowledge and belief.
 Kansas Water Well Contractor's License No. **185** This Water Well Record was completed on (mo/day/year) **11/16/15**
 under the business name of **Clarke Well & Equipment, Inc.** by (signature) _____

INSTRUCTIONS: Use typewriter or ball point pen. PLEASE PRESS FIRMLY and PRINT clearly. Please fill in blanks and check the correct answers. Send three copies (white, blue, pink) to Kansas Department of Health and Environment, Bureau of Water, Geology Section, 1000 SW Jackson St., Suite 420, Topeka, Kansas 66612-1367. Telephone 785-296-5522. Send one copy to WATER WELL OWNER and retain one for your records. Include fee of \$5.00 for each constructed well. Visit us at <http://www.kdheks.gov/waterwell/index.html>.