

Well 78

WATER WELL PLUGGING RECORD Form WWC-5P

KSA 82a-1212 ID NO.

1 LOCATION OF WATER WELL: County: Edwards Fraction SW 1/4 NE 1/4 SW 1/4 SW 1/4 Section Number 29 Township Number T 25 S Range Number 19 [ ] E [x] W

Street/Rural Address of Well Location; if unknown, distance & direction from nearest town or intersection: If at owner's address, check here [ ] 4 3/4 south & 3/4 west of Kinsley Ks.

Global Positioning Systems (GPS) information: Latitude: 37.84304 (in decimal degrees) Longitude: 99.43895 (in decimal degrees) Elevation: 2226 Datum: [ ] WGS84, [x] NAD83, [ ] NAD27 Collection Method: [x] GPS unit (Make/Model: ) [ ] Digital Map/Photo, [ ] Topographic Map, [ ] Land Survey Est. Accuracy: [ ] < 3 m, [ ] 3-5 m, [ ] 5-15 m, [ ] > 15 m

2 WATER WELL OWNER: City of Hays RR#, St. Address, Box #: P.O. Box 56 City, State ZIP Code: Hays, Ks. 67601

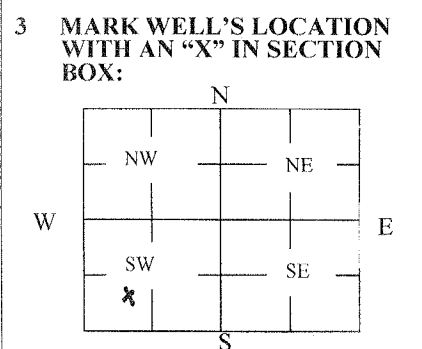

4 DEPTH OF WELL 39.84 ft. WELL'S STATIC WATER LEVEL 17.64 ft. WELL WAS USED AS: [x] Irrigation [ ] Domestic [ ] Public Water Supply [ ] Oil Field Water Supply [ ] Domestic (Lawn & Garden) [ ] Air Conditioning [ ] Dewatering [ ] Monitoring [ ] Injection Well [ ] Other Was a chemical/bacteriological sample submitted to Department? Yes [ ] No [x]

5 TYPE OF BLANK CASING USED: [x] Steel [ ] PVC [ ] RMP (SR) [ ] ABS [ ] Wrought [ ] Asbestos-Cement [ ] Fiberglass [ ] Concrete Tile [ ] Other (Specify below) Blank casing diameter 16 in. Was casing pulled? Yes [ ] No [x] If yes, how much Casing height above or below land surface 36 in.

6 GROUT PLUG MATERIAL: [ ] Neat cement [x] Cement grout [ ] Bentonite [ ] Other Grout Plug Intervals: From 18.70 ft. to 3 ft., From to to ft., From to to ft. What is the nearest source of possible contamination: [ ] Septic tank [ ] Sewer lines [ ] Watertight sewer lines [ ] Lateral lines [ ] Cess pool [ ] Seepage pit [ ] Pit privy [ ] Sewage lagoon [ ] Feedyard [ ] Livestock pens [ ] Fuel Storage [ ] Fertilizer storage [ ] Insecticide storage [ ] Abandoned water well [ ] Oil well/Gas well [x] Other (specify below) None Direction from well? How many feet?

Table with 6 columns: FROM, TO, PLUGGING MATERIALS, FROM, TO, PLUGGING MATERIALS. Rows: 39.84 to 18.70 Chlorinated gravel; 18.70 to 3 Cement grout; 3 to 0 Top soil.

7 CONTRACTOR'S OR LANDOWNER'S CERTIFICATION: This water well was plugged under my jurisdiction and was completed on (mo/day/year) 2-6-15 and this record is true to the best of my knowledge and belief. Kansas Water Well Contractor's License No. 134. This Water Well Record was completed on (mo/day/year) 2-12-15 under the business name of Rosencrantz-Bemis by (signature) Horn Aalbe

INSTRUCTIONS: Use typewriter or ballpoint pen. Please press firmly and print clearly. Please fill in blanks, underline or circle the correct answers. Send one copy to Kansas Department of Health and Environment, Bureau of Water, Geology Section, 1000 SW Jackson St., Ste. 420, Topeka, Kansas 66612-1367. Telephone: 785/296-5524. Send one to Water Well Owner and retain one for your records. Visit us at http://www.kdheks.gov/waterwell/index.html.

White copy