

WATER WELL RECORD

Form WWC-5

Division of Water Resources App. No.

[]

Well ID

MW13

[X] Original Record [] Correction [] Change in Well Ust

1 LOCATION OF WATER WELL: County Edwards Fraction NE 1/4 NW 1/4 NE 1/4 SE 1/4 Section Number 7 Township Number T 25 S Range Number R 20 E [X] W

2 WELL OWNER: Last Name: First: Street or Rural Address where well is located (if unknown, distance and direction from nearest town or intersection): If at owner's address, check here: [] Business: Offerle Cooperative Grain & Supply Co. Address: PO Box 90 City Offerle State: KS ZIP: 67563

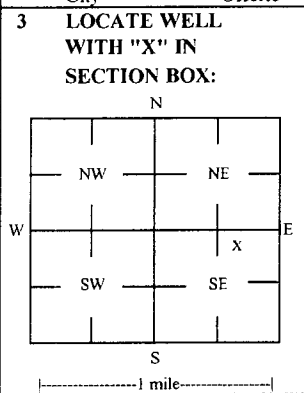

3 LOCATE WELL WITH 'X' IN SECTION BOX: 4 DEPTH OF COMPLETED WELL: 45 ft Depth(s) Groundwater Encountered: 1) _____ ft 2) _____ ft 3) _____ ft, or 4) [] Dry Well WELL'S STATIC WATER LEVEL: 32.09 ft. [X] below land surface, measured on (mo-day-yr) 8/16/17 [] above land surface, measured on (mo-day-yr) _____ Pump test data: Well water was _____ ft after _____ hours pumping _____ gpm Water well was _____ ft after _____ hours pumping _____ gpm Estimated Yield: _____ gpm Bore Hole Diameter: 7.25 in to _____ ft, and _____ in to _____ ft

5 Latitude: 37.89087 (decimal degrees) Longitude: 99.55344 (decimal degrees) Horizontal Datum: [] WGS 84 [X] NAD 83 [] NAD 27 Source for Latitude/Longitude: [] GPS (unit make/model: _____) (WAAS enabled? [] Yes [] No) [X] Land Survey [] Topographic Map [] Online Mapper

6 Elevation 2266.61 ft [] Ground Level [X] TOC Source [X] Land Survey [] GPS [] Topographic Map [] Other _____

7 WELL WATER TO BE USED AS: 1 Domestic: [] Household [] Lawn & Garden [] Livestock [] Irrigation [] Feedlot [] Industrial 2 [] Public Water Supply: well ID 3 [] Dewatering: how many wells? 4 [] Aquifer Recharge: well ID 5 [X] Monitoring: well ID MW13 6 Environmental Remediation: well ID 7 [] Air Sparge [] Soil Vapor Extractor 8 [] Recovery [] Injection 9 [] Oil Field Water Supply: lease 10 [] Test Hole: well ID [] Cased [] Uncased [] Geotechnical 11 Geothermal: How many bores? a) Closed Loop [] Horizontal [] Vertical b) Open Loop [] Surface Discharge [] Inj. of Water [] Other (specify): _____

Was a chemical/bacteriological sample submitted to KDHE? [] Yes [X] No If yes, date sample was submitted: _____ Water well disinfected? [] Yes [X] No

8 TYPE OF CASING USED: [] Steel [X] PVC [] Other _____ CASING JOINTS: [] Glued [] Clamped [] Welded [X] Threaded Casing diameter 2 in. to 30 ft, Diameter _____ in. to _____ ft, Diameter _____ in. to _____ ft, Casing height above land surface -0.37 in. Weight _____ lbs./ft. Well thickness or gauge No _____ TYPE OF SCREEN OR PERFORATION MATERIAL: [] Steel [] Stainless Steel [] Fiberglass [X] PVC [] Other (Specify) _____ [] Brass [] Galvanized Steel [] Concrete tile [] None used (open hole) SCREEN OR PERFORATION OPENINGS ARE: [] Continuous Slot [X] Mill Slot [] Gauze Wrapped [] Torch Cut [] Drilled Holes [] Other (Specify) _____ [] Louvered Shutter [] Key Punched [] Wire Wrapped [] Saw Cut [] None (Open Hole) SCREEN-PERFORATED INTERVALS: From 30 ft. to 45 ft., From _____ ft. to _____ ft., From _____ ft. to _____ ft., GRAVEL PACK INTERVALS: From 28 ft. to 45 ft., From _____ ft. to _____ ft., From _____ ft. to _____ ft.

9 GROUT MATERIAL: [] Neat cement [] Cement grout [X] Bentonite [X] Other Concrete: 0-0.5' Grout intervals: From 0.5 ft. to 28 ft., From _____ ft. to _____ ft., From _____ ft. to _____ ft.

Nearest source of possible contamination: [] Septic Tank [] Lateral Lines [] Pit Privy [] Livestock Pens [] Insecticide Storage [] Sewer Lines [] Cess Pool [] Sewage Lagoon [X] Fuel Storage [] Abandoned Water Well [] Watertight Sewer Lines [] Seepage Pit [] Feedyard [] Fertilizer Storage [] Oil Well / Gas Well [] Other (Specify) _____ Direction from well? NE Distance from well? ~15 ft

Table with 6 columns: 10 FROM, TO, LITHOLOGIC LOG, FROM, TO, LITHO. LOG (cont.) or PLUGGING INTERVALS. Rows show data for depths 0-1, 1-34, and 34-45 feet.

Notes: KDHE ID: Offerle Cooperative Grain & Supply Co.; U1-024-00048

11 CONTRACTOR'S OR LANDOWNER'S CERTIFICATION: This water well was [X] constructed, [] reconstructed, or [] plugged under my jurisdiction and was completed on (mo-day-year) 8/14&16/17 and this record is true to the best of my knowledge and belief. Kansas Water Well Contractor's License No 757 This Water Well Record was completed on (mo-day-year) 9/14/17 under the business name of Larsen & Associates, Inc. Signature [Signature]

SMH CONSULTANTS

September 12, 2016

Larsen & Associates
Jessica Chapman
1311 East 25th Street, Suite B
Lawrence, Kansas 66046
Email: Jess@LarsenEnvironmental.com

RE: Project No. 1709MN1260

Dear Jessica:

The following is the information requested on a Monitoring Well Site, Offerle Cooperative Grain and Supply Company, Elm Street, Offerle, Edwards County, Kansas.

Point	North Coord.	East Coord.	Distance SE Cor. North	From S.07 West	Elev. Top Of Rim or PK Nail	Elev. Top of PVC Pipe	Latitude North	Longitude West
SE Corner S.07-T25S-R20W	10000	10000						
MW12R	12516.03	9218.87	2516.03	781.13	2265.27	2264.88	37.89019	99.55450
MW13	12437.53	9053.52	2437.53	946.48	2266.98	2266.61	37.89087	99.55344
Site BM	12469.65	9088.52	2469.65	911.48		BM Elevation = 2266.90		

BM Description: Chiseled "X" in northeast corner concrete slab at northeast corner of property.

MW12R, MW13 are in the: NE $\frac{1}{4}$ NW $\frac{1}{4}$ NE $\frac{1}{4}$ SE $\frac{1}{4}$ S.07-T25S-R20W

If you have any questions please do not hesitate in giving us a call.

Sincerely,



Tim Sloan, L.S.
SMH CONSULTANTS

RECEIVED
SEP 28 2017
BUREAU OF WATER

NOTE: Figures exhibited within this report are only to be used within the context of this report. Placement of property lines, wells, structures, and roads is based on the available information from county appraiser maps, surveys, site visits, and/or previous vendor reports and should be considered approximate.

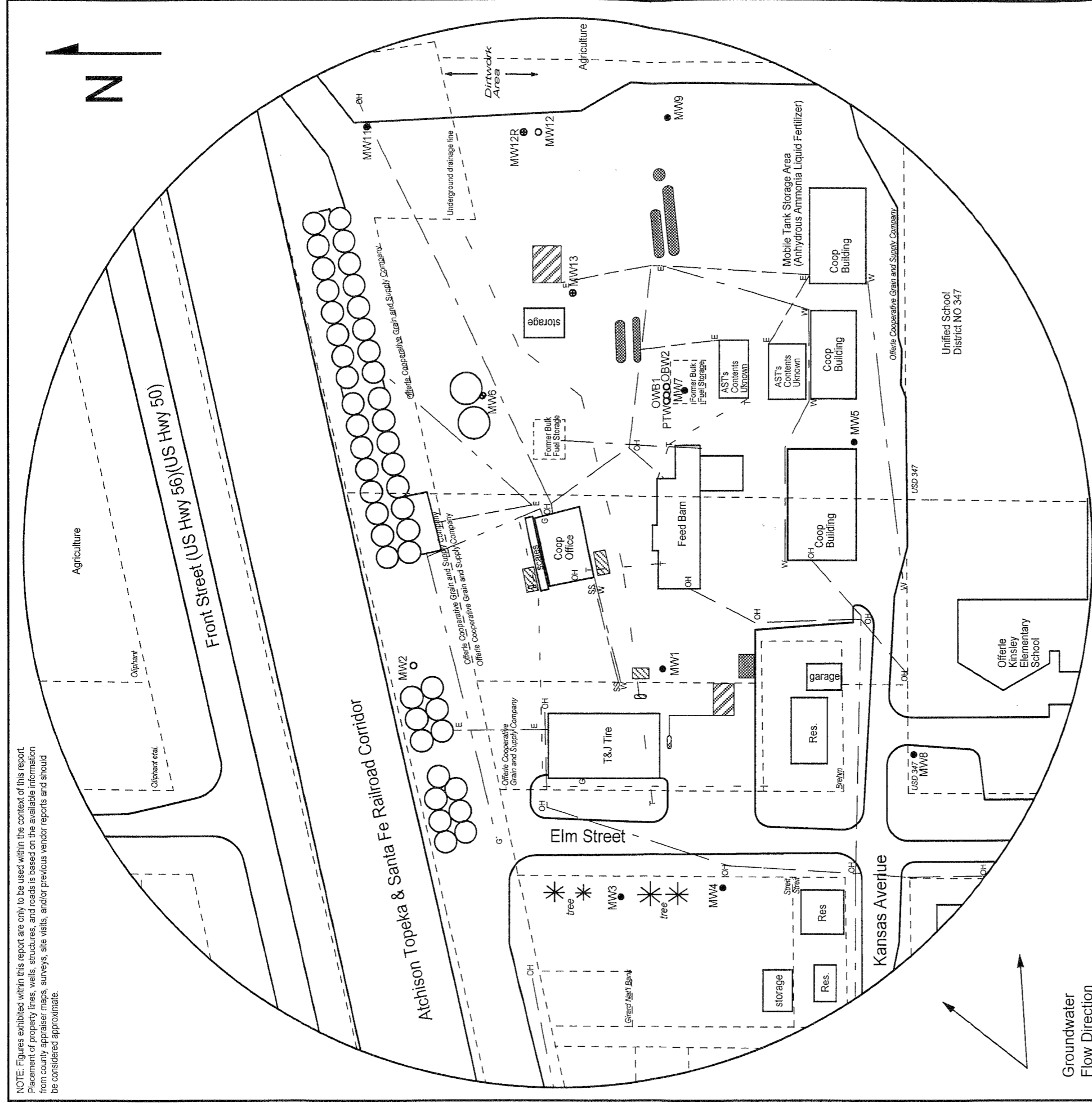

FIGURE 1 - 500 FT RADIUS AREA BASE MAP

PROJECT:

Offerle Cooperative Grain & Supply Co.
 Elm Street
 Offerle, KS
 KDHE ID: U1-024-00048
 Date: 9/7/11



1311 E 25th St., Suite B 785-841-8707 office
 Lawrence, KS 66046 785-865-4282 fax

LEGEND:

- Approximate Location of Former UST Basins & Pump Islands
- Approximate Location of Inactive UST Basins, Product Lines, & Pump Islands (Existence of Tanks Unknown)
- Propane ASTs
- Existing Monitoring Well
- Destroyed Monitoring Well
- Plugged Monitoring Well
- Monitoring Well (Installed 8/16/17)
- Approximate Location of Property Lines
 - Electric Lines (2 - 6 ft bgs)
 - Gas Lines (1.5 - 3 ft bgs)
 - Overhead Lines (25 - 40 ft high)
 - Sewer Lines (2 - 6 ft bgs)
 - Telephone Lines (2 - 6 ft bgs)
 - Water Lines (2 - 6 ft bgs)

NOTE: Utility depths, heights and locations are approximate.
 NOTE: MW10 is plugged and located approximately 670ft. W of the site.
 NOTE: Location of product lines for the former USTs and Propane ASTs is unknown.

RECEIVED

SEP 28 2017

BUREAU OF WATER