

STEARVILLE

USE TYPEWRITER OR BALL POINT PEN-PRESS FIRMLY, PRINT CLEARLY.

WATER WELL RECORD  
KSA 82a-1201-1215

Kansas Department of Health and Environment-Division of Environment (Water well Contractors) Topeka, Kansas 66620

DAD

1. Location of well:	County: <b>Ford</b>	Fraction: <b>SE 1/4 NE 1/4 SE 1/4</b>	Section number: <b>32</b>	Township number: <b>T 25 S R 22 E/W</b>	Range number:
----------------------	---------------------	---------------------------------------	---------------------------	---	---------------

2. Distance and direction from nearest town or city: <b>1 1/2 south of Spearville, Kansas</b> Street address of well location if in city:	3. Owner of well: <b>Carl Hornung</b> R.R. or street: City, state, zip code: <b>Spearville, Kansas 67876</b>
--	--

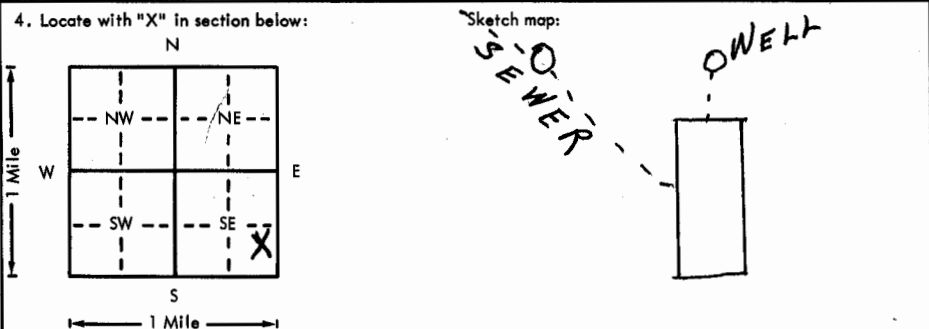

6. Bore hole dia. <b>8</b> in. Completion date <b>5-16-78</b> Well depth <b>265</b> ft.
7. Cable tool <input checked="" type="checkbox"/> Rotary <input type="checkbox"/> Driven <input type="checkbox"/> Dug <input type="checkbox"/> Hollow rod <input type="checkbox"/> Jetted <input type="checkbox"/> Bored <input type="checkbox"/> Reverse rotary
8. Use: <input checked="" type="checkbox"/> Domestic <input type="checkbox"/> Public supply <input type="checkbox"/> Industry <input type="checkbox"/> Irrigation <input type="checkbox"/> Air conditioning <input type="checkbox"/> Stock <input type="checkbox"/> Lawn <input type="checkbox"/> Oil field water <input type="checkbox"/> Other
9. Casing: Material <b>RMP</b> Height: Above or below <b>XXXXXX</b> Threaded <input type="checkbox"/> Welded <input type="checkbox"/> Surface <b>12</b> in. RMP <b>xx</b> PVC <input type="checkbox"/> Weight <input type="checkbox"/> lbs./ft. Dia. <b>5</b> in. to <b>265</b> ft. depth Wall Thickness: inches or Dia. <input type="checkbox"/> in. to <input type="checkbox"/> ft. depth gage No. <b>250</b>

5. Type and color of material	From	To
Top soil & clay	0	15
Clay	15	30
Clay, white rock (100se) & medium sand	30	45
White rock (loose) & clay	45	60
Clay & blue shale	60	75
Blue shale	75	90
Gray clay <b>chk bfg</b>	90	180
Clay <b>vd</b>	180	210
Clay & red bed <b>vd</b>	210	240
Clay (2ft.) & sand stone <b>vd</b>	240	255
Stand stone (3ft.) & clay <b>vd</b>	255	270
<b>BRICK 60'</b>		
<b>CRETACEOUS WELL</b>		

10. Screen: Manufacturer's name <b>Sunflower</b> Type <b>RMP</b> Dia. <b>5"</b> Slot/gauge <b>1/8"</b> Length <b>20 ft.</b> Set between <b>240</b> ft. and <b>260</b> ft. Gravel pack? <b>yes</b> Size range of material <b>1/4"</b>
11. Static water level: <b>175</b> ft. below land surface Date <b>5-16-78</b> mo./day/yr.
12. Pumping level below land surfaces: <b>190</b> ft. after <b>1</b> hrs. pumping <b>20</b> g.p.m. ft. after <input type="checkbox"/> hrs. pumping <input type="checkbox"/> g.p.m. Estimated maximum yield <b>35</b> g.p.m.
13. Water sample submitted: <input checked="" type="checkbox"/> Yes <input type="checkbox"/> No Date
14. Well head completion: <input checked="" type="checkbox"/> Pitless adapter <b>12</b> Inches above grade
15. Well grouted? <b>yes</b> With: <input checked="" type="checkbox"/> Neat cement <input type="checkbox"/> Bentonite <input type="checkbox"/> Concrete Depth: From <b>7</b> ft. to <b>18</b> ft.
16. Nearest source of possible contamination: ft. <b>75</b> Direction <b>West</b> Type <b>Sewer</b> Well disinfected upon completion? <input checked="" type="checkbox"/> Yes <input type="checkbox"/> No
17. Pump: <input checked="" type="checkbox"/> Not installed Manufacturer's name _____ Model number _____ HP _____ Volts _____ Length of drop pipe _____ ft. capacity _____ g.p.m. Type: <input type="checkbox"/> Submersible <input type="checkbox"/> Turbine <input type="checkbox"/> Jet <input type="checkbox"/> Reciprocating <input type="checkbox"/> Centrifugal <input type="checkbox"/> Other

18. Elevation: Topography: <input type="checkbox"/> Hill <input type="checkbox"/> Slope <input checked="" type="checkbox"/> Upland <input type="checkbox"/> Valley	19. Remarks: <b>TOPO</b>
---	-----------------------------

20. Water well contractor's certification: This well was drilled under my jurisdiction and this report is true to the best of my knowledge and belief. <b>Joe's Well Service</b> License No. <b>179</b> Business name Address <b>Box 174 Cimarron, Ks.</b> Signed <b>Larry Crick</b> Date <b>5-16-78</b> Authorized representative
--

1 25 220 32 SEWSE 1/4 1/4 1/4

2440  
60  
2380