

County: Ford Fraction: SW SW SE SW Sec. 19 T. 25 S R. 26 W

CORRECTION(S) to WATER WELL COMPLETION RECORD Form WWC-5 (to rectify lacking or incorrect information)

Owner: Drewes, Cedric

If location corrected, was listed as:

Section-Township-Range: 23 - 25 - 27W

Fraction (1/4 calls): SW SE SW

Location changed to:

19 - 25 - 26W

SW SW SE SW

Other changes: Initial statements: Initial Lat: 3751.35 N ; Initial Long; 10002.68 W

Changed to: Lat; 37.856033 Long; 100.222142

Comments: _____

Verification method: Used LEOWEB & KGS Mapper to verify & corrections made by driller

Submitted by: _____ Initials: BK Date: 03-11-2021

Submitted by: Kansas Geological Survey, Data Resources Library, 1930 Constant Ave., Lawrence, KS 66047-3724
 Kansas Dept. of Health & Environment, Bureau of Water, 1000 SW Jackson, Suite 420, Topeka, KS 66612-1367

1 LOCATION OF WATER WELL: Fraction SW 1/4 SE 1/4 S 41/4 Section Number 23 Township Number T. 25 S Range Number 29 E W
 County: Ford

Street/Rural Address of Well Location; if unknown, distance & direction from nearest town or intersection: If at owner's address, check here 102 Rd & Eagle Rd
1 3/4 m W. North side

Global Positioning Systems (GPS) information:
 Latitude: 37.5135 N (in decimal degrees)
 Longitude: 100.2265 W (in decimal degrees)
 Elevation: 2347.2687
 Horizontal Datum: WGS84, NAD83, NAD27
 Collection Method: GPS unit (Make/Model: UTM Kolar)
 Digital Map/Photo, Topographic Map, Land Survey
 Est. Accuracy: < 3 m, 3-5 m, 5-15 m, > 15 m

2 WATER WELL OWNER: Pedric Draves
 RR#, St. Address, Box #: 10597 Birtwood Dr.
 City, State ZIP Code: Dodge City, KS 67801

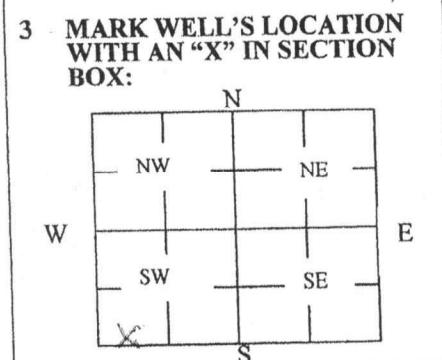

4 DEPTH OF WELL 62 ft.
 WELL'S STATIC WATER LEVEL 6 1/2 ft.
 WELL WAS USED AS:
 Domestic Public Water Supply Dewatering
 Irrigation Oil Field Water Supply Monitoring
 Feedlot Domestic (Lawn & Garden) Injection Well
 Industrial Air Conditioning Other windmill
 Was a chemical/bacteriological sample submitted to Department? Yes No

5 TYPE OF BLANK CASING USED:
 Steel RMP (SR) Wrought Fiberglass Other (Specify below)
 PVC ABS Asbestos-Cement Concrete Tile 6" tin
 Blank casing diameter 6 in. Was casing pulled? Yes No If yes, how much _____
 Casing height above or below land surface 60 in.

6 GROUT PLUG MATERIAL: Neat cement Cement grout Bentonite Other _____
 Grout Plug Intervals: From 5 ft. to 62 ft., From _____ ft. to _____ ft., From _____ ft. to _____ ft.
 What is the nearest source of possible contamination:
 Septic tank Seepage pit Fuel storage Other (specify below)
 Sewer lines Pit privy Fertilizer storage Field
 Watertight sewer lines Sewage lagoon Insecticide storage
 Lateral lines Feedyard Abandoned water well Direction from well? _____
 Cess pool Livestock pens Oil well/Gas well How many feet? _____

FROM	TO	PLUGGING MATERIALS	FROM	TO	PLUGGING MATERIALS
5	62	Bentonite			
		chlorinate			

Original Returned to Sender
 for Correction Date: 7/9/19

7 CONTRACTOR'S OR LANDOWNER'S CERTIFICATION: This water well was plugged under my jurisdiction and was completed on (mo/day/year) 2-18-17 and this record is true to the best of my knowledge and belief. Kansas Water Well Contractor's License No. 172. This Water Well Record was completed on (mo/day/year) 3-1-17 under the business name of Jonagar Water Well Services by (signature) [Signature]

Send one white copy to Kansas Department of Health & Environment, Geology Section, 1000 SW Jackson Street, Ste. 420, Topeka, KS 66612-1367. Send one copy to WATER WELL OWNER and retain one for your records.
 Visit us at <http://www.kdheks.gov/waterwell/index.html> Telephone 785-296-5524.