

WATER WELL RECORD

Form WWC-5

Division of Water Resources App. No.

1 LOCATION OF WATER WELL: County: GRAY Fraction Or LOT 8 1/4 1/4 SW 1/4 NW 1/4 Section Number 25 Township No. T 25 S Range Number R 30 [ ] E [x] W

Street/Rural Address of Well Location; if unknown, distance & direction from nearest town or intersection: If at owner's address, check here [ ]. SE CORNER OF CHARLESTON-1-1/2 MILES SOUTH, 1/2 MILE EAST, 3,180 FT. N. & 5150 FT. W. Global Positioning System (GPS) information: Latitude: (in decimal degrees) Longitude: (in decimal degrees) Elevation: Datum: [ ] WGS 84, [ ] NAD 83, [ ] NAD 27 Collection Method: [ ] GPS unit (Make/Model: ) [ ] Digital Map/Photo, [ ] Topographic Map, [ ] Land Survey Est. Accuracy: [ ] <3 m, [ ] 3-5 m, [ ] 5-15 m, [ ] >15 m

2 WATER WELL OWNER: AGRO HOLDINGS, LLC (613) RR#, Street Address, Box #: PO BOX 1014 City, State, ZIP Code : NEW YORK, NEW YORK 10021

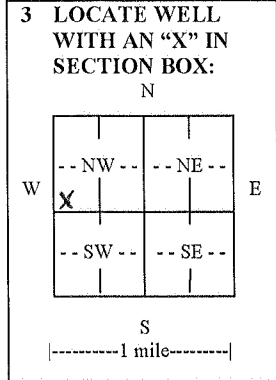

3 LOCATE WELL WITH AN "X" IN SECTION BOX: 4 DEPTH OF COMPLETED WELL 170 ft. Depth(s) Groundwater Encountered (1) ft. (2) ft. (3) ft. WELL'S STATIC WATER LEVEL 71 ft. below land surface measured on mo/day/yr. 2-1-12 Pump test data: Well water was ft. after hours pumping gpm EST. YIELD gpm. Well water was ft. after hours pumping gpm Bore Hole Diameter .30 in. to .170 ft., and in. to ft. WELL WATER TO BE USED AS: [ ] Public water supply [ ] Geothermal [ ] Injection well [ ] Domestic [ ] Feedlot [ ] Oil field water supply [ ] Dewatering [ ] Other (Specify below) [x] Irrigation [ ] Industrial [ ] Domestic-lawn & garden [ ] Monitoring well Was a chemical/bacteriological sample submitted to Department? [ ] Yes [x] No If yes, mo/day/yr sample was submitted Water well disinfected? [ ] Yes [x] No

5 TYPE OF CASING USED: [x] Steel [ ] PVC [ ] Other CASING JOINTS: [ ] Glued [ ] Clamped [x] Welded [ ] Threaded Casing diameter 16 in. to 85 ft., Diameter in. to ft., Diameter in. to ft. Casing height above land surface 12 in., Weight 42.05 lbs./ft., Wall thickness or gauge No. 250 TYPE OF SCREEN OR PERFORATION MATERIAL: [x] Steel [ ] Stainless Steel [ ] PVC [ ] Other (Specify) [ ] Brass [ ] Galvanized Steel [ ] None used (open hole) SCREEN OR PERFORATION OPENINGS ARE: [ ] Continuous slot [x] Mill slot [ ] Gauze wrapped [ ] Torch cut [ ] Drilled holes [ ] None (open hole) [ ] Louvered shutter [ ] Key punched [x] Wire wrapped [ ] Saw cut [ ] Other (specify) SCREEN-PERFORATED INTERVALS: From 85 ft. to 170 ft., From ft. to ft. GRAVEL PACK INTERVALS: From 70 ft. to 170 ft., From ft. to ft.

6 GROUT MATERIAL: [ ] Neat cement [x] Cement grout [ ] Bentonite [ ] Other Grout Intervals: From 0 ft. to 70 ft., From ft. to ft., From ft. to ft. What is the nearest source of possible contamination: [ ] Septic tank [ ] Lateral lines [ ] Pit privy [ ] Livestock pens [ ] Insecticide storage [ ] Other (specify below) [ ] Sewer lines [ ] Cesspool [ ] Sewage lagoon [ ] Fuel storage [x] Abandoned water well [ ] Watertight sewer lines [ ] Seepage pit [ ] Feedyard [ ] Fertilizer storage [ ] Oil well/gas well Direction from well NORTHWEST Distance from well 120 FT. N. & 110 FT. W.

Table with 6 columns: FROM, TO, LITHOLOGIC LOG, FROM, TO, LITHO. LOG (cont.) or PLUGGING INTERVALS. Row 1 contains 'SEE ATTACHED LOG'.

7 CONTRACTOR'S OR LANDOWNER'S CERTIFICATION: This water well was [x] constructed, [ ] reconstructed, or [ ] plugged under my jurisdiction and was completed on (mo/day/year) 2-1-12 and this record is true to the best of my knowledge and belief. Kansas Water Well Contractor's License No. 208 This Water Well Record was completed on (mo/day/year) 2-6-12 under the business name of MINTER-WILSON DRILLING CO., INC. by (signature) nara keller

INSTRUCTIONS: Use typewriter or ball point pen. PLEASE PRESS FIRMLY and PRINT clearly. Please fill in blanks and check the correct answers. Send three copies (white, blue, pink) to Kansas Department of Health and Environment, Bureau of Water, Geology Section, 1000 SW Jackson St., Suite 420, Topeka, Kansas 666 12-1367. Telephone 785-296-5524. Send one copy to WATER WELL OWNER and retain one for your records. I include fee of \$5.00 for each constructed well. Visit us at http://www.kdheks.gov/waterwell/index.html

*The*  
*Professionals*

# MINTER-WILSON DRILLING CO.

INCORPORATED

Irrigation  
and Domestic  
Water Systems  
Complete Installation  
and Repairing

Phone 620-276-8269 • P.O. Box A • GARDEN CITY, KANSAS 67846

NAME TIM DEWEY FARMS - OLD RENICK CIRCLE # 45  
COUNTY GRAY  
DATE 11-3-11

LOCATION: NE 1/4 26-25-30 - 100 FT. SOUTHEAST OF EXISTING WELL

STATIC WATER LEVEL - 70 FT.

## TEST # 2

0' TO 2' - BROWN SANDY CLAY  
2' TO 45' - FINE TO MEDIUM SAND & GRAVEL - SOME COARSE  
45' TO 60' - BROWN SANDY CLAY  
60' TO 65' - FINE TO MEDIUM SAND & GRAVEL  
65' TO 77' - BROWN CLAY  
77' TO 80' - FINE TO MEDIUM SAND  
80' TO 82' - BROWN CLAY  
82' TO 89' - FINE TO MEDIUM SAND & GRAVEL  
89' TO 98' - BROWN CLAY  
98' TO 107' - FINE TO MEDIUM SAND & GRAVEL  
WITH STRIPS OF BROWN SANDY CLAY - 20%  
107' TO 138' - BROWN SANDY CLAY  
138' TO 145' - FINE TO MEDIUM SAND & GRAVEL  
145' TO 153' - BROWN SANDY CLAY  
153' TO 164' - FINE TO MEDIUM SAND & GRAVEL  
WITH BROWN & YELLOW ROCK  
164' TO 180' - SHALE