

WATER WELL RECORD Form WWC-5

Division of Water Resources App. No.

1 LOCATION OF WATER WELL: County: KEARNY Fraction 1/4 NW 1/4 SE 1/4 SE 1/4 Section Number 1 Township No. T 25 S Range Number R 36 E W

Street/Rural Address of Well Location; if unknown, distance & direction from nearest town or intersection: SOUTH SIDE OF LAKIN-2 MILES SOUTH, 2-1/4 MILES EAST 1,315 FT. NORTH & 1,180 FT. WEST

Global Positioning System (GPS) information: Latitude: Longitude: Elevation: Datum: Collection Method: GPS unit (Make/Model): Digital Map/Photo, Topographic Map, Land Survey Est. Accuracy: <3 m, 3-5 m, 5-15 m, >15 m

2 WATER WELL OWNER: NEWPORT FARMS WELL # 3 RR#, Street Address, Box #: PO BOX 1227 City, State, ZIP Code: SYRACUSE, KANSAS 67878

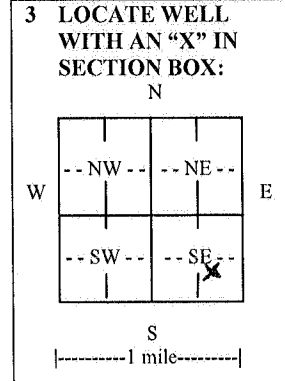

3 LOCATE WELL WITH AN 'X' IN SECTION BOX: N W E S 4 DEPTH OF COMPLETED WELL 315 ft. Depth(s) Groundwater Encountered (1) 89 ft. (2) ft. (3) ft. WELL'S STATIC WATER LEVEL 89 ft. below land surface measured on mo/day/yr. 11-7-13 Pump test data: Well water was...ft. after... hours pumping... gpm EST. YIELD... gpm. Well water was...ft. after... hours pumping... gpm Bore Hole Diameter .30 in. to .315 ft., and ...in. to ...ft. WELL WATER TO BE USED AS: [X] Irrigation [ ] Industrial [ ] Domestic-lawn & garden [ ] Monitoring well [ ] Public water supply [ ] Geothermal [ ] Injection well [ ] Domestic [ ] Feedlot [ ] Oil field water supply [ ] Dewatering [ ] Other (Specify below) Was a chemical/bacteriological sample submitted to Department? [ ] Yes [X] No If yes, mo/day/yr sample was submitted... Water well disinfected? [ ] Yes [X] No

5 TYPE OF CASING USED: [X] Steel [ ] PVC [ ] Other CASING JOINTS: [ ] Glued [ ] Clamped [X] Welded [ ] Threaded Casing diameter .16 in. to .145 ft., Diameter ... in. to ... ft., Diameter ... in. to ... ft. Casing height above land surface .12 in., Weight 42.05 lbs./ft., Wall thickness or gauge No. 250 TYPE OF SCREEN OR PERFORATION MATERIAL: [X] Steel [ ] Stainless Steel [ ] PVC [ ] Brass [ ] Galvanized Steel [ ] None used (open hole) [ ] Other (Specify) SCREEN OR PERFORATION OPENINGS ARE: [ ] Continuous slot [X] Mill slot [ ] Gauze wrapped [ ] Torch cut [ ] Drilled holes [ ] None (open hole) [ ] Louvered shutter [ ] Key punched [X] Wire wrapped [ ] Saw cut [ ] Other (specify) SCREEN-PERFORATED INTERVALS: From 245 ft. to 315 ft., From ... ft. to ... ft. GRAVEL PACK INTERVALS: From 80 ft. to 315 ft., From ... ft. to ... ft.

6 GROUT MATERIAL: [ ] Neat cement [X] Cement grout [ ] Bentonite [ ] Other Grout Intervals: From 0 ft. to 80 ft., From ... ft. to ... ft., From ... ft. to ... ft. What is the nearest source of possible contamination: [ ] Septic tank [ ] Lateral lines [ ] Pit privy [ ] Livestock pens [ ] Insecticide storage [ ] Other (specify below) [ ] Sewer lines [ ] Cesspool [ ] Sewage lagoon [ ] Fuel storage [X] Abandoned water well [ ] Watertight sewer lines [ ] Seepage pit [ ] Feedyard [ ] Fertilizer storage [ ] Oil well/gas well Direction from well NORTHWEST Distance from well 70 FT. N. & 160 FT. W.

Table with columns: FROM, TO, LITHOLOGIC LOG, FROM, TO, LITHO. LOG (cont.) or PLUGGING INTERVALS. Content: SEE ATTACHED LOG

7 CONTRACTOR'S OR LANDOWNER'S CERTIFICATION: This water well was [X] constructed, [ ] reconstructed, or [ ] plugged under my jurisdiction and was completed on (mo/day/year) 11-14-13 and this record is true to the best of my knowledge and belief. Kansas Water Well Contractor's License No. 208 This Water Well Record was completed on (mo/day/year) 11-19-13 under the business name of MINTER-WILSON DRILLING CO., INC. by (signature) Dana Keller

INSTRUCTIONS: Use typewriter or ball point pen. PLEASE PRESS FIRMLY and PRINT clearly. Please fill in blanks and check the correct answers. Send one copy to Kansas Department of Health and Environment, Bureau of Water, Geology Section, 1000 SW Jackson St., Suite 420, Topeka, Kansas 66612-1367. Telephone 785-296-5524. Send one copy to WATER WELL OWNER and retain one for your records. Include fee of \$5.00 for each constructed well. Visit us at http://www.kdheks.gov/waterwell/index.html

*The  
Professionals*

# MINTER-WILSON DRILLING CO.

INCORPORATED

Irrigation  
and Domestic  
Water Systems  
Complete Installation  
and Repairing

Phone 620-276-8269 • P.O. Box A • GARDEN CITY, KANSAS 67846

NAME HARTLAND FARMS  
COUNTY KEARNY  
DATE 8-20-13

LOCATION: SE 1/4 1-25-36 - 150 FT. EAST OF PIVOT

STATIC WATER LEVEL - 85 FT.

## TEST # 1

0' TO 2' - TOP SOIL  
2' TO 40' - FINE TO MEDIUM SAND & GRAVEL - SOME COARSE  
40' TO 50' - BROWN CLAY  
50' TO 80' - BROWN CLAY WITH GRAVEL STREAKS  
80' TO 165' - FINE TO MEDIUM SAND & GRAVEL  
165' TO 185' - BROWN CLAY  
185' TO 209' - FINE TO MEDIUM SAND & GRAVEL  
209' TO 233' - BROWN CLAY  
233' TO 254' - FINE TO MEDIUM SAND & GRAVEL  
254' TO 267' - BROWN CLAY  
267' TO 285' - FINE TO MEDIUM SAND & GRAVEL  
285' TO 292' - BROWN CLAY  
292' TO 302' - FINE TO MEDIUM SAND & FINE GRAVEL  
302' TO 315' - BROWN CLAY  
315' TO 323' - BROWN & YELLOW CLAY  
323' TO 335' - SHALE - HARD