

**WATER WELL RECORD Form WWC-5 KSA 82a-1212**

1 LOCATION OF WATER WELL: <b>Sedgwick</b>	FRACTION <b>SE 1/4 NW 1/4 NW 1/4</b>	SECTION NUMBER <b>30</b>	TOWNSHIP NUMBER <b>T 26 S</b>	RANGE NUMBER <b>R 1W E/W</b>
--	---	-----------------------------	----------------------------------	---------------------------------

Distance and direction from nearest town or city street address of well if located within city?  
**11703 W. Wilkerson Maize, Kansas**

2 WATER WELL OWNER: **KLAUSMEYER CONSTRUCTION**  
 RR#,ST. ADDRESS,BOX #: **10008 W. York**  
 CITY, STATE: **Wichita, Kansas** ZIP CODE: \_\_\_\_\_ Application Number: \_\_\_\_\_

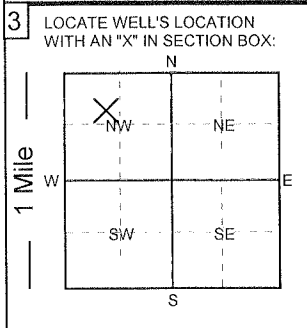

4 DEPTH OF COMPLETED WELL: **65** ft. ELEVATION: \_\_\_\_\_ ft.

Depth of groundwater Encountered: \_\_\_\_\_ ft.

WELL'S STATIC WATER LEVEL **25** FT. BELOW LAND SURFACE MEASURED ON **2/17/14** mo/day/yr:

Pump test data: Well water was \_\_\_\_\_ ft. after \_\_\_\_\_ hours of pumping @ \_\_\_\_\_ gpm

Est. Yield: \_\_\_\_\_ gpm Well water was \_\_\_\_\_ ft. after \_\_\_\_\_ hours of pumping @ \_\_\_\_\_ gpm

Bore Hole Diameter **12** in. to **65** ft. and \_\_\_\_\_ in. to \_\_\_\_\_ ft.

WELL WATER TO BE USED AS:

1. Domestic 3. Feedlot 5. Public water supply **7. Lawn and garden only** 9. Dewatering 11. Injection well  
 2. Irrigation 4. Industrial 6. Oil field water supply 8. Air conditioning 10. Monitoring well 12. Other (Specify below)

Was a chemical/bacteriological sample submitted to Department? YES **NO** ; If yes, what mo/day/yr was sample submitted \_\_\_\_\_

Was Water Well Disinfected? **YES** NO

5 TYPE OF CASING USED:

1. Steel 3. RPM (SR) 5. Wrought Iron 7. Fiberglass 9. Other (Specify below) CASING JOINTS: **Glued** Threaded  
**2. PVC** 4. ABS 6. Asbestos-Cement 8. Concrete tile SDR-26 Welded Clamped

Blank casing diameter **5** in. to **45** ft., Dia. in. to \_\_\_\_\_ ft., Dia. in. to \_\_\_\_\_ ft.

Casing height above land surface: **12** in., Weight: **2.35** lbs. / ft. Wall thickness or gauge No. **.214**

TYPE OF SCREEN OR PERFORATION MATERIAL:

1. Steel 3. Stainless Steel 5. Fiberglass **7. PVC** 9. ABS 11. Other (specify) \_\_\_\_\_  
 2. Brass 4. Galvanized 6. Concrete Tile 8. RMP (SR) 10. Asbestos-Cement 12. None used (open hole)

SCREEN OR PERFORATION OPENINGS ARE:

1. Continuous slot 3. Mill slot 5. Gauzed wrapped 7. Torch cut 9. Drilled holes 11. None (open hole)  
 2. Louvered shutter 4. Key punched 6. Wire wrapped **8. Saw cut** 10. Other (specify) \_\_\_\_\_

SCREEN - PERFORATION INTERVAL From **45** ft. to **65** ft., From \_\_\_\_\_ ft. to \_\_\_\_\_ ft.  
 From \_\_\_\_\_ ft. to \_\_\_\_\_ ft. From \_\_\_\_\_ ft. to \_\_\_\_\_ ft.

GRAVEL PACK INTERVALS: From **24** ft. to **65** ft., From \_\_\_\_\_ ft. to \_\_\_\_\_ ft.  
 From \_\_\_\_\_ ft. to \_\_\_\_\_ ft. From \_\_\_\_\_ ft. to \_\_\_\_\_ ft.

6 GROUT MATERIALS: 1. Neat cement 2. Cement Grout 3. Bentonite Other **bentonite hole plug**

Grout Intervals: From **4** ft. to **24** ft., From \_\_\_\_\_ ft. to \_\_\_\_\_ ft., From \_\_\_\_\_ ft. to \_\_\_\_\_ ft.

What is the nearest source of possible contamination:

1. Septic tank 4. Lateral lines 7. Pit privy 10. Livestock pens 13. Insecticide storage 15. Oil well/Gas well  
 2. Sewer lines 5. Cess Pool 8. Sewage lagoon 11. Fuel storage 14. Abandon water well 16. Other (specify below) \_\_\_\_\_  
**3. Watertight sewer line** 6. Seepage pit 9. Feed yard 12. Fertilizer storage

Direction from well? **South** How many feet? **10 ft. plus**

From	To	LITHOLOGIC LOG	From	To	LITHOLOGIC LOG
0	3	topsoil			
3	21	clay			
21	39	fine sand			
39	65	medium sand			

7 Contractor's or Landowner's Certification: This water well was 1. **constructed** 2. reconstructed or 3. plugged under my jurisdiction and was completed on (mo/day/year) **2/17/2014** and this record is true to the best of my knowledge and belief.

Kansas Water Well Contractor's License No. 236 This water well record was completed on (mo/day/year) **2/19/2014**  
 under the business name of **Harp Well and Pump Service** by (signature) **Todd S. Harp**