

1 LOCATION OF WATER WELL: County: <u>Sedgewick</u>	Fraction <u>1/4 E 1/4 NE 1/4 NE 1/4</u>	Section Number <u>33</u>	Township Number <u>T 26 S</u>	Range Number <u>7</u> <input type="checkbox"/> E <input checked="" type="checkbox"/> W
--	---	--------------------------	-------------------------------	--

Street/Rural Address of Well Location; if unknown, distance & direction from nearest town or intersection: If at owner's address, check here 3607N Ridge Rd
Wichita, KS 67205

Global Positioning Systems (GPS) information:
 Latitude: _____ (in decimal degrees)
 Longitude: _____ (in decimal degrees)
 Elevation: _____
 Datum: WGS84, NAD83, NAD27
 Collection Method:
 GPS unit (Make/Model: _____)
 Digital Map/Photo, Topographic Map, Land Survey
 Est. Accuracy: < 3 m, 3-5 m, 5-15 m, > 15 m

2 WATER WELL OWNER: Genevison
 RR#, St. Address, Box #: 3607N Ridge Rd
 City, State ZIP Code: Wichita, KS

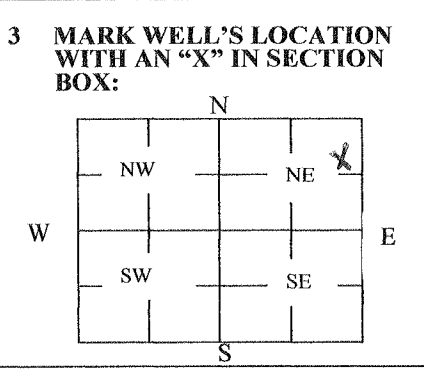

4 DEPTH OF WELL 32 ft.
 WELL'S STATIC WATER LEVEL 18 ft.
 WELL WAS USED AS:
 Domestic
 Irrigation
 Feedlot
 Industrial
 Public Water Supply
 Oil Field Water Supply
 Domestic (Lawn & Garden)
 Air Conditioning
 Dewatering
 Monitoring
 Injection Well
 Other _____
 Was a chemical/bacteriological sample submitted to Department? Yes No

5 TYPE OF BLANK CASING USED:

Steel RMP (SR) Wrought Fiberglass Other (Specify below) _____
 PVC ABS Asbestos-Cement Concrete Tile

Blank casing diameter 5 in. Was casing pulled? Yes No If yes, how much _____
 Casing height above or below land surface 36 in.

6 GROUT PLUG MATERIAL: Neat cement Cement grout Bentonite Other _____

Grout Plug Intervals: From 3 ft. to 32 ft., From _____ ft. to _____ ft., From _____ ft. to _____ ft.

What is the nearest source of possible contamination:
 Septic tank Seepage pit Fuel storage Other (specify below) _____
 Sewer lines Pit privy Fertilizer storage
 Watertight sewer lines Sewage lagoon Insecticide storage
 Lateral lines Feedyard Abandoned water well Direction from well? East
 Cess pool Livestock pens Oil well/Gas well How many feet? 52

FROM	TO	PLUGGING MATERIALS	FROM	TO	PLUGGING MATERIALS
<u>3</u>	<u>32</u>	<u>Bentonite</u>			
<u>6</u>	<u>3</u>	<u>Top Soil</u>			

7 CONTRACTOR'S OR LANDOWNER'S CERTIFICATION: This water well was plugged under my jurisdiction and was completed on (mo/day/year) 5/14/14 and this record is true to the best of my knowledge and belief. Kansas Water Well Contractor's License No. 884. This Water Well Record was completed on (mo/day/year) 5/15/14 under the business name of Wawingas Drilling LLC by (signature) [Signature]

INSTRUCTIONS: Use typewriter or ballpoint pen. Please press firmly and print clearly. Please fill in blanks, underline or circle the correct answers. Send top three copies to Kansas Department of Health and Environment, Bureau of Water, Geology Section, 1000 SW Jackson St., Ste. 420, Topeka, Kansas 66612-1367. Telephone: 785/296-5524. Send one to Water Well Owner and retain one for your records. Visit us at <http://www.kdheks.gov/waterwell/index.html>.